

Parts List				
Item	Qty.	Code	Description	Max. Torque
1	1 Set	D441060AA-0BA	Dominator D4 Dual-Step	-
	1	BRK-D44206	HARDWARE BRACKETS KIT INCLUDES:	-
2	2 Piece	D44-2060AA	Front bracket	-
3	2 Piece	D44-2240CA	Center bracket	-
4	1 Set	D44-2240DA	Rear bracket	-
5	1 Set	D44-2242AA	Front auxiliary bracket	-
6	1 Set	D44-2242BA	Center auxiliary bracket	-
7	1 Set	D44-2242CA	Rear auxiliary bracket	-
8	6 Piece	372240BA	3/8" Bolt plate	30 Lb.Ft
9	6 Piece	370200AA	3/8" T Bolt plate	30 Lb.Ft
	1	KTE-D44206	HARDWARE BOLT KIT INCLUDES:	-
10	12 Piece	-	5/16 x 1" Hex head bolt black	11 Lb.Ft
11	12 Piece	-	5/16" Lock washer black	-
12	12 Piece	-	3/8" Flat washer black	-
13	12 Piece	-	3/8 x 1" Hex head bolt	30 Lb.Ft
14	20 Piece	-	3/8" Flat washer	-
15	20 Piece	-	3/8" Lock washer	-
16	8 Piece	-	3/8" Hex nut	30 Lb.Ft
17	10 Piece	-	5/16" Vinyl Gasket	-
18	12 Piece	-	M8 x 25mm Hex head bolt	30 Lb.Ft
19	12 Piece	-	5/16" Flat washer	-
20	12 Piece	-	5/16" Lock washer	-
21	6 Piece	-	3/8 x 1" Carriage head bolt black	30 Lb.Ft
22	6 Piece	-	3/8" Lock washer black	-
23	6 Piece	-	3/8" Hex nut black	30 Lb.Ft
24	12 Piece	-	3/8" Flat washer black	-
25	2 Piece	-	1/2 x 4" Hex head bolt	75 Lb.Ft
26	2 Piece	-	1/2" Hex nut	75 Lb.Ft
27	4 Piece	-	1/2" Flat washer	-
28	2 Piece	-	1/2" Lock washer	-

Required Tools (Not included)	
Qty.	Description
1	1/2 - 9/16 - 3/4" Socket & Wrench
1	13mm Socket & Wrench
1	Ratchet
1	Ratchet extension

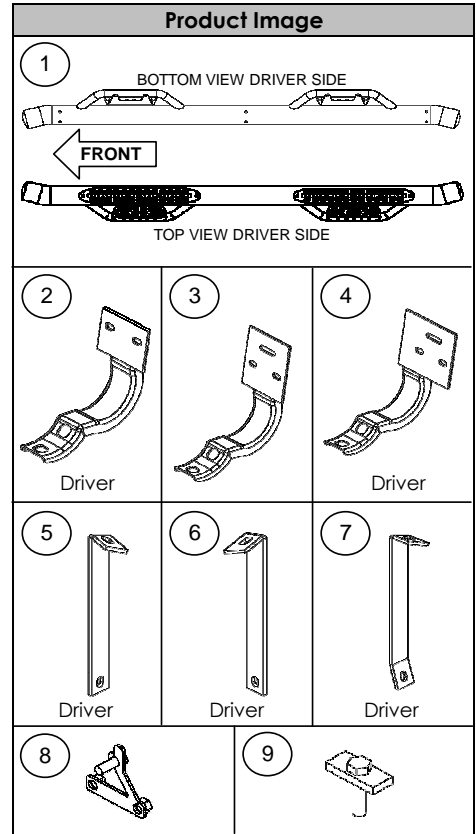

Instructions

Do not attempt to install this product on any vehicle other than the one it is designed for and listed above!

1. Before beginning the installation, please read all directions carefully and verify that all necessary hardware is accounted for. If any parts are missing, stop the installation and contact your distributor immediately.
2. To maintain and care this product, keep it clean and do not use abrasive cleaners or polish waxes. We recommend to use only automotive wax such as pure carnauba to avoid scratches and rust.
3. The approximate installation time is 60 min.
4. This installation uses 3 brackets per side, **(Photo 1)**.

PHOTO 1



Front Bracket

5. Begin the installation on the driver side of the vehicle.

6. If the vehicle has (2) hexagon shaped holes in the rocker panel at the front of the cab, remove the tape covering the obround hole in the rocker panel, and install (1) 3/8" T-Plate in the rocker panel and install (1) vinyl gasket over the threads to prevent the T-Plate from falling into the body, **(Photo 2)**. Align the nuts welded to the T-Plate with the hexagon holes in the rocker panel and attach the driver side front bracket to the rocker panel using the T-Plate, (2) 3/8" X 1" hex bolts, (2) 3/8" flat washers and (2) 3/8" lock washers, **(Photo 3)**. Leave the bolts loose for final adjustment.

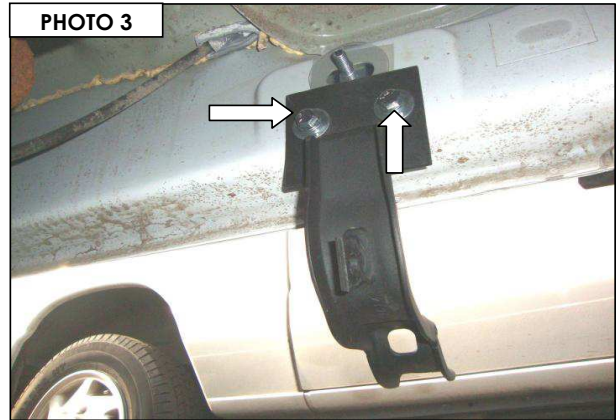
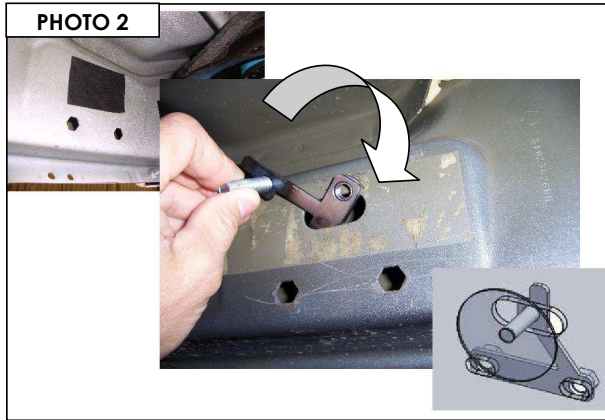

Front Bracket

7. If the vehicle has (2) M8 threaded inserts in the rocker panel at the front of the cab, **(Photo 4)**. Attach the driver side front bracket to the rocker panel using (2) M8 hex bolts, (2) 5/16" lock washers and (2) 5/16" flat washers, **(Photo 5)**. Leave the bolts loose for final adjustment.

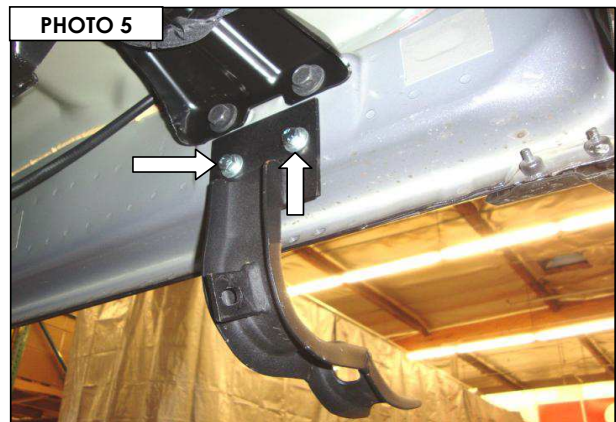
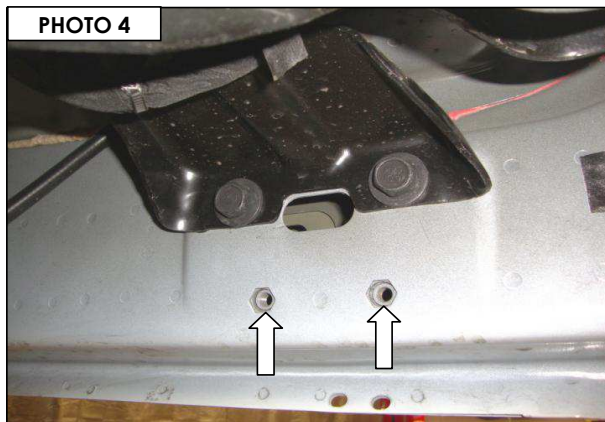

Front Auxiliary Bracket

8. Locate the round holes on each side of the frame rail near the front cab mount, **(Photo 6)**. From the back side of the frame, position (1) 1/2" x 4" hex bolt through the holes in the frame, and attach the driver side front auxiliary bracket to the side of the frame using the 1/2" x 4" hex bolt, (2) 1/2" flat washers, (1) 1/2" lock washer and (1) 1/2" hex nut, **(Photo 7)**. Attach the opposite end of the auxiliary bracket to the tab on the back of the front bracket using (1) 3/8" x 1" carriage bolt, (1) 3/8" flat washer, (1) 3/8" lock washer and (1) 3/8" hex nut, **(Photo 7)**. Leave the nuts and bolts loose for final adjustment.



Center & Rear Bracket

9. If the vehicle has hexagon holes in the rocker panel at the center and rear of the cab, remove the tape covering the obround hole in the rocker panel, and install (1) 3/8" T-Plate in the rocker panel and install (1) vinyl gasket over the threads to prevent the T-Plate from falling into the body, **(Photo 8)**. Align the nuts welded to the T-Plate with the hexagon holes in the rocker panel and attach the center and rear brackets to the rocker panel using the T-Plate, (2) 3/8" X 1" hex bolts, (3) 3/8" flat washers, (3) 3/8" lock washers and (1) 3/8" hex nut, **(Photo 9)**. Leave the nut and bolts loose for final adjustment.

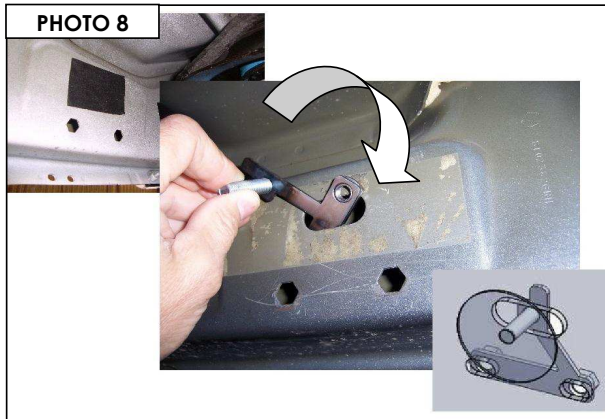

Center & Rear Bracket

10. If the vehicle has M8 threaded inserts in the rocker panel at the center and rear of the cab, remove the tape covering the obround hole in the rocker panel, and install (1) 3/8" T-Plate in the oblong hole in the rocker panel and install (1) vinyl gasket over the threads to prevent the T-Plate from falling into the body, **(Photo 10)**. Rotate the T-Plate so the nuts welded to the T-Plate clear the M8 threaded inserts in the rocker panel then attach the center and rear brackets to the rocker panel using the T-Plate (1) 3/8" flat washer, (1) 3/8" lock washer, (1) 3/8" hex nut, and (2) M8 hex bolts, (2) 5/16" lock washers and (2) 5/16" flat washers, **(Photo 11)**. Leave the nut and bolts loose for final adjustment.

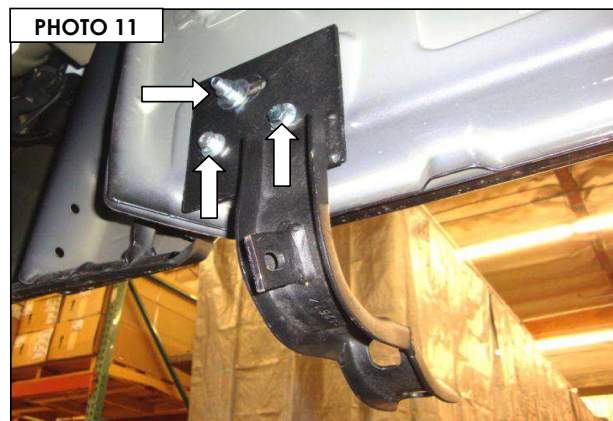
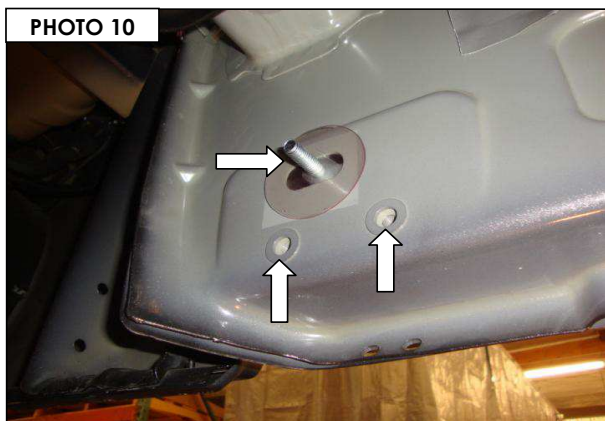

Center Auxiliary Bracket

11. Locate the obround hole in the side of the frame rail **(Photo 12)** and install (1) 3/8" T-Bolt in the hole, and install (1) vinyl gasket over the threads to prevent the T-Bolt from falling into the frame. Attach the driver side auxiliary brackets to the side of the frame using the T-Bolt, (1) 3/8" flat washer, (1) 3/8" lock washer and (1) 3/8" hex nut. Attach the opposite end of the auxiliary bracket to the tab on the center bracket using (1) 3/8" x 1" carriage bolt, (1) 3/8" flat washer, (1) 3/8" lock washer and (1) 3/8" hex nut, **(Photo 13)**. Leave the nuts and bolts loose for final adjustment.

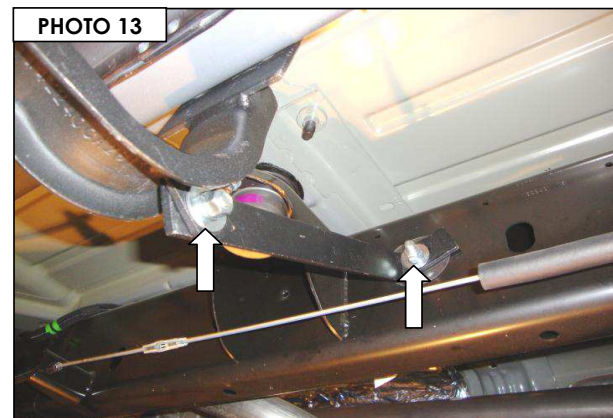
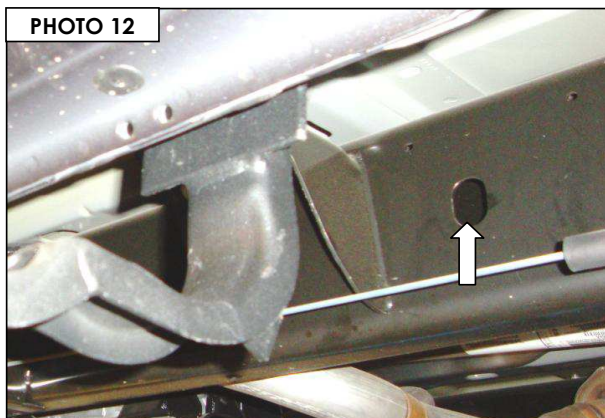

Rear Auxiliary Bracket

12. Locate the obround hole in the side of the frame rail (**Photo 14**) and install (1) 3/8" T-Bolt in the hole, and install (1) vinyl gasket over the threads to prevent the T-Bolt from falling into the frame. Attach the driver side auxiliary brackets to the side of the frame using the T-Bolt, (1) 3/8" flat washer, (1) 3/8" lock washer and (1) 3/8" hex nut. Attach the opposite end of the auxiliary bracket to the tab on the center bracket using (1) 3/8" x 1" carriage bolt, (1) 3/8" flat washer, (1) 3/8" lock washer and (1) 3/8" hex nut, (**Photo 15**). Leave the nuts and bolts loose for final adjustment.

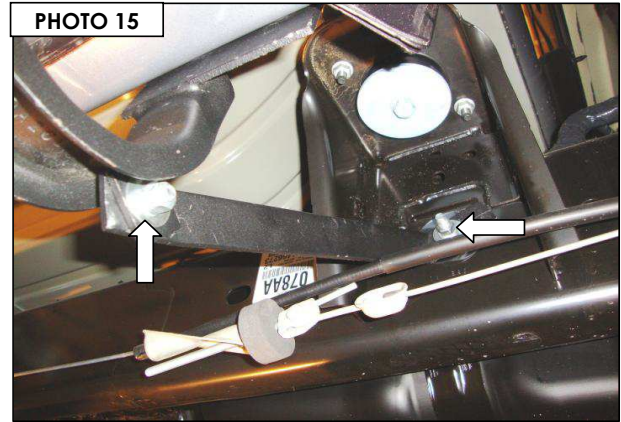
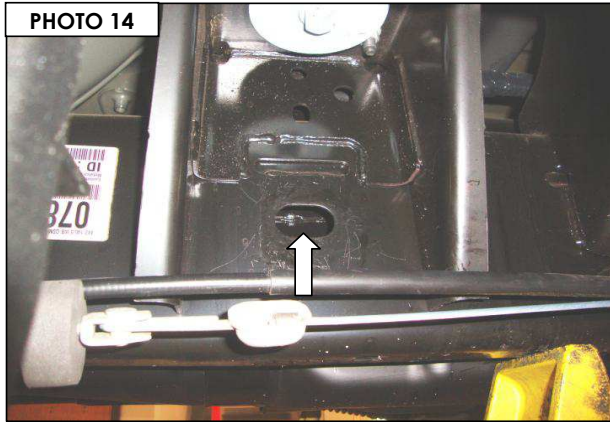

13. Place the driver side step on top of the brackets, align the threaded inserts in the bottom of the side step with the holes in the brackets and secure the side step to each of the brackets using (2) 5/16" x 1" hex bolts, (2) 5/16" lock washers and (2) 3/8" flat washers, (**Illustration 1**).

14. Align the side step with the vehicle and tighten all side step and bracket nuts and bolts, (**Photo 16**).

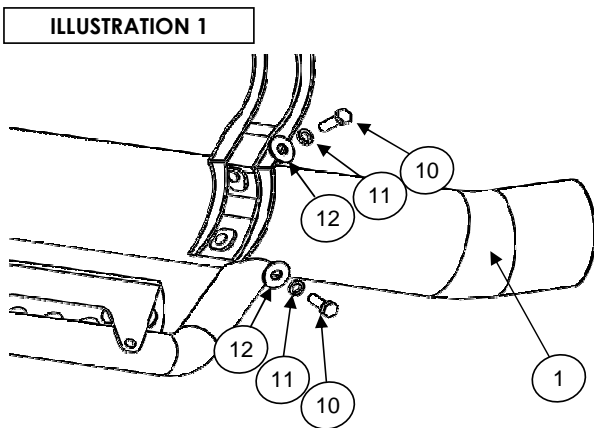

15. Repeat the above installation steps to install the brackets and side step on the passenger side of the vehicle.

16. Remember to check and repair the hardware periodically.