

INSTALLATION INSTRUCTIONS
PART#4923(B-C-PS)
08-13 JEEP LIBERTY 2&4WD (sport excluded)

Parts List:		(1) Hardware kit 37246:
QTY		(2) 1/2" Lock washer
(1) Set Side bars		(2) 1/2" Flat washer
(1) Set front brackets		(2) 1/2" Hex. Nut
(1) Set rear brackets		(8) 3/8" x 1" Hex. Head bolt black
(4) Auxiliary brackets		(12) 3/8" Flat washer black
(2) 1/2" Bolt plate		(4) 3/8" x 1 1/4" Carriage head bolt
(2) 3/8" Bolt plate		(8) 3/8" Lock washer black
(4) 3/8" Rod bolt		(4) 3/8" Hex. lock nut black
		(6) 3/8" Lock washer zinc plated
		(6) 3/8" Flat washer
		(6) 3/8" Hex. Nut
		(1) 3/8" Bolt guide

Tools required:		
9/16" Socket	3/4" Socket	Ratchet
9/16" Wrench	3/4" Wrench	

Instructions: **Aproximated installation time: 45 min.**

- Before beginning the installation, please read the instructions thoroughly and verify that the hardware kit is complete. If any of the pieces listed above are missing, call your distributor immediately to obtain the necessary items.
- Identify your product's components. Tips: The front of the side bar has the step pad farther from the edge and the front bracket is longer than the rear one. In the front bottom side of the side steps you will find a code, the one ending with 1 is for the driver side, and the one with 2 is for the passenger side.

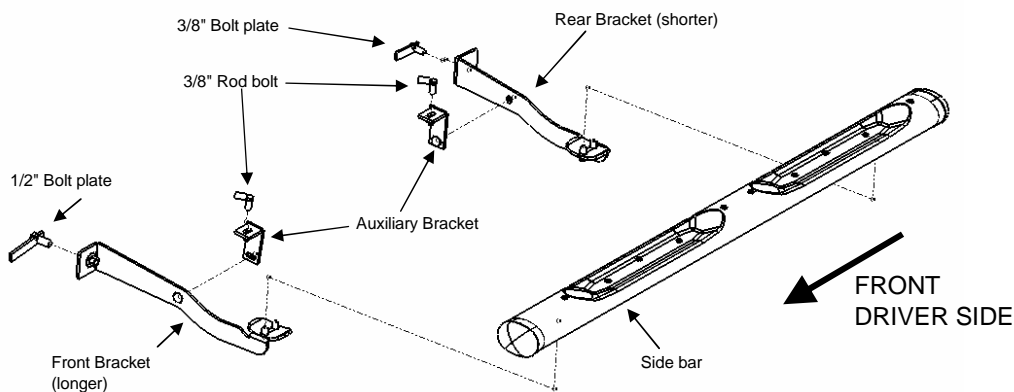

- With the help of the 3/8" bolt guide insert the rod bolt inside the chassis through the square hole and take the bolt's tip out through the circular hole. See diagram 1. Fix the auxiliary bracket to the chassis with one 3/8" flat washer, one 3/8" lock washer and one 3/8" nut. Do not tighten yet.
- Insert the 1/2" bolt plate in the hole shown in diagram 1 and fix the front bracket to the chassis with one 1/2" flat washer, one 1/2" lock washer and one 1/2" nut. Fix to the auxiliary bracket using one 3/8" carriage head bolt, one 3/8" flat washer and one 3/8" lock nut. Do not tighten yet.
- In similar way to described in step 3 fix the auxiliary bracket to the chassis in the rear of vehicle, see diagram 2. Do not tighten yet.
- Insert the 3/8" bolt plate in the oval hole shown in diagram 2 and fix the rear bracket using one 3/8" flat washer, one 3/8" lock washer and one 3/8" nut. Fix to the auxiliary bracket using one 3/8" carriage head bolt, one 3/8" flat washer and one 3/8" lock nut. Do not tighten yet.
- Fix the side bar to the brackets using (4) 3/8" bolts, (4) 3/8" flat washers and (4) 3/8" lock washers. Do not tighten yet.
- Align the side bar and tighten all hardware.
- Repeat for the other side of vehicle.
- Fill out the warranty card included and place it inside your vehicle.

Cleaning and care instructions:

Diseño:

Calidad:

Protect the finish with a non-abrasive automotive wax, (e.g. Pure Carnauba) on a regular basis. The use of any soap, polish, or wax that contains an abrasive is detrimental to the finish, as the compounds scratch the finish and cause corrosion.

Revised 20/DIC/2007

G:\Usuarios\Diseño\Instructivos PDF\37S\37246-i.Pdf

**INSTALLATION INSTRUCTIONS
PART#4923(B-C-PS)**

Assembly Diagram:

DIAGRAM 1

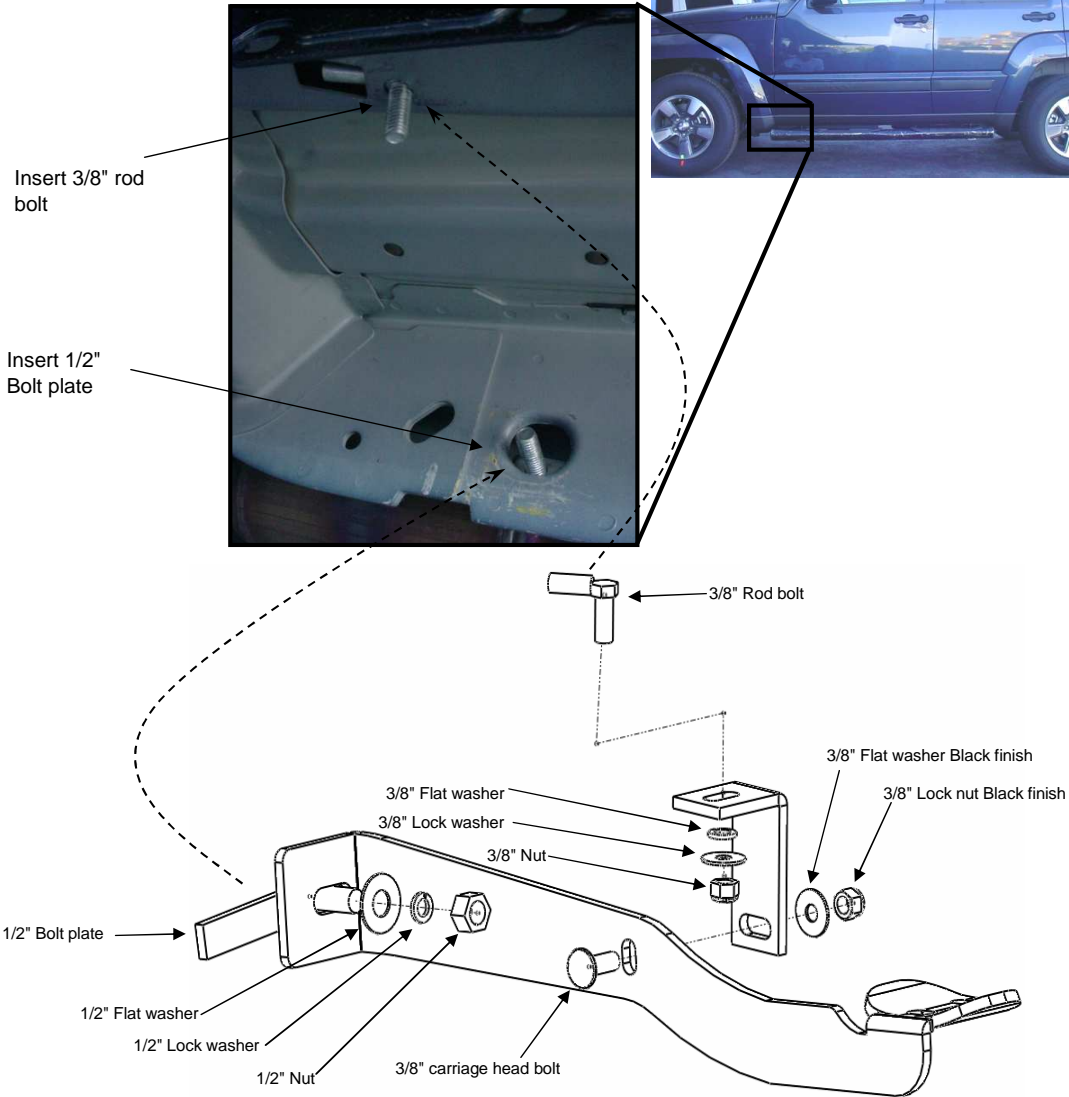

Cleaning and care instructions:

Diseño:

Calidad:

Protect the finish with a non-abrasive automotive wax, (e.g. Pure Carnauba) on a regular basis. The use of any soap, polish, or wax that contains an abrasive is detrimental to the finish, as the compounds scratch the finish and cause corrosion.

Revised 20/DIC/2007

G:\Usuarios\Diseño\Instructivos PDF\37S\37246-i.Pdf

**INSTALLATION INSTRUCTIONS
PART#4923(B-C-PS)**

DIAGRAM 2

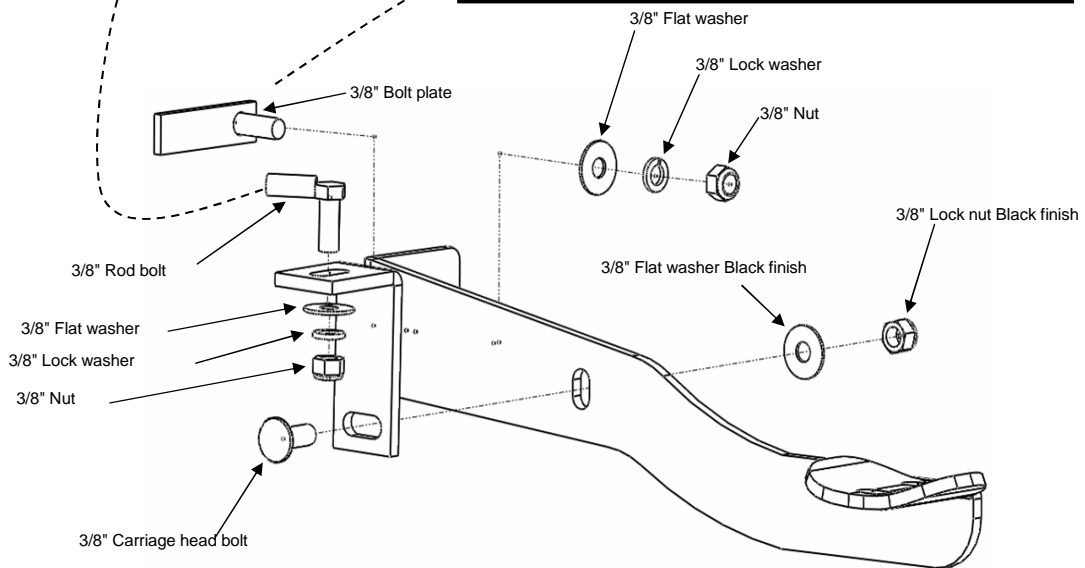
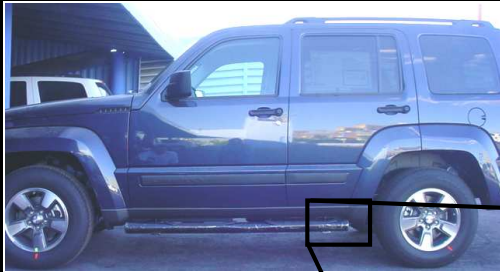

Cleaning and care instructions:

Diseño:

Calidad:

Protect the finish with a non-abrasive automotive wax, (e.g. Pure Carnauba) on a regular basis. The use of any soap, polish, or wax that contains an abrasive is detrimental to the finish, as the compounds scratch the finish and cause corrosion.

Revised 20/DIC/2007

G:\Usuarios\Diseño\Instructivos PDF\37S\37246-i.Pdf