

INSTALLATION INSTRUCTIONS

3000 SERIES STEP GUARD (CENTER GRILLE GUARD & BRUSH GUARDS)
TOYOTA TUNDRA 2/4WD
PART # 3716 (MB-MC)



PARTS LIST

<u>QTY</u>	<u>PART DESCRIPTION</u>	<u>QTY</u>	<u>PART DESCRIPTION</u>
2	1/4" X 3/4" BUTTON HEAD BOLT	2	3713 SIDE PLATE
8	5/16" X 1" BUTTON HEAD BOLT	1	3715P PASSENGER BRUSH GUARD
8	5/16" LOCK NUT	1	3715D DRIVER BRUSH GUARD
8	3/8" X 1 1/4" BUTTON HEAD BOLT	1	T12P PASSENGER HEAD LIGHT PROTECTOR
4	3/8" X 1 1/4" HEX BOLT	1	T12D DRIVER HEAD LIGHT PROTECTOR
8	3/8" LOCK WASHER	1	ST3160 3" X 35 3/4" BOTTOM STEP TUBE
4	3/8" HEX NUT	1	TT3534 2" X 35 3/4" TOP TUBE
4	3/8" FLAT WASHER	1	CP3006 35 3/4" CENTER PLATE

ASSEMBLY

READ THE ASSEMBLY AND INSTALLATION INSTRUCTIONS COMPLETELY BEFORE YOU BEGIN.

STEP-1 BEGIN THE ASSEMBLY BY LAYING THE COMPONENTS OUT ON A PROTECTIVE SURFACE.

STEP-2 POSITION THE GRILLE GUARD SIDE PLATES WITH THE FRONT EDGE DOWN AND THE TOP TUBE, CENTER PLATE AND BOTTOM STEP TUBE BETWEEN THE SIDE PLATES.

STEP-3 ATTACH THE TOP TUBE TO THE SIDE PLATES USING (2) 3/8" X 1 1/4" HEX BOLTS AND (2) 3/8" LOCK WASHERS. DO NOT TIGHTEN.

STEP-4 ATTACH THE CENTER PLATE TO THE SIDE PLATES USING (4) 3/8" X 1 1/4" BUTTON HEAD BOLTS, (4) 3/8" FLAT WASHERS, (4) 3/8" LOCK WASHERS AND (4) 3/8" HEX NUTS. DO NOT TIGHTEN.

STEP-5 ATTACH THE BOTTOM STEP TUBE TO THE SIDE PLATES USING (4) 3/8" X 1 1/4" BUTTON HEAD BOLTS.

STEP-6 ALIGN THE GRILLE GUARD ASSEMBLY, AND TIGHTEN ALL NUTS AND BOLTS.

STEP-7 POSITION THE DRIVER SIDE BRUSH GUARD UP TO THE GRILLE GUARD ASSEMBLY AND ATTACH THE BOTTOM OF THE BRUSH GUARD TO THE GRILLE GUARD SIDE PLATE USING (1) 3/8" X 1 1/4" HEX BOLT AND (1) 3/8" LOCK WASHER. ATTACH THE TOP OF THE BRUSH GUARD TO THE SIDE PLATE USING (2) 5/16" X 1" BUTTON HEAD BOLTS, (2) 5/16" FLAT WASHERS AND (2) 5/16" LOCK NUTS. DO NOT TIGHTEN.

STEP-8 ATTACH THE DRIVER SIDE HEAD LIGHT PROTECTOR TO THE BRUSH GUARD USING (2) 1/4" X 1" BUTTON HEAD BOLTS, AND TO THE SIDE PLATE USING (2) 5/16" X 1" BUTTON HEAD BOLTS, (2) 5/16" FLAT WASHERS AND (2) 5/16" LOCK NUTS. DO NOT TIGHTEN. REPEAT THE STEPS TO INSTALL THE PASSENGER SIDE BRUSH GUARD AND HEAD LIGHT PROTECTOR.

STEP-9 ALIGN THE GRILLE AND BRUSH GUARD ASSEMBLY, AND TIGHTEN ALL NUTS AND BOLTS.

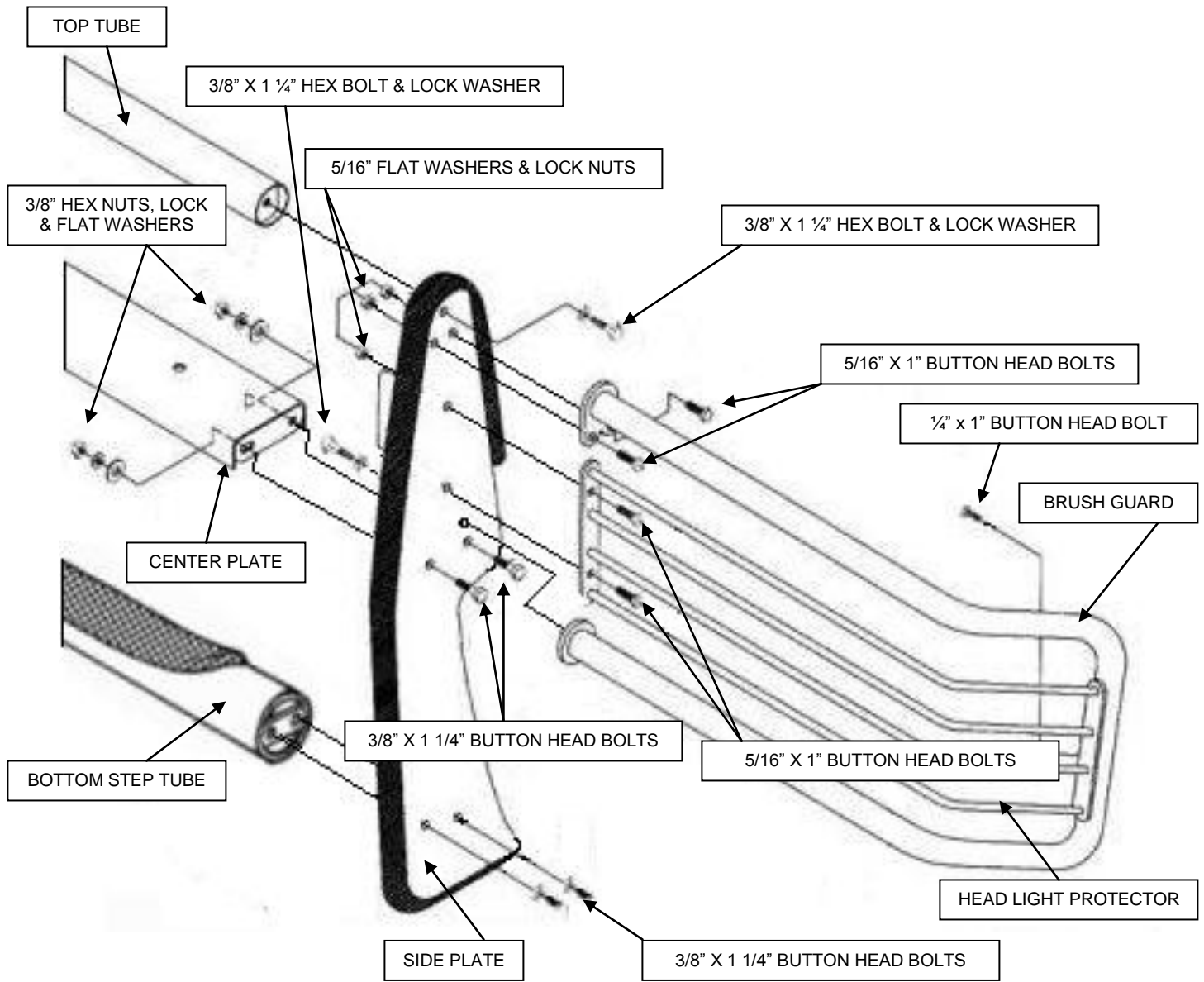

INSTALLATION INSTRUCTIONS

3000 SERIES STEP GUARD (CENTER GRILLE GUARD & BRUSH GUARDS)
TOYOTA TUNDRA 2/4WD
PART # 3716 (MB-MC)



PARTS LIST

<u>QTY</u>	<u>PART DESCRIPTION</u>	<u>QTY</u>	<u>PART DESCRIPTION</u>
2	6M X 20M HEX BOLT	4	1/2" X 1 1/2" HEX BOLT
2	6M FLAT WASHER	4	1/2" HEX NUT
2	6M LOCK WASHER	4	1/2" FLAT WASHER
2	5/16" X 1" BOLT	1	71321) DRIVER LOWER BRACKET
2	5/16" FLAT WASHER	1	71322) PASSENGER LOWER BRACKET
2	5/16" LOCK WASHER	1	71311) DRIVER UPPER BRACKET
2	5/16" HEX NUT	1	71312) PASSENGER UPPER BRACKET
4	1/2" LOCK WASHER	6"	ADHESIVE BACKED FOAM TAPE

INSTALLATION

READ THE ASSEMBLY AND INSTALLATION INSTRUCTIONS COMPLETELY BEFORE YOU BEGIN.

STEP-1 REMOVE THE LICENSE PLATE AND BRACKET FROM THE FRONT BUMPER.

STEP-2 REMOVE THE (2) BOLTS AND TOW HOOK FROM THE BOTTOM OF THE DRIVER SIDE FRAME RAIL. ATTACH THE DRIVER SIDE LOWER BRACKET AND TOW HOOK TO THE FRAME, USING THE FACTORY TOW HOOK BOLTS. LEAVE THE BOLTS LOOSE FOR FINAL ADJUSTMENT. **PHOTO #1**

STEP-3 OPEN THE HOOD AND REMOVE FROM THE TOP OF THE BUMPER, THE 6M BOLT TO THE LEFT OF THE GRILLE BUMP STOP. **PHOTO #2**

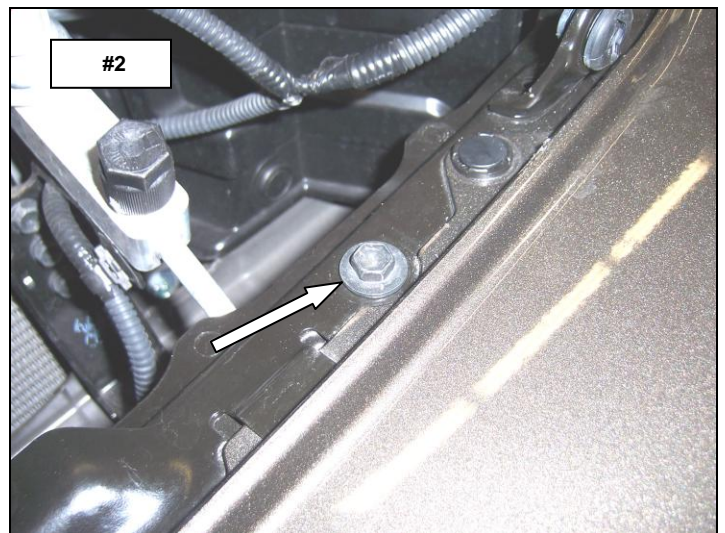
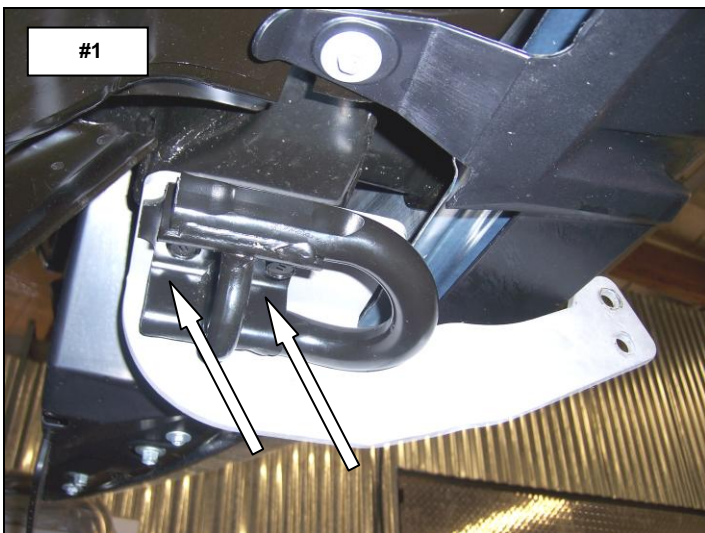

STEP-4 ATTACH THE DRIVER SIDE UPPER BRACKET TO THE BUMPER USING (1) 6M X 20M HEX BOLT, (1) 6M LOCK WASHER AND (1) 6M FLAT WASHER. LEAVE THE BOLT LOOSE FOR FINAL ADJUSTMENT. **PHOTO #3**

Rev: Date: 3/17/2017

Page 3 of 4

NOTE: TO PREVENT THE UPPER BRACKET FROM SCUFFING THE TOP OF THE BUMPER, APPLY FOAM TAPE TO THE BUMPER AREA BEFORE INSTALLING THE UPPER BRACKET.

REPEAT THE ABOVE STEPS TO INSTALL THE PASSENGER SIDE LOWER AND UPPER BRACKETS.

STEP-5 ATTACH THE GRILLE GUARD ASSEMBLY TO THE OUTSIDE OF THE LOWER BRACKETS USING (2) 1/2" X 1 1/2" HEX BOLTS, (2) 1/2" FLAT WASHERS, (2) 1/2" LOCK WASHERS (2) 1/2" HEX NUTS AND TO THE UPPER BRACKETS USING (1) 5/16" X 1" HEX BOLT, (1) 5/16" FLAT WASHER, (1) 5/16" LOCK WASHER AND (1) 5/16" HEX NUT FOR EACH SIDE. **PHOTO #4 & #5**

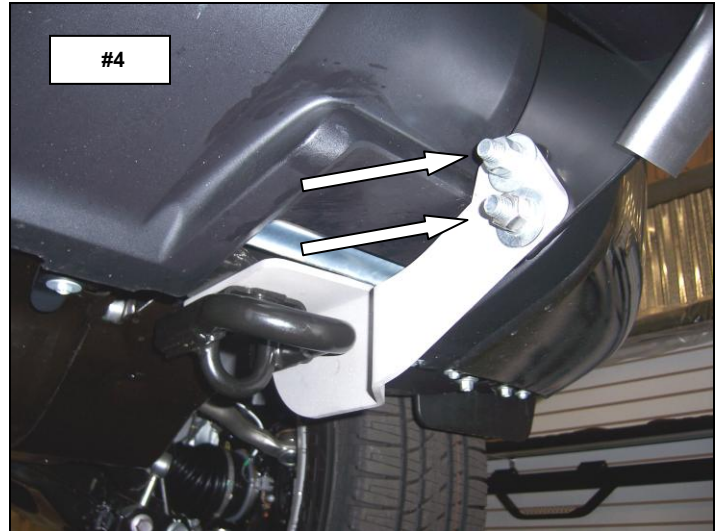
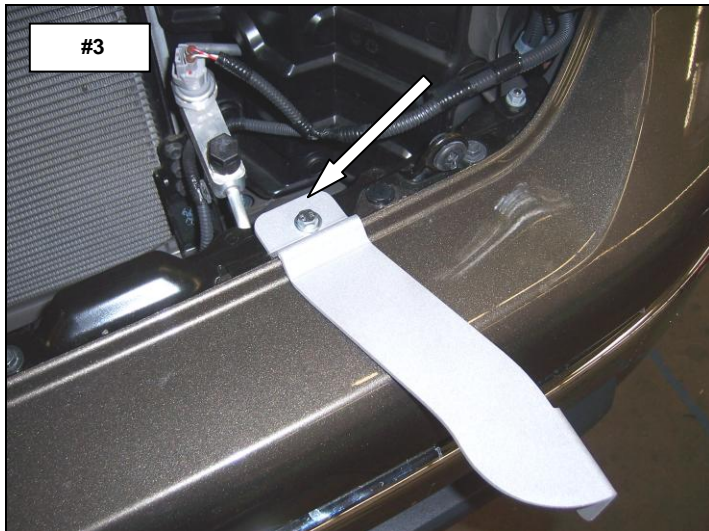

STEP-6 ALIGN THE GRILLE GUARD ASSEMBLY WITH THE FRONT OF THE VEHICLE AND TIGHTEN ALL NUTS AND BOLTS.

IMPORTANT: CAREFULLY CLOSE THE HOOD AND CHECK FOR CLEARANCE BETWEEN THE VEHICLE GRILLE AND THE GRILLE GUARD ASSEMBLY. IF NECESSARY, LOOSEN THE MOUNTING BRACKETS AND ADJUST.

STEP-7 IF YOUR STATE LAW REQUIRES A FRONT LICENSE PLATE, ATTACH THE LICENSE PLATE DIRECTLY TO THE BUMPER USING THE LOWER HOLES IN THE LICENSE PLATE, AND THE FACTORY SCREWS. **PHOTO #8**

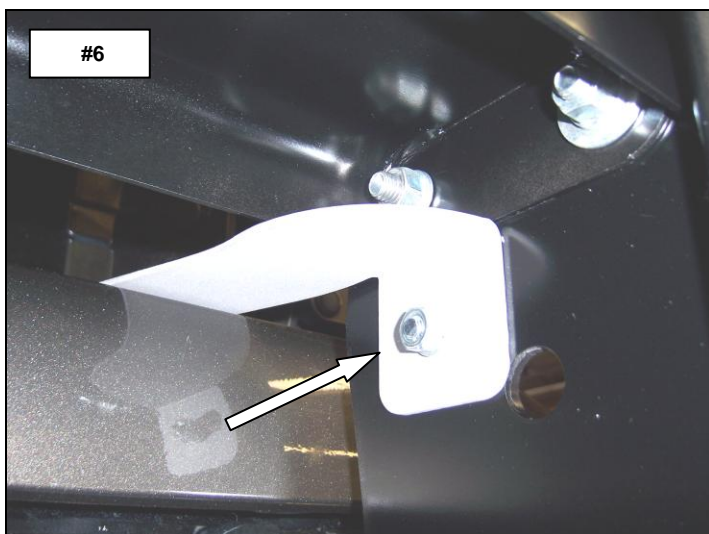

Review the product package and contents prior to beginning the installation. If you need to place a warranty claim or need assistance, Please contact the Go Rhino customer service team at 1-888-427-4466 during normal business hours Monday thru Friday 7 am to 5 pm PST. You may also email warranty@gorhino.com.