



## 3000 SERIES STEPGUARD

### COMPLETE GRILLE & BRUSH GUARD ASSEMBLY INSTRUCTIONS

PART NO. 3291M & 3291MC 07-12 FORD EXPEDITION 2/4WD

(Excludes Limited and King Ranch models equipped with Front Park Assist)

**Do not attempt to install this product on any vehicle other than the one it is designed for and listed above!**

#### PACKING LIST

| <u>QTY</u> | <u>PARTS DESCRIPTION</u>       | <u>QTY</u> | <u>PARTS DESCRIPTION</u>             |
|------------|--------------------------------|------------|--------------------------------------|
| 2          | 1/4" X 3/4" BUTTON HEAD BOLTS  | 2          | 3291 SIDE PLATES                     |
| 8          | 5/16" X 3/4" BUTTON HEAD BOLTS | 1          | 3292P PASSENGER BRUSH GUARD          |
| 8          | 5/16" LOCK NUTS                | 1          | 3292D DRIVER BRUSH GUARD             |
| 8          | 3/8" X 1" BUTTON HEAD BOLTS    | 1          | F12P PASSENGER HEAD LIGHT PROTECTOR  |
| 4          | 3/8" X 1 1/4" HEX BOLTS        | 1          | F12D DRIVER HEAD LIGHT PROTECTOR     |
| 8          | 3/8" LOCK WASHERS              | 1          | ST3003 3" X 28 5/8" BOTTOM STEP TUBE |
| 4          | 3/8" HEX NUTS                  | 1          | TT2858 2" X 28 5/8" TOP TUBE         |
| 4          | 3/8" FLAT WASHERS              | 1          | CP3003 28 5/8" CENTER PLATE          |

#### ASSEMBLY

**STEP-1** BEGIN THE ASSEMBLY BY LAYING THE COMPONENTS OUT ON A PROTECTIVE SURFACE.

**STEP-2** POSITION THE GRILLE GUARD SIDE PLATES WITH THE FRONT EDGE DOWN AND THE 2" TOP AND BOTTOM STEP TUBE BETWEEN THE SIDE PLATES.

**STEP-3** ATTACH THE TOP TUBE TO THE SIDE PLATES USING (2) 3/8" X 1 1/4" HEX BOLTS AND LOCK WASHERS. DO NOT TIGHTEN.

**STEP-4** ATTACH THE STEP TUBE TO THE SIDE PLATES USING (4) 3/8" X 1" BUTTON HEAD BOLTS. DO NOT TIGHTEN.

**STEP-5** POSITION THE CENTER PLATE BETWEEN THE GRILLE GUARD SIDE PLATES, WITH THE **SLOTTED MOUNTING HOLES** IN THE CENTER PLATE DOWN. ATTACH THE CENTER PLATE TO THE SIDE PLATES USING (4) 3/8" X 1" BUTTON HEAD BOLTS, FLAT WASHERS, LOCK WASHERS AND HEX NUTS. DO NOT TIGHTEN.

**STEP-6** TIGHTEN THE 2" TOP TUBE.

**STEP-7** POSITION THE DRIVER SIDE BRUSH GUARD UP TO THE GRILLE GUARD ASSEMBLY. LOOSELY ATTACH THE BOTTOM OF THE BRUSH GUARD TO THE GRILLE GUARD SIDE PLATE USING (1) 3/8" X 1 1/4" HEX BOLT AND LOCK WASHER. ATTACH THE TOP OF THE BRUSH GUARD TO THE SIDE PLATE USING (2) 5/16" X 3/4" BUTTON HEAD BOLTS, AND LOCK NUTS.

REPEAT THE ABOVE STEP TO INSTALL THE PASSENGERS SIDE BRUSH GUARD.

**STEP-8** LOOSELY ATTACH THE DRIVER SIDE HEAD LIGHT PROTECTOR TO THE BRUSH GUARD USING (1) 1/4" X 3/4" BUTTON HEAD BOLT, AND TO THE SIDE PLATE USING (2) 5/16" X 3/4" BUTTON HEAD BOLTS AND LOCK NUTS. REPEAT THIS STEP TO INSTALL THE PASSENGER SIDE HEAD LIGHT PROTECTOR.

**STEP-9** ALIGN THE GRILLE AND BRUSH GUARD ASSEMBLY, AND TIGHTEN ALL NUTS AND BOLTS.

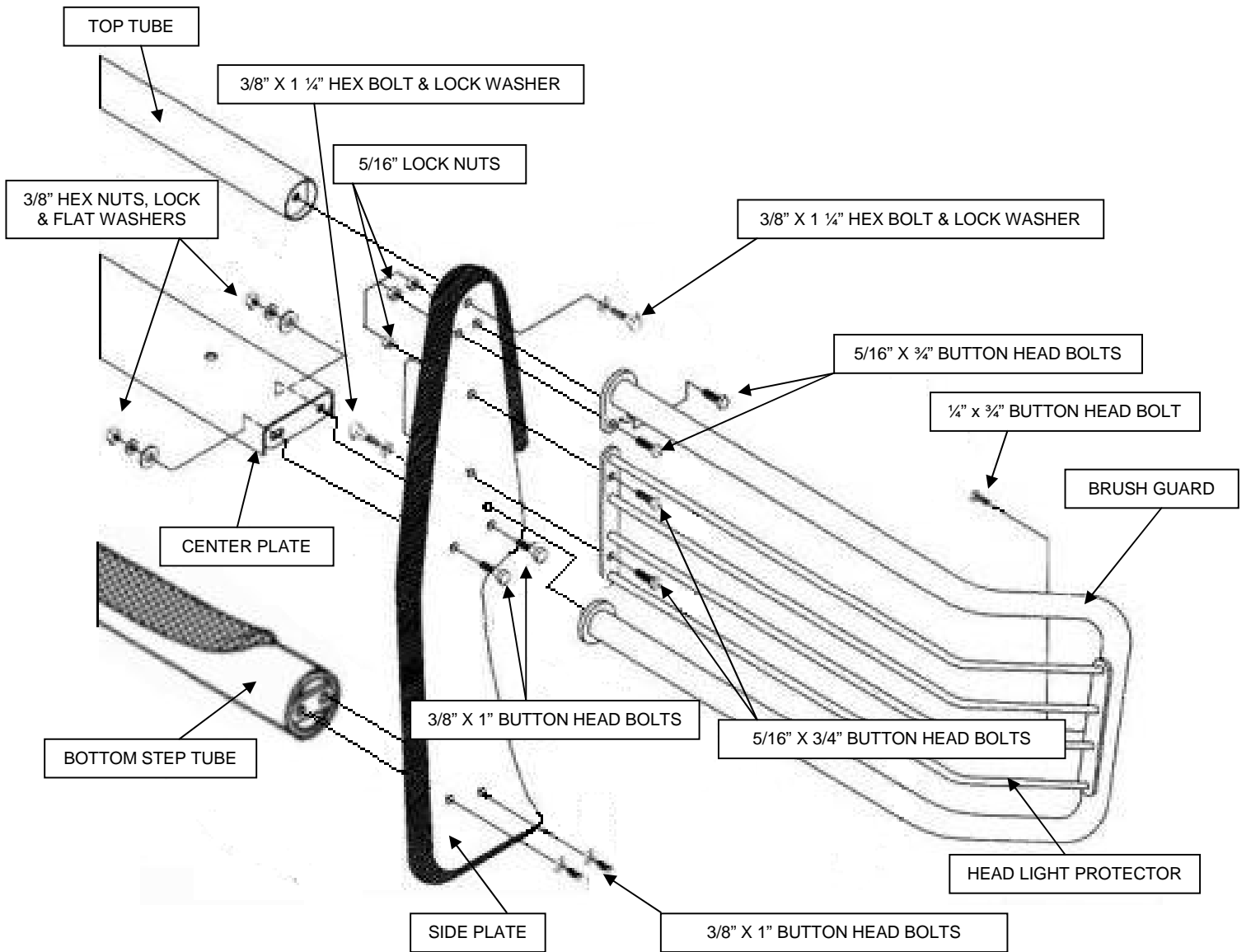

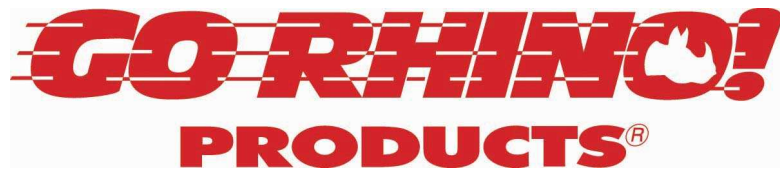

## 3000 SERIES STEPGUARD

### COMPLETE GRILLE & BRUSH GUARD INSTALLATION INSTRUCTIONS

PART NO. 3291MB & 3291MC 07-12 FORD EXPEDITION 2/4WD

(Excludes Limited and King Ranch models equipped with Front Park Assist)

**Do not attempt to install this product on any vehicle other than the one it is designed for and listed above!**

#### PACKING LIST

| <u>QTY</u> | <u>PARTS DESCRIPTION</u>    | <u>QTY</u> | <u>PARTS DESCRIPTION</u>       |
|------------|-----------------------------|------------|--------------------------------|
| 4          | 3/8" X 1 1/4" HEX BOLTS     | 1          | 2914P PASSENGER LOWER BRACKET  |
| 2          | 3/8" X 1" BUTTON HEAD BOLTS | 1          | 2914D DRIVER LOWER BRACKET     |
| 6          | 3/8" FLAT WASHERS           | 1          | 2913P PASSENGER CENTER BRACKET |
| 6          | 3/8" LOCK WASHERS           | 1          | 2913D DRIVER CENTER BRACKET    |
| 6          | 3/8" HEX NUTS               | 1          | 2912P PASSENGER UPPER BRACKET  |
| 8          | 1/2" HEX NUTS               | 1          | 2912D DRIVER UPPER BRACKET     |
| 8          | 1/2" FLAT WASHERS           | 3          | PLASTIC TREE CLIPS             |
| 8          | 1/2" LOCK WASHERS           | 2          | 2910S 1/2" BOLT PLATE (SHORT)  |
| 4          | 1/2" X 1 1/2" HEX BOLTS     | 2          | 2910L 1/2" BOLT PLATE (LONG)   |

#### INSTALLATION

**NOTE: THIS INSTALLATION REQUIRES PERMANENT REMOVAL OF THE FACTORY TOW HOOKS AND FASTENERS.**

**STEP-1** READ THE INSTRUCTIONS COMPLETELY. BEGIN THE INSTALLATION BY REMOVING THE (3) PLASTIC TREE CLIPS SECURING THE RUBBER SPLASH GUARD. PUSH THE SPLASH GUARD UP OUT OF THE WAY TO EXPOSE THE CENTER BRACKET MOUNTING POINTS. **FIG. #1**

**STEP-2** BEGINNING WITH THE DRIVER SIDE, POSITION (1) 2910L BOLT PLATE THROUGH THE OPENING IN THE END OF THE FRAME AND INSERT THE BOLT THROUGH THE REAR TOW HOOK MOUNTING HOLE. REPEAT THE PROCEDURE AND INSTALL (1) 2910S BOLT PLATE IN THE FRONT TOW HOOK MOUNTING HOLE. **FIG. #2 & FIG. #3**

**STEP-3** POSITION 2914D LOWER BRACKET OVER THE BOLTS. SECURE THE BRACKET USING (2) 1/2" FLAT WASHERS, LOCK WASHERS AND HEX NUTS. DO NOT TIGHTEN. **FIG. #4**

**STEP-4** LOCATE THE (2) NUTS AND STUDS THAT SECURE THE BUMPER BRACKET TO THE FRAME RAIL REMOVE THE (2) NUTS AND POSITION 2913D CENTER BRACKET OVER THE STUDS. SECURE THE CENTER BRACKET USING THE FACTORY NUTS. DO NOT TIGHTEN. **FIG. #5**

**STEP-5** FROM BEHIND THE GRILLE, INSERT 2912D UPPER BRACKET THROUGH THE OPENING IN THE GRILLE. LOOSELY ATTACH THE UPPER BRACKET TO THE CENTER BRACKET USING (2) 3/8" X 1 1/4" HEX BOLTS, FLAT WASHERS, LOCK WASHERS AND HEX NUTS. **FIG. #6**

REPEAT THE ABOVE STEPS TO INSTALL THE PASSENGER SIDE BRACKETS.

**STEP-6** ATTACH THE GRILLE GUARD ASSEMBLY TO THE OUTSIDE OF THE LOWER MOUNTING BRACKETS USING (4) 1/2" X 1 1/2" HEX BOLTS, FLAT WASHERS, LOCK WASHERS AND HEX NUTS. DO NOT TIGHTEN. **FIG. #7**

**STEP-7** ATTACH THE GRILLE GUARD ASSEMBLY TO THE OUTSIDE OF THE UPPER MOUNTING BRACKETS USING (2) 3/8" X 1 1/4" HEX BOLTS, FLAT WASHERS, LOCK WASHERS AND HEX NUTS. DO NOT TIGHTEN. **FIG. #8**

**STEP-8** ALIGN THE GRILLE GUARD ASSEMBLY WITH THE FRONT OF THE VEHICLE AND TIGHTEN ALL NUTS AND BOLTS.

**STEP-9** TRIM THE RUBBER SPLASH GUARD TO CLEAR THE BRACKETS AND SECURE USING THE (3) PLASTIC TREE CLIPS SUPPLIED.

