



Innovative Truck Racks!

Two Companies! One Vision!



Built to demand respect!

3000 SERIES STEPGUARD

GRILLE GUARD

ASSEMBLY INSTRUCTIONS

PART NO. 3289B & 3289C 06-08 FORD F-150 2/4WD

NOTE: READ THE ASSEMBLY AND INSTALLATION INSTRUCTION COMPLETELY BEFORE BEGINNING. 2 WHEEL DRIVE MODELS REQUIRE NOTCHING THE LOWER BUMPER FASCIA.

PACKING LIST

<u>QTY</u>	<u>PARTS DESCRIPTION</u>
10	3/8" X 1 1/4" HEX BOLTS
10	3/8" LOCK WASHERS
4	3/8" HEX NUTS
4	3/8" FLAT WASHERS

<u>QTY</u>	<u>PARTS DESCRIPTION</u>
1	3287D DRIVER SIDE PLATE
1	3287P PASSENGER SIDE PLATE
1	ST3003 BOTTOM STEP TUBE
1	TT3287 TOP TUBE
1	CP3024 CENTER PLATE

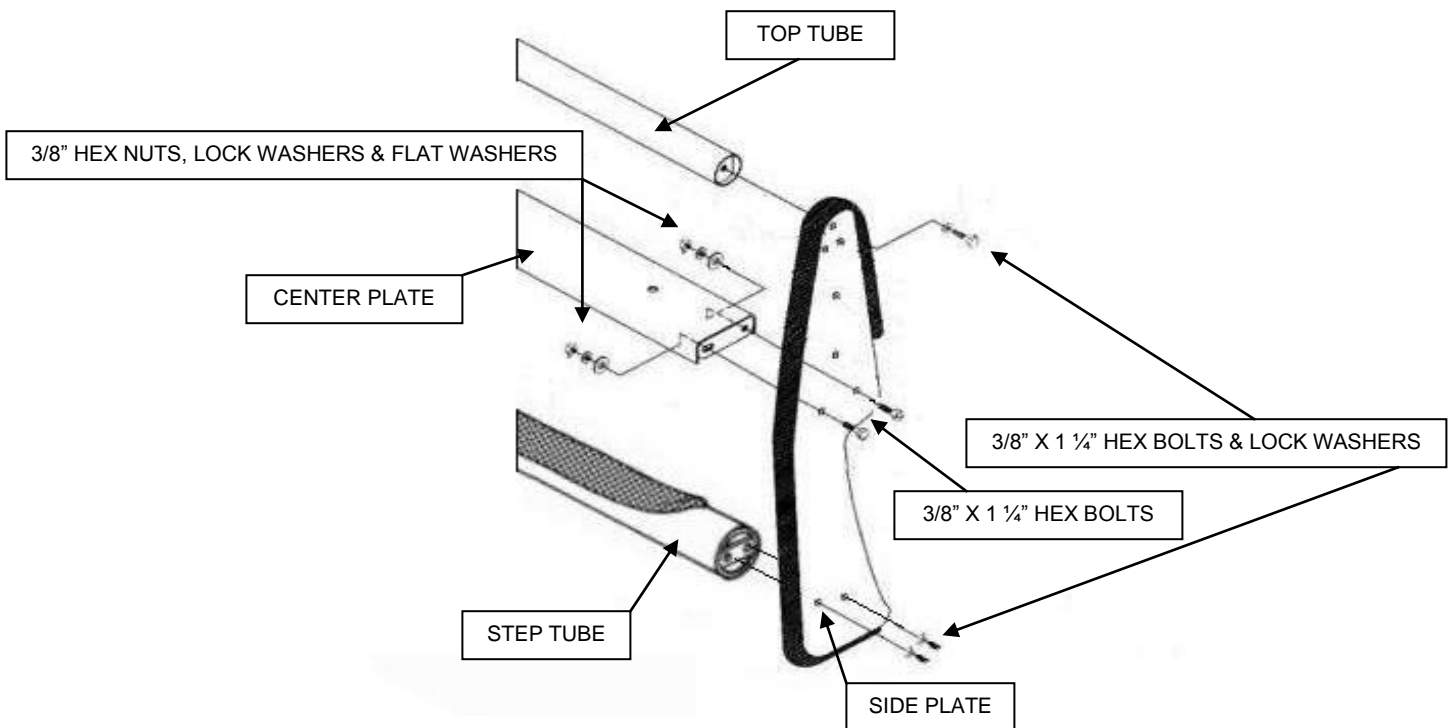

ASSEMBLY

STEP 1. BEGIN THE GRILLE GUARD ASSEMBLY BY LAYING THE COMPONENTS OUT ON A PROTECTIVE SURFACE.

STEP 2. POSITION THE GRILLE GUARD SIDE PLATES WITH THE FRONT EDGE DOWN AND THE TOP AND BOTTOM STEP TUBE BETWEEN THE SIDE PLATES.

STEP 3. ATTACH THE TOP AND BOTTOM STEP TUBE TO THE SIDE PLATES USING THE 3/8" X 1 1/4" HEX BOLTS AND LOCK WASHERS. DO NOT TIGHTEN.

STEP 4. POSITION THE CENTER PLATE BETWEEN THE GRILLE GUARD SIDE PLATES, WITH THE **SLOTTED MOUNTING HOLES** IN THE CENTER PLATE DOWN.

STEP 5. INSERT THE 3/8" X 1 1/4" HEX BOLTS THROUGH THE HOLES IN THE SIDE PLATES AND CENTER PLATE, AND INSTALL THE 3/8" FLAT WASHERS, LOCK WASHER AND HEX NUTS. DO NOT TIGHTEN.

STEP 6. ALIGN THE GRILLE GUARD ASSEMBLY, AND TIGHTEN ALL NUTS AND BOLTS



Innovative Truck Racks!

Two Companies ! One Vision !



Built to demand respect !

3000 SERIES STEPGUARD

GRILLE GUARD

INSTALLATION INSTRUCTIONS

PART NO. 3289B & 3289C 06-08 FORD F-150 2/4WD

Do not attempt to install this product on any vehicle other than the one it is designed for and listed above!

PACKING LIST

<u>QTY</u>	<u>PARTS DESCRIPTION</u>	<u>QTY</u>	<u>PARTS DESCRIPTION</u>
6	1/4" X 3/4" BUTTON HEAD BOLTS	4	1/2" FLAT WASHERS
6	1/4" LOCK WASHERS	4	1/2" LOCK WASHERS
6	1/4" FLAT WASHERS	2	1122LP LICENSE PLATE BRACKETS
6	1/4" HEX NUTS	1	1123CD DRIVER LOWER BRACKET
4	3/8" X 1 1/4" HEX BOLTS	1	1123CP PASSENGER LOWER BRACKET
4	3/8" LOCK WASHERS	2	1122LP LICENSE PLATE BRACKETS
4	3/8" HEX NUTS		
4	1/2" X 1 1/2" HEX BOLTS		

INSTALLATION INSTRUCTIONS

STEP 1. REMOVE THE LICENSE PLATE AND MOUNTING BRACKET FROM THE FRONT BUMPER.

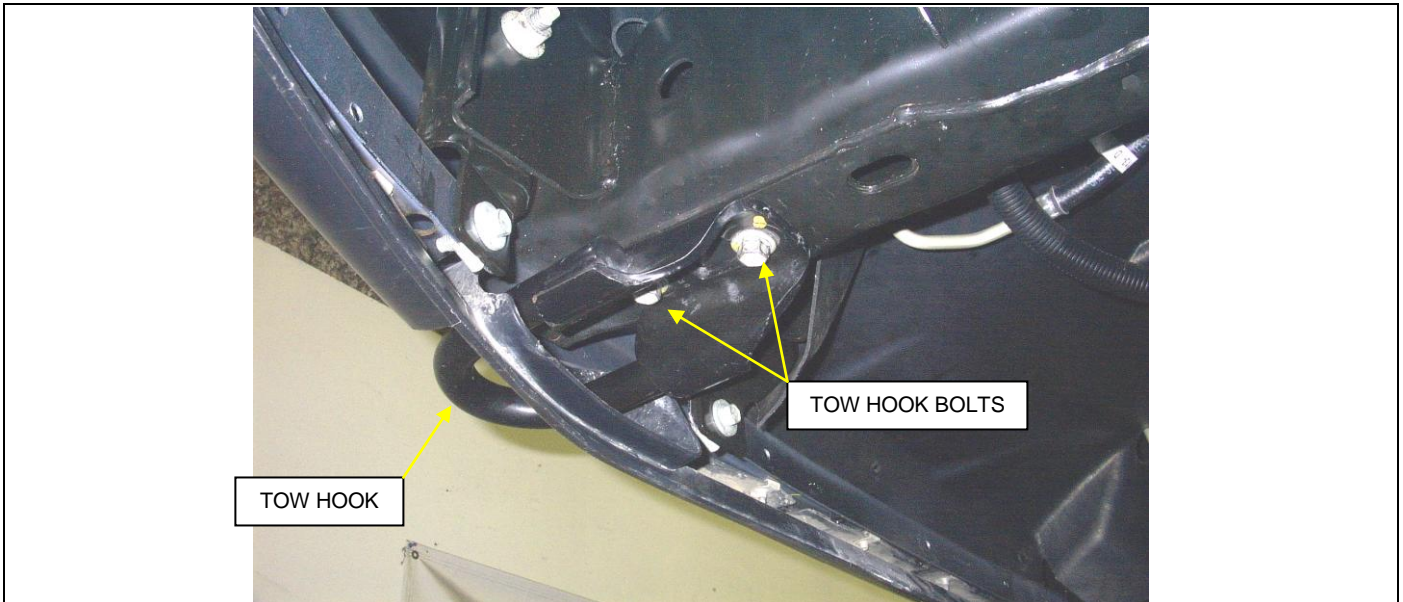

STEP 2. BEGINNING WITH THE DRIVER SIDE, REMOVE THE BOLTS AND TOW HOOK FROM THE BOTTOM OF THE FRAME RAIL.

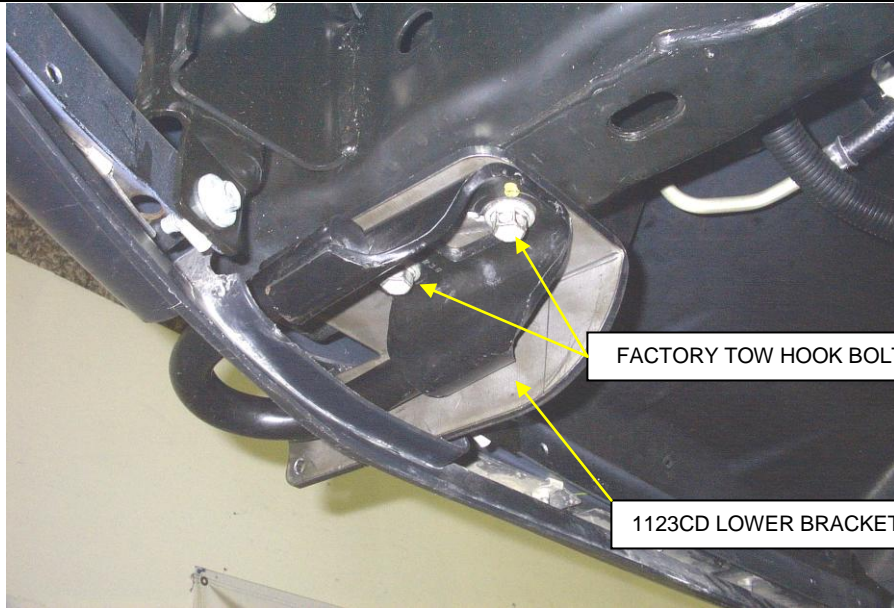

STEP 3. POSITION 1123CD LOWER MOUNTING BRACKET BETWEEN THE FRAME AND TOW HOOK. LOOSELY ATTACH THE BRACKET AND TOW HOOK TO THE FRAME USING THE FACTORY BOLTS, AND NUT PLATE.

REPEAT THE ABOVE STEPS TO INSTALL THE PASSENGER SIDE LOWER MOUNTING BRACKET.

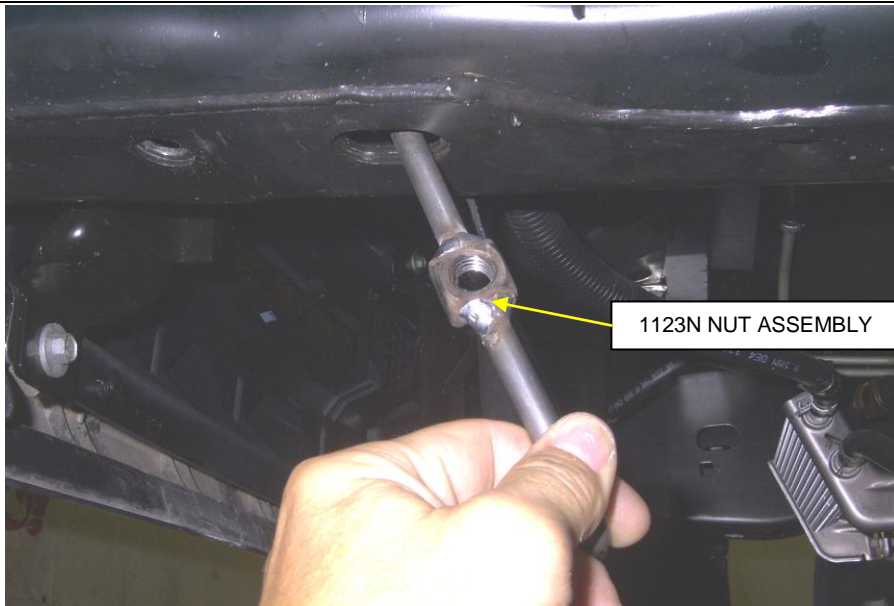

2 WHEEL DRIVE MODELS) TO ATTACH THE LOWER MOUNTING BRACKET, POSITION ONE OF THE 1123N NUT ASSEMBLIES UP THROUGH THE LARGER HOLE IN THE BOTTOM OF THE FRAME. ALIGN THE NUTS WITH THE TWO MATCHING HOLES IN THE FRAME, AND ATTACH THE MOUNTING BRACKET USING THE ½" X 1 ½" BOLTS, AND WASHERS SUPPLIED.

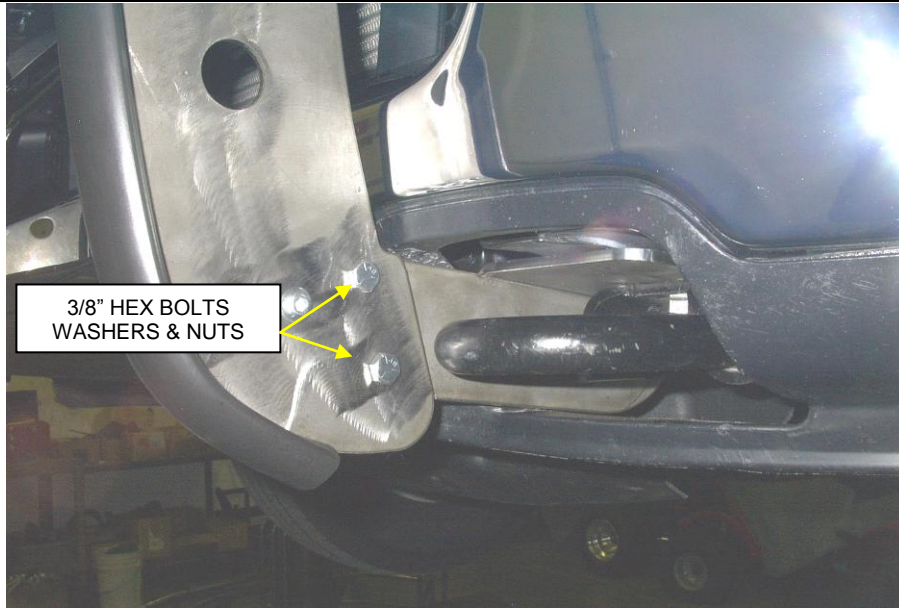

3/8" HEX BOLTS
WASHERS & NUTS

STEP 4. ATTACH THE GRILLE GUARD ASSEMBLY TO THE LOWER MOUNTING BRACKETS USING THE 3/8" X 1 1/4" HEX BOLTS, WASHERS AND NUTS. DO NOT TIGHTEN.

STEP 5. ALIGN THE GRILLE GUARD ASSEMBLY WITH THE FRONT OF THE VEHICLE AND TIGHTEN ALL MOUNTING NUTS AND BOLTS.

IMPORTANT: CAREFULLY CLOSE THE HOOD AND CHECK FOR CLEARANCE BETWEEN THE GRILLE, AND GRILLE GUARD TOP TUBE. IF NECESSARY, LOOSEN THE MOUNTING BRACKETS AND ADJUST.

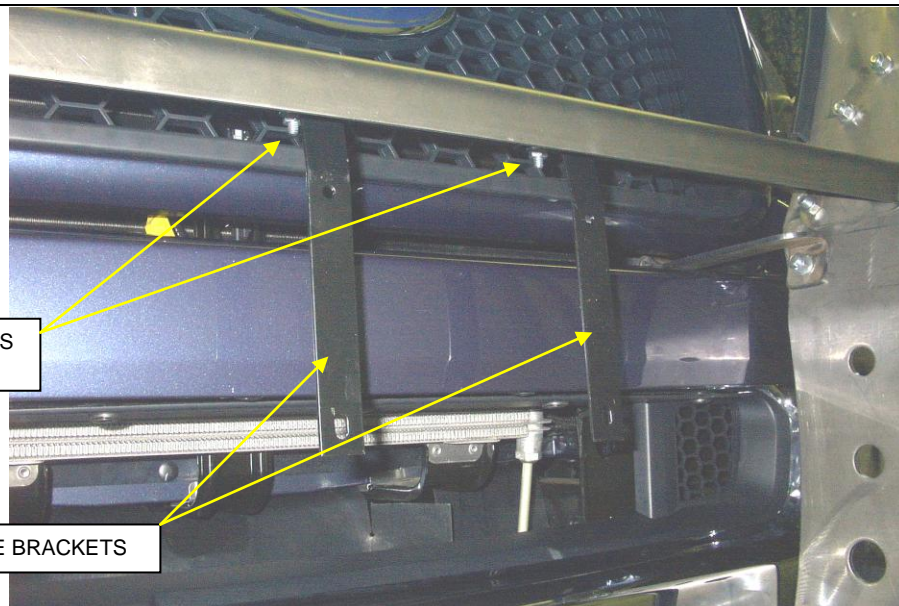

1/4" BUTTON HEAD BOLTS
WASHERS & NUTS

1122LP LICENSE PLATE BRACKETS

STEP 6. IF YOUR STATE LAW REQUIRES A FRONT LICENSE PLATE, ATTACH THE 1122LP BRACKETS, AND LICENSE PLATE TO THE GRILLE GUARD CENTER PLATE USING THE 1/4" BUTTON HEAD BOLTS, WASHERS, AND NUTS.