

INSTALLATION INSTRUCTIONS

3000 SERIES STEP GUARD (CENTER GRILLE GUARD ONLY)

DODGE RAM SLT 1500 2/4WD

PART # 3214 (B-C)



PACKING LIST

| <u>QTY</u> | <u>PARTS DESCRIPTION</u> | <u>QTY</u> | <u>PARTS DESCRIPTION</u> |
|------------|--------------------------|------------|--------------------------------------|
| 10 | 3/8" X 1 1/4" HEX BOLTS | 2 | 3214 SIDE PLATES |
| 10 | 3/8" LOCK WASHERS | 1 | ST3160 3" X 35 3/4" BOTTOM STEP TUBE |
| 4 | 3/8" HEX NUTS | 1 | TT3534 2" X 35 3/4" TOP TUBE |
| 4 | 3/8" FLAT WASHERS | 1 | CP3006 35 3/4" CENTER PLATE |

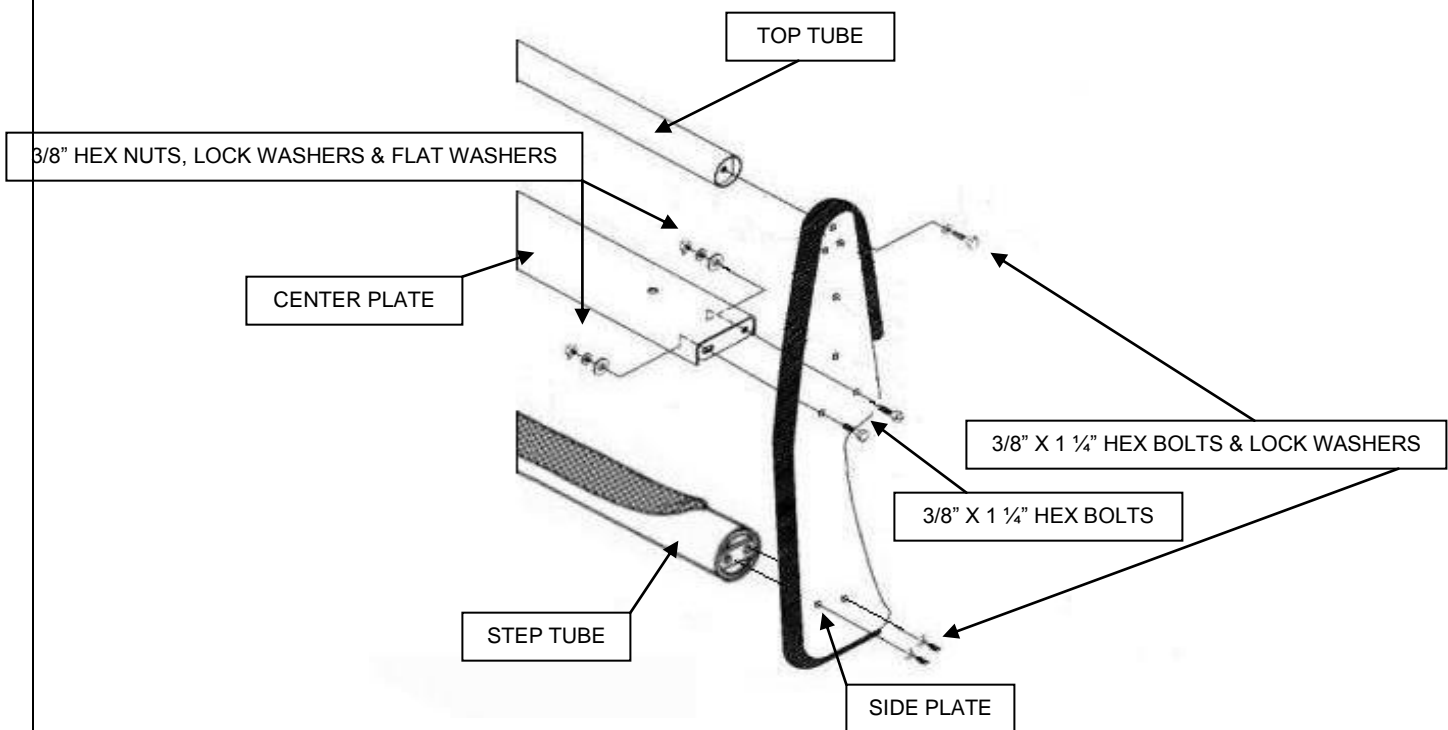

ASSEMBLY

- STEP 1.** BEGIN THE GRILLE GUARD ASSEMBLY BY LAYING THE COMPONENTS OUT ON A PROTECTIVE SURFACE.
- STEP 2.** POSITION THE GRILLE GUARD SIDE PLATES WITH THE FRONT EDGE DOWN AND THE 2" TOP AND BOTTOM STEP TUBE BETWEEN THE SIDE PLATES.
- STEP 3.** ATTACH THE TOP AND BOTTOM STEP TUBE TO THE SIDE PLATES USING THE 3/8" X 1 1/4" HEX BOLTS AND LOCK WASHERS. DO NOT TIGHTEN.
- STEP 4.** POSITION THE CENTER PLATE BETWEEN THE GRILLE GUARD SIDE PLATES, WITH THE **SLOTTED MOUNTING HOLES** IN THE CENTER PLATE DOWN.
- STEP 5.** INSERT THE 3/8" X 1 1/4" HEX BOLTS THROUGH THE HOLES IN THE SIDE PLATES AND CENTER PLATE, AND INSTALL THE 3/8" FLAT WASHERS, LOCK WASHER AND HEX NUTS. DO NOT TIGHTEN.
- STEP 6.** ALIGN THE GRILLE GUARD ASSEMBLY, AND TIGHTEN ALL NUTS AND BOLTS.

INSTALLATION INSTRUCTIONS

3000 SERIES STEP GUARD (CENTER GRILLE GUARD ONLY)

DODGE RAM SLT 1500 2/4WD

PART # 3214 (B-C)



PACKING LIST

| <u>QTY</u> | <u>PARTS DESCRIPTION</u> | <u>QTY</u> | <u>PARTS DESCRIPTION</u> |
|------------|--------------------------|------------|-------------------------------|
| 2 | 3/8" X 1 1/4" HEX BOLTS | 4 | 1/2" LOCK WASHERS |
| 2 | 3/8" FLAT WASHERS | 1 | 2140P PASSENGER LOWER BRACKET |
| 2 | 3/8" LOCK WASHERS | 1 | 2140D DRIVER LOWER BRACKET |
| 2 | 3/8" HEX NUTS | 1 | 2141P PASSENGER UPPER BRACKET |
| 4 | 1/2" HEX NUTS | 1 | 2141D DRIVER UPPER BRACKET |
| 4 | 1/2" FLAT WASHERS | 4 | 1/2" X 1 1/2" HEX BOLTS |

INSTALLATION

STEP 1. READ THE INSTRUCTIONS COMPLETELY. **NOTE: THIS INSTALLATION REQUIRES MODIFYING OR PERMANENT REMOVAL OF THE LOWER BUMPER VALANCE.** BEGIN THE INSTALLATION BY REMOVING THE LOWER BUMPER VALANCE. **FIG. #1**

STEP 2. REMOVE THE LICENSE PLATE AND MOUNTING BRACKET FROM THE FRONT BUMPER. IF YOUR STATE LAW REQUIRES A FRONT LICENSE PLATE, ATTACH THE LICENSE PLATE DIRECTLY TO THE BUMPER USING THE LOWER HOLES IN THE LICENSE PLATE, AND THE FACTORY SCREWS. **FIG. #2**

STEP 3. LOCATE THE OUTER (2) NUTS AND STUDS THAT SECURE THE BUMPER BRACKET TO THE DRIVER SIDE FRAME RAIL. **FIG. #3**

STEP 4. REMOVE THE (2) NUTS AND POSITION 2140D LOWER MOUNTING BRACKET OVER THE STUDS. SECURE THE LOWER BRACKET USING THE FACTORY NUTS. DO NOT TIGHTEN. **FIG. #4**
REPEAT THE PROCEDURE FOR THE PASSENGER SIDE LOWER BRACKET.

STEP 5. (OPTIONAL) MEASURE AND NOTCH THE BUMPER VALANCE TO FIT WITH THE LOWER BRACKETS. REINSTALL THE BUMPER VALANCE USING THE FACTORY FASTENERS.

STEP 6. ATTACH THE GRILLE GUARD ASSEMBLY TO THE OUTSIDE OF THE LOWER MOUNTING BRACKETS USING THE 1/2" X 1 1/2" HEX BOLTS, FLAT WASHERS, LOCK WASHERS AND HEX NUTS. DO NOT TIGHTEN. **FIG. #5**

STEP 7. OPEN THE HOOD, AND LOCATE THE (2) BOLTS SECURING THE FRAME CROSS MEMBER. **FIG. #6**

STEP 8. REMOVE THE BOLTS AND ATTACH 2141D UPPER BRACKET TO THE TOP OF THE CROSS MEMBER USING THE FACTORY BOLTS. DO NOT TIGHTEN. **FIG. #7**
REPEAT THE PROCEDURE FOR THE PASSENGER SIDE UPPER BRACKET.

STEP 7. ATTACH THE GRILLE GUARD ASSEMBLY TO THE OUTSIDE OF THE UPPER MOUNTING BRACKETS USING THE 3/8" X 1 1/4" HEX BOLTS, FLAT WASHERS, LOCK WASHERS AND HEX NUTS. DO NOT TIGHTEN. **FIG. #8**

STEP 8. ALIGN THE GRILLE GUARD ASSEMBLY WITH THE FRONT OF THE VEHICLE AND TIGHTEN ALL NUTS AND BOLTS.

IMPORTANT: CAREFULLY CLOSE THE HOOD AND CHECK FOR CLEARANCE BETWEEN THE VEHICLES GRILLE AND GRILLE GUARD TOP TUBE. IF NECESSARY, LOOSEN THE MOUNTING BRACKETS AND ADJUST.



FIG #1

LICENSE PLATE BRACKET

LOWER BUMPER VALANCE



FIG #2

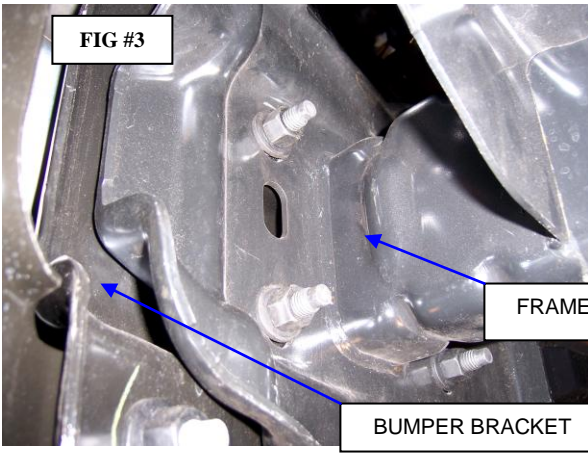

FIG #3

FRAME RAIL

BUMPER BRACKET

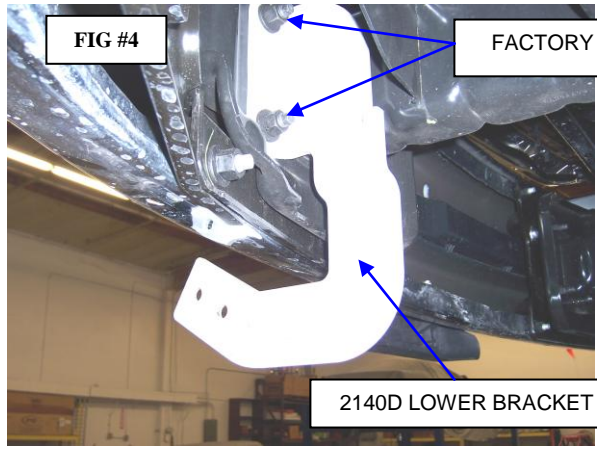

FIG #4

FACTORY NUTS

2140D LOWER BRACKET

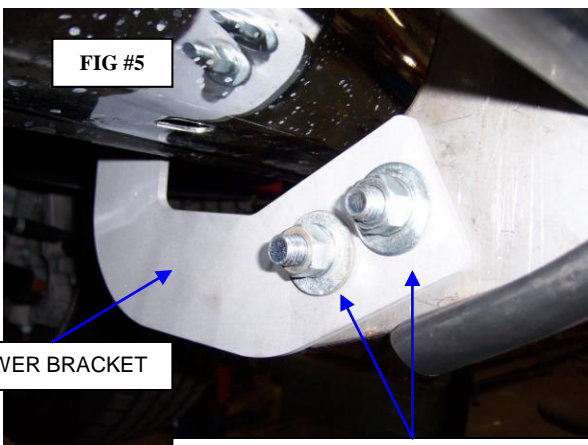

FIG #5

1604 LOWER BRACKET

1/2" X 1 1/2" HEX BOLTS, WASHERS & NUTS

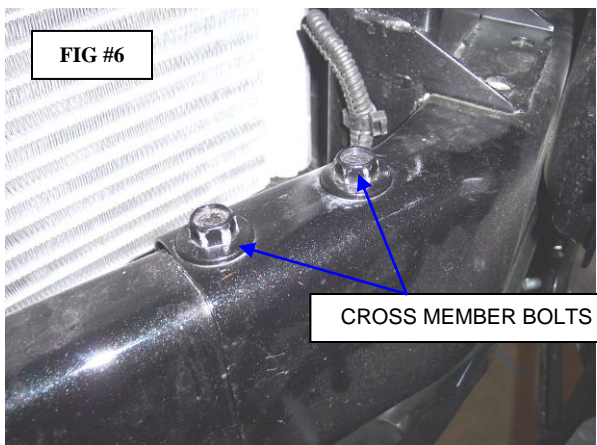

FIG #6

CROSS MEMBER BOLTS

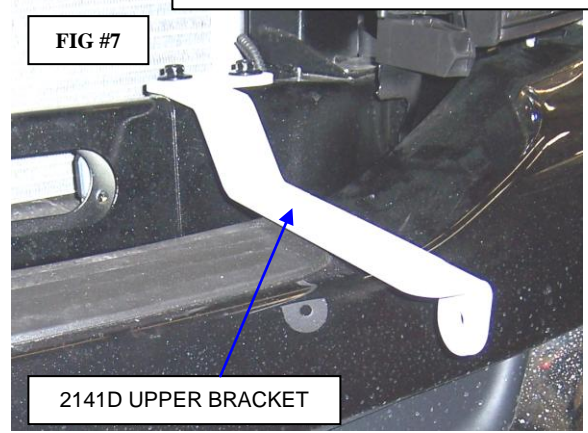

FIG #7

2141D UPPER BRACKET

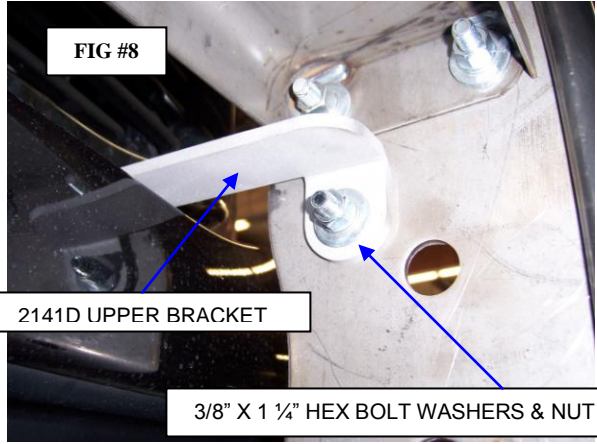

FIG #8

2141D UPPER BRACKET

3/8" X 1 1/4" HEX BOLT WASHERS & NUT