



3000 Series (part# 3210) installation instructions for 2002 Dodge Ram 1500

DO NOT ATTEMPT TO INSTALL THIS PRODUCT ON ANY VEHICLE OTHER THAN THE ONE IT IS DESIGNED FOR!

Packing List

Qty	Description	Qty	Description
2 NYLON FLANGE WASHERS	6 1/2" LOCK WASHERS
2 1/4" SOCKET SCREWS	6 1/2" HEX NUTS
4 3/8" X 1" BUTTON HEAD BOLTS	2 1084A UPPER ANGLE BRACKETS
8 3/8" X 1" HEX BOLTS	1 1084BD DRIVER SIDE UPPER BRACKET
6 3/8" LOCK WASHERS	1 1084BP PASSENGER SIDE UPPER BRACKET
6 3/8" HEX NUTS	1 1084CD DRIVER SIDE LOWER BRACKET
6 1/2" X 1 1/2" HEX BOLTS	1 1084CP PASSENGER SIDE LOWER BRACKET
6 1/2" FLAT WASHERS		

WARNING!

Carefully read all the instructions prior to attempting to install this product. If you are not familiar with using workshop tools or with workshop safety practices, take the product and vehicle to a skilled installer. Go Rhino! Products accepts no responsibility for any damage or injuries that may result from the product(s) being incorrectly installed. Before attempting to install accessories, park the vehicle on flat level ground, apply the emergency brake and disconnect the battery. If installation requires the use of a jack or lift, use only one with the correct load rating for the

vehicle, follow the manufacturer's instructions and use wheel chocks.

After installation, check the operation of all lights and turn signals, periodically check all fasteners for tightness. Retighten only loose fasteners as over-tightening snug fasteners can result in breaking or stripping them. Failure to maintain tightness of fasteners could result in the product detaching itself from the vehicle and possibly jamming wheels etc. This condition could cause serious personal bodily injury.

Assembly Instructions

- 1) BEGIN THE ASSEMBLY BY LOOSELY ATTACHING THE BOTTOM STEP TUBE TO THE GRILLE GUARD SIDE PLATES USING THE 3/8" X 1" BUTTON HEAD BOLTS.
- 2) INSERT THE FLANGE WASHERS IN THE SIDE PLATES. POSITION THE TOP TUBE BETWEEN THE GRILLE GUARD SIDE PLATES, AND SLIDE THE BRUSH GUARDS THROUGH THE SIDE PLATES, FLANGED WASHERS AND INTO THE TOP TUBE.
- 3) POSITION THE CENTER PLATE BETWEEN THE SIDE PLATES, AND ATTACH THE CENTER PLATE TO THE SIDE PLATES AND BRUSH GUARDS USING THE 3/8" X 1" HEX BOLTS, LOCK WASHERS, AND HEX NUTS.
- 4) ATTACH THE EURO TUBE TO THE BRUSH GUARDS USING THE 5/16" X 1 3/4" FLAT HEAD SCREWS.
- 5). ALIGN THE GRILLE AND BRUSH GUARD ASSEMBLY AND TIGHTEN ALL NUTS AND BOLTS. NOTE: SECURE THE TOP TUBE USING THE 1/4" SOCKET SCREWS.
- 6) ATTACH THE HEAD LIGHT PROTECTORS TO THE BRUSH GUARDS USING THE 1/4" X 3/4" BUTTON HEAD BOLTS AND TO THE SIDE PLATES USING THE 5/16" X 1" BUTTON HEAD BOLTS AND LOCK NUTS.

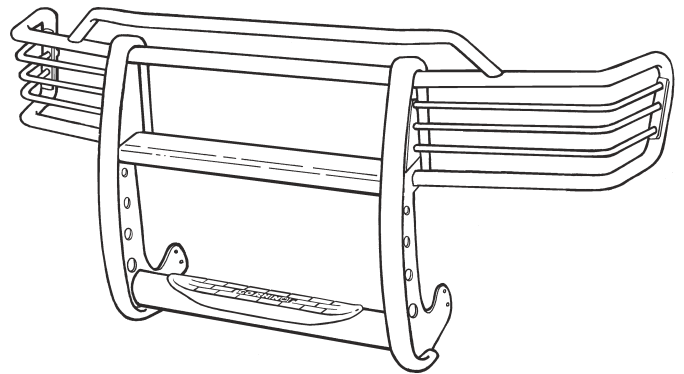

3000 Series (part# 3210) installation instructions for 2002 Dodge Ram 1500

DO NOT ATTEMPT TO INSTALL THIS PRODUCT ON ANY VEHICLE OTHER THAN THE ONE IT IS DESIGNED FOR!

Installation Instructions

1) BEGINNING WITH THE DRIVER SIDE, LOCATE AND REMOVE THE TWO HEX NUTS FROM THE FLANGE BOLT ASSEMBLY THAT SECURE THE BUMPER BRACKET TO THE SIDE OF THE FRAME RAIL. IF NECESSARY, RE-INSTALL THE FLANGE BOLT ASSEMBLY SO THE THREADS ARE FACING TO THE CENTER OF THE VEHICLE.

2) POSITION 1084CP LOWER BRACKET OVER THE FLANGE BOLTS, AND LOOSELY ATTACH THE BRACKET TO THE SIDE OF THE FRAME USING THE FACTORY NUTS. REPEAT THE ABOVE STEPS FOR THE PASSENGER SIDE. *FIGURE 1.*

3) REMOVE THE LICENSE PLATE AND MOUNTING BRACKET FROM THE FRONT BUMPER. ATTACH THE LICENSE PLATE DIRECTLY TO THE BUMPER USING THE LOWER HOLES IN THE LICENSE PLATE, AND THE FACTORY SCREWS.

4) OPEN THE HOOD, AND LOCATE ON THE BACK EDGE AT THE TOP OF THE BUMPER, THE NUTS AND BOLTS THAT CONNECT THE BUMPER TO THE BUMPER BRACKETS. REMOVE THE NUTS (1) PER SIDE CLOSEST TO THE CENTER OF THE VEHICLE.

5) ATTACH 1084A UPPER ANGLE BRACKETS TO THE BUMPER BRACKETS USING THE FACTORY NUTS. *FIGURE 2.*

6) USING THE 1/2" x 1 1/2" HEX BOLTS, WASHERS AND NUTS, LOOSELY ATTACH 11084BD AND 1084BP UPPER BRACKET TO THE ANGLE BRACKETS.

7) ATTACH THE GRILLE GUARD ASSEMBLY TO THE FRAME BRACKETS USING THE 1/2" FASTENERS AND TO THE UPPER BRACKETS USING THE 3/8" FASTENERS SUPPLIED.

8) ALIGN THE GRILLE GUARD ASSEMBLY WITH THE FRONT OF THE VEHICLE AND TIGHTEN ALL MOUNTING NUTS AND BOLTS.

IMPORTANT: CAREFULLY CLOSE THE HOOD AND CHECK FOR CLEARANCE BETWEEN THE GRILLE AND GRILLE GUARD TOP TUBE. IF NECESSARY, LOOSEN THE MOUNTING BRACKETS AND ADJUST.

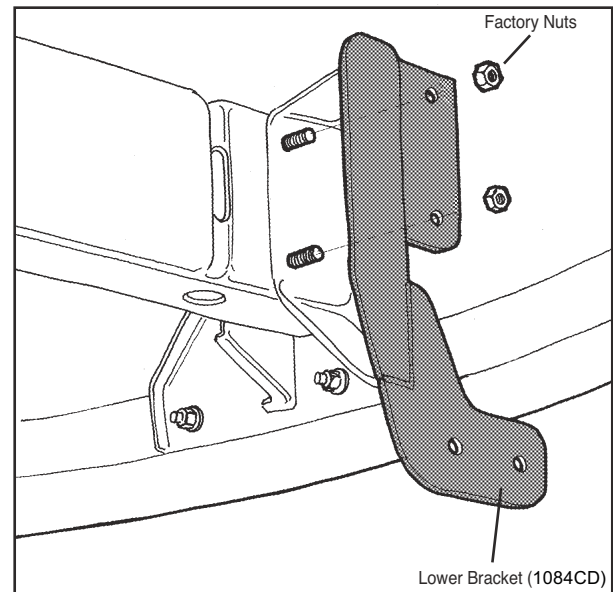

FIGURE 1

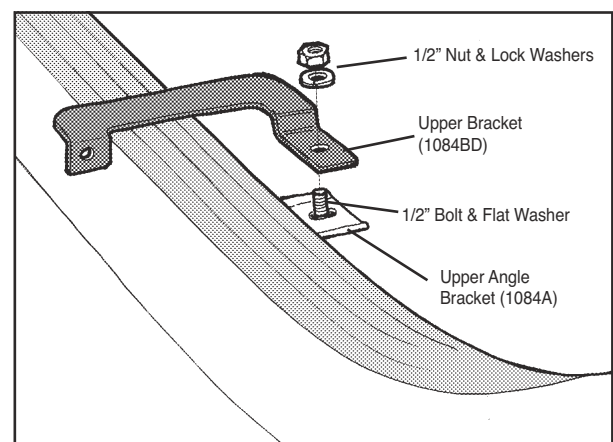

FIGURE 2