

INSTALLATION INSTRUCTIONS

3000 SERIES STEP GUARD (CENTER GRILLE GUARD & BRUSH GUARDS)
CHEVROLET SILVERADO 2500 & 3500 2/4WD
PART # 3168 (MB-MC)



PACKING LIST

<u>QTY</u>	<u>PARTS DESCRIPTION</u>	<u>QTY</u>	<u>PARTS DESCRIPTION</u>
2	1/4" X 3/4" BUTTON HEAD BOLTS	2	3168 SIDE PLATES
8	5/16" X 3/4" BUTTON HEAD BOLTS	1	3164P PASSENGER BRUSH GUARD
8	5/16" LOCK NUTS	1	3164D DRIVER BRUSH GUARD
8	3/8" X 1" BUTTON HEAD BOLTS	1	C10P PASSENGER HEAD LIGHT PROTECTOR
4	3/8" X 1 1/4" HEX BOLTS	1	C10D DRIVER HEAD LIGHT PROTECTOR
8	3/8" LOCK WASHERS	1	ST3160 3" X 35 3/4" BOTTOM STEP TUBE
4	3/8" HEX NUTS	1	TT3534 2" X 35 3/4" TOP TUBE
4	3/8" FLAT WASHERS	1	CP3006 35 3/4" CENTER PLATE

ASSEMBLY

STEP 1. BEGIN THE ASSEMBLY BY LAYING THE COMPONENTS OUT ON A PROTECTIVE SURFACE.

STEP 2. POSITION THE GRILLE GUARD SIDE PLATES WITH THE FRONT EDGE DOWN AND THE 2" TOP AND BOTTOM STEP TUBE BETWEEN THE SIDE PLATES.

STEP 3. ATTACH THE TOP TUBE TO THE SIDE PLATES USING (2) 3/8" X 1 1/4" HEX BOLTS AND LOCK WASHERS. DO NOT TIGHTEN.

STEP 4. ATTACH THE STEP TUBE TO THE SIDE PLATES USING (4) 3/8" X 1" BUTTON HEAD BOLTS. DO NOT TIGHTEN.

STEP 5. POSITION THE CENTER PLATE BETWEEN THE GRILLE GUARD SIDE PLATES, WITH THE **SLOTTED MOUNTING HOLES** IN THE CENTER PLATE DOWN. ATTACH THE CENTER PLATE TO THE SIDE PLATES USING (4) 3/8" X 1" BUTTON HEAD BOLTS, FLAT WASHERS, LOCK WASHERS AND HEX NUTS. DO NOT TIGHTEN.

STEP 6. TIGHTEN THE 2" TOP TUBE.

STEP 7. POSITION THE DRIVER SIDE BRUSH GUARD UP TO THE GRILLE GUARD ASSEMBLY. LOOSELY ATTACH THE BOTTOM OF THE BRUSH GUARD TO THE GRILLE GUARD SIDE PLATE USING (1) 3/8" X 1 1/4" HEX BOLT AND LOCK WASHER. ATTACH THE TOP OF THE BRUSH GUARD TO THE SIDE PLATE USING (2) 5/16" X 3/4" BUTTON HEAD BOLTS, AND LOCK NUTS.

REPEAT THE ABOVE STEP TO INSTALL THE PASSENGERS SIDE BRUSH GUARD.

STEP 8. LOOSELY ATTACH THE DRIVER SIDE HEAD LIGHT PROTECTOR TO THE BRUSH GUARD USING (1) 1/4" X 3/4" BUTTON HEAD BOLT, AND TO THE SIDE PLATE USING (2) 5/16" X 3/4" BUTTON HEAD BOLTS AND LOCK NUTS. REPEAT THIS STEP TO INSTALL THE PASSENGER SIDE HEAD LIGHT PROTECTOR.

STEP 9. ALIGN THE GRILLE AND BRUSH GUARD ASSEMBLY, AND TIGHTEN ALL NUTS AND BOLTS.

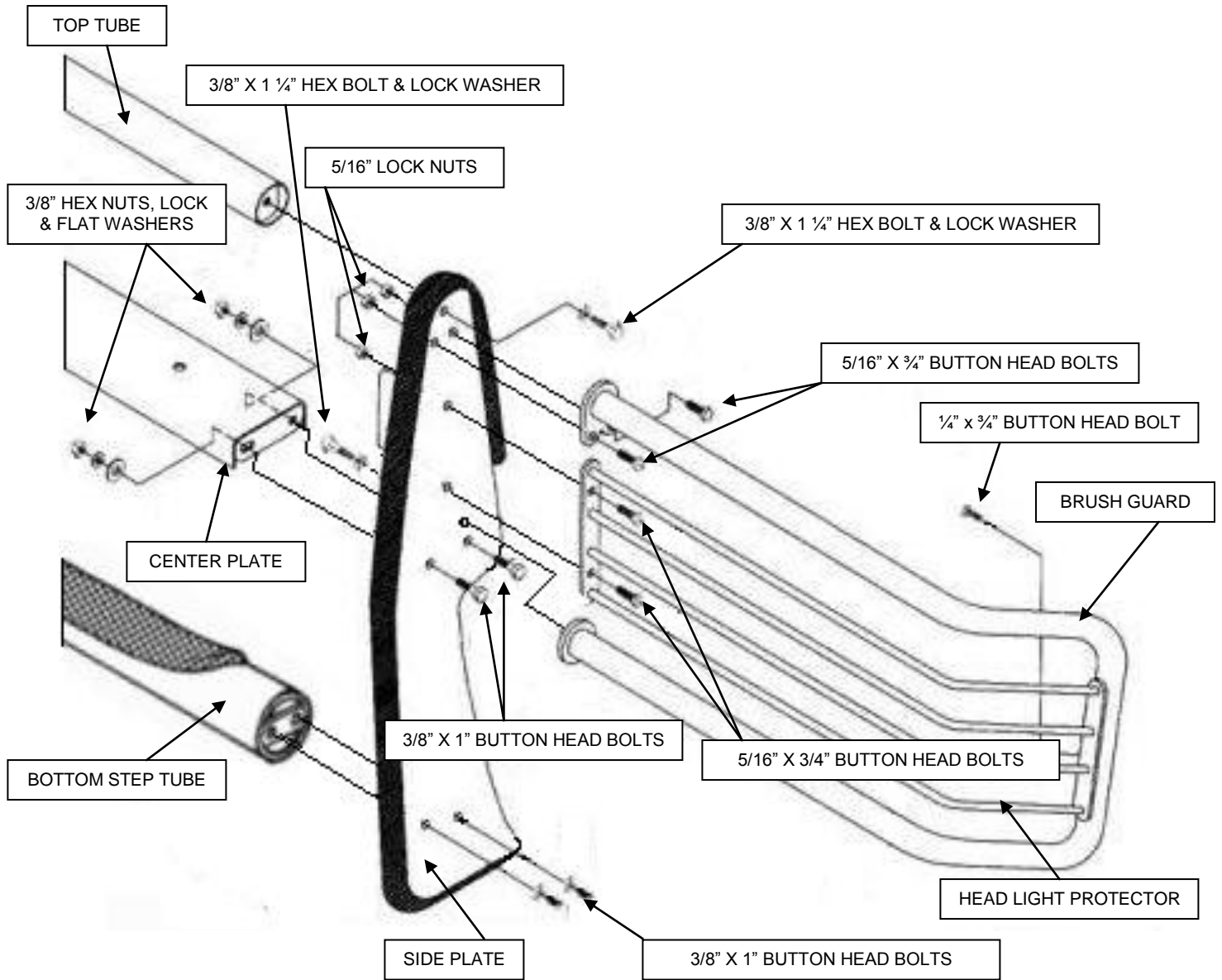

INSTALLATION INSTRUCTIONS

3000 SERIES STEP GUARD (CENTER GRILLE GUARD & BRUSH GUARDS)

CHEVROLET SILVERADO 2500 & 3500 2/4WD

PART # 3168 (MB-MC)



PACKING LIST

<u>QTY</u>	<u>PARTS DESCRIPTION</u>	<u>QTY</u>	<u>PARTS DESCRIPTION</u>
2	3/8" X 1" BUTTON HEAD BOLTS	1	1680P PASSENGER LOWER BRACKET
2	3/8" FLAT WASHERS	1	1680D DRIVER LOWER BRACKET
2	3/8" LOCK WASHERS	2	1681 LOWER BRACKETS
2	3/8" HEX NUTS	1	1630P PASSENGER UPPER BRACKET
10	1/2" HEX NUTS	1	1630D DRIVER UPPER BRACKET
20	1/2" FLAT WASHERS	10	1/2" X 1 1/2" HEX BOLTS
10	1/2" LOCK WASHERS		

INSTALLATION

STEP 1. READ THE INSTRUCTIONS COMPLETELY.

STEP 2. OPEN THE HOOD, LOCATE AND REMOVE THE (8) PLASTIC RIVETS AND THE TRIM PANEL. **FIG #1 & FIG #2**

STEP 3. REMOVE THE (4) SCREWS SECURING THE TOP OF THE GRILLE. WORKING FROM ONE SIDE, USE A PAIR OF PLIERS TO SQUEEZE THE MOUNTING CLIPS SECURING THE GRILLE AND REMOVE THE GRILLE BY PULLING GENTLY OUTWARD. **FIG #3 & FIG #4**

STEP 4. BEGINNING WITH THE DRIVER SIDE, TEMPORALLY REMOVE THE MOUNTING BOLTS AND TOW HOOK FROM THE FRAME.

FROM BEHIND THE BUMPER FASCIA, INSERT 1680D LOWER MOUNTING BRACKET THROUGH THE TOW HOOK OPENING AND REPOSITION THE TOW HOOK INSIDE THE FRAME. **FIG #5**

STEP 5. ATTACH 1680D AND 1681 LOWER BRACKETS TO THE FRAME USING THE FACTORY TOW HOOK NUT AND BOLTS. ATTACH THE LOWER BRACKETS TOGETHER USING (1) 1/2" X 1 1/2" HEX BOLT, FLAT WASHER, LOCK WASHER AND HEX NUT. **FIG. #6 & FIG. #7** DO NOT TIGHTEN.

NOTE: IF THE VEHICLE IS NOT EQUIPPED WITH FACTORY TOW HOOKS, ATTACH THE LOWER BRACKETS TO THE FRAME USING THE 1/2" X 1 1/2" HEX BOLTS, FLAT WASHERS LOCK WASHERS AND NUTS SUPPLIED.

STEP 6. LOCATE AND REMOVE THE UPPER BUMPER BOLT FROM THE FRAME RAIL. ATTACH 1630D UPPER BRACKET TO THE FRAME, USING THE FACTORY BUMPER BOLT. **FIG #8 & FIG #9** DO NOT TIGHTEN.

STEP 7. REPEAT THE ABOVE STEPS TO INSTALL THE PASSENGER SIDE LOWER AND UPPER BRACKETS. REINSTALL THE GRILLE AND THE (4) MOUNTING SCREWS. DO NOT REINSTALL THE TRIM PANEL.

STEP 8. ATTACH THE GRILLE GUARD ASSEMBLY TO THE LOWER BRACKETS USING (4) 1/2" X 1 1/2" HEX BOLTS, FLAT WASHERS, LOCK WASHERS AND HEX NUTS AND TO THE UPPER BRACKETS USING (2) 3/8" X 1" BUTTON HEAD BOLTS, FLAT WASHERS, LOCK WASHERS AND HEX NUTS. **FIG. #10 & FIG #11**

STEP 9. ALIGN THE GRILLE GUARD ASSEMBLY WITH THE FRONT OF THE VEHICLE AND TIGHTEN ALL TOW HOOK, UPPER BRACKET AND LOWER BRACKET NUTS AND BOLTS. REINSTALL THE TRIM PANEL AND PLASTIC RIVETS.

