

## INSTALLATION INSTRUCTIONS

3000 SERIES STEP GUARD (CENTER GRILLE GUARD & BRUSH GUARDS)  
CHEVROLET SUBURBAN 2500 2/4WD  
PART # 3161 (MB-MC)



### PACKING LIST

<u>QTY</u>	<u>PARTS DESCRIPTION</u>	<u>QTY</u>	<u>PARTS DESCRIPTION</u>
2	1/4" X 3/4" BUTTON HEAD BOLTS	2	3160 SIDE PLATES
6	5/16" X 3/4" BUTTON HEAD BOLTS	1	3162P PASSENGER BRUSH GUARD
6	5/16" LOCK NUTS	1	3162D DRIVER BRUSH GUARD
6	3/8" X 1" BUTTON HEAD BOLTS	1	C9P PASSENGER HEAD LIGHT PROTECTOR
4	3/8" X 1 1/4" HEX BOLTS	1	C9D DRIVER HEAD LIGHT PROTECTOR
6	3/8" LOCK WASHERS	1	ST3160 3" X 35 3/4" BOTTOM STEP TUBE
2	3/8" HEX NUTS	1	TT3534 2" X 35 3/4" TOP TUBE
4	3/8" FLAT WASHERS	1	CP3036 35 3/4" SPECIAL CENTER PLATE

### ASSEMBLY

**STEP 1.** BEGIN THE GRILLE AND BRUSH GUARD ASSEMBLY BY LAYING THE COMPONENTS OUT ON A PROTECTIVE SURFACE.

**STEP 2.** POSITION THE GRILLE GUARD SIDE PLATES WITH THE FRONT EDGE DOWN AND THE 2" TOP AND BOTTOM STEP TUBE BETWEEN THE SIDE PLATES.

**STEP 3.** ATTACH THE TOP TUBE TO THE SIDE PLATES USING THE (2) 3/8" X 1 1/4" HEX BOLTS AND LOCK WASHERS. DO NOT TIGHTEN.

**STEP 4.** ATTACH THE STEP TUBE TO THE SIDE PLATES USING THE (4) 3/8" X 1" BUTTON HEAD BOLTS AND LOCK WASHERS. DO NOT TIGHTEN.

**STEP 5.** POSITION THE CENTER PLATE BETWEEN THE GRILLE GUARD SIDE PLATES, WITH THE **SLOTTED MOUNTING HOLES** IN THE CENTER PLATE DOWN.

**STEP 6.** INSERT (2) 3/8" X 1" BUTTON HEAD BOLTS THROUGH THE HOLES IN THE SIDE PLATES AND SLOTTED HOLES IN THE CENTER PLATE WITH THE **THREADS EXTENDING INWARD** AND INSTALL 3/8" FLAT WASHERS, LOCK WASHER AND HEX NUTS. DO NOT TIGHTEN.

**STEP 7.** INSTALL LOCK AND FLAT WASHERS ON (2) 3/8" X 1 1/4" HEX BOLTS, AND INSERT THE BOLTS THROUGH THE ROUND HOLES IN THE CENTER AND SIDE PLATES WITH THE **THREADS EXTENDING OUTWARD**.

**STEP 8.** TIGHTEN THE 2" TOP TUBE.

**STEP 9.** POSITION THE DRIVER SIDE BRUSH GUARD UP TO THE GRILLE GUARD ASSEMBLY. LOOSELY ATTACH THE BOTTOM OF THE BRUSH GUARD TO THE GRILLE GUARD SIDE PLATE USING THE 3/8" X 1 1/4" HEX BOLT INSTALLED IN STEP #7. ATTACH THE TOP OF THE BRUSH GUARD TO THE **HOLE TOWARD THE FRONT OF THE SIDE PLATE** USING (1) 5/16" X 3/4" BUTTON HEAD BOLT, AND LOCK NUT. **NOTE:** THE REMAINING BOLT WILL BE INSTALLED WITH THE UPPER BRACKET.

REPEAT THE ABOVE STEP TO INSTALL THE PASSENGERS SIDE BRUSH GUARD.

**STEP 10.** LOOSELY ATTACH THE DRIVER SIDE HEAD LIGHT PROTECTOR TO THE BRUSH GUARD USING (1) 1/4" X 3/4" BUTTON HEAD BOLT, AND TO THE SIDE PLATE USING (2) 5/16" X 3/4" BUTTON HEAD BOLTS, AND LOCK NUTS. REPEAT THIS STEP TO INSTALL THE PASSENGER SIDE HEAD LIGHT PROTECTOR.

**STEP 11.** ALIGN THE GRILLE AND BRUSH GUARD ASSEMBLY, AND TIGHTEN ALL NUTS AND BOLTS.

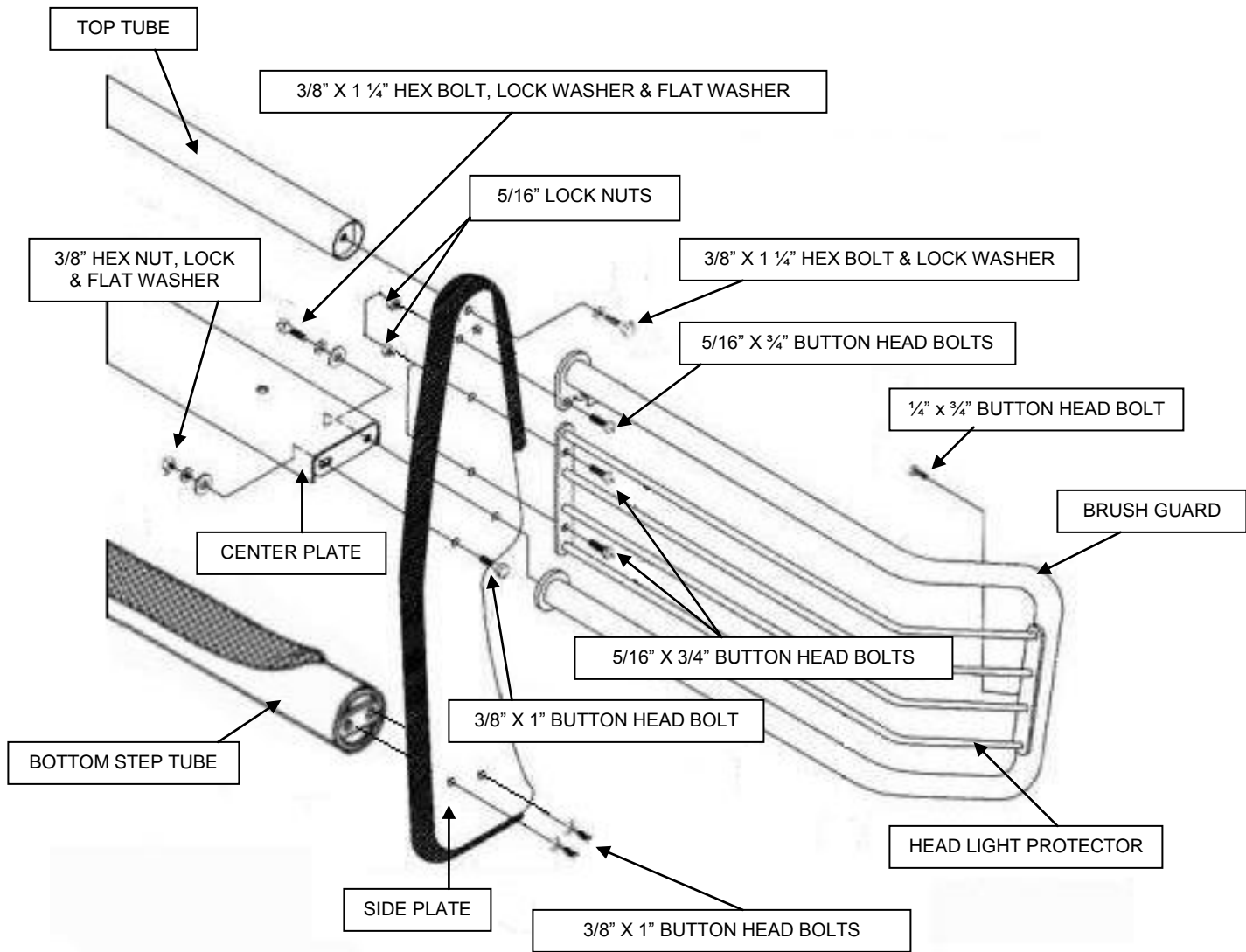

## INSTALLATION INSTRUCTIONS

3000 SERIES STEP GUARD (CENTER GRILLE GUARD & BRUSH GUARDS)  
CHEVROLET SUBURBAN 2500 2/4WD  
PART # 3161 (MB-MC)



### PACKING LIST

<u>QTY</u>	<u>PARTS DESCRIPTION</u>	<u>QTY</u>	<u>PARTS DESCRIPTION</u>
6	1/4" X 3/4" HEX BOLTS	10	1/2" X 1 1/2" HEX BOLTS
6	1/4" FLAT WASHERS	10	1/2" LOCK WASHERS
6	1/4" HEX NUTS	2	1681 LOWER BRACKETS
2	5/16" X 1" BUTTON HEAD BOLTS	1	1610D DRIVER LOWER BRACKET
2	5/16" FLAT WASHERS	1	1610P PASSENGER LOWER BRACKET
2	5/16" LOCK NUTS	1	1601D DRIVER UPPER BRACKET
20	1/2" FLAT WASHERS	1	1601P PASSENGER UPPER BRACKET
10	1/2" HEX NUTS	2	1122LP LICENSE PLATE BRACKETS

### INSTALLATION

**STEP 1.** READ THE INSTRUCTIONS COMPLETELY.

BEGINNING WITH THE DRIVER SIDE REMOVE THE (4) SCREWS AND 5MM HEX BOLT SECURING THE FRONT FASCIA FILLER PANEL. **FIG. #1**

**STEP 2.** LOCATE AND REMOVE THE PLASTIC TOW HOOK COVER FROM THE LOWER BUMPER FASCIA. IF EQUIPPED, TEMPORALLY REMOVE THE BOLTS AND TOW HOOKS.

**STEP 3.** FROM BEHIND THE BUMPER FASCIA, INSERT 1610D LOWER MOUNTING BRACKET THROUGH THE OPENING IN THE FASCIA AND REPOSITION THE TOW HOOK INSIDE THE FRAME. **FIG #2**

**STEP 4.** ATTACH 1610D AND 1681 LOWER BRACKETS TO THE FRAME USING THE FACTORY TOW HOOK NUT AND BOLTS. ATTACH THE (2) LOWER BRACKETS TOGETHER USING (1) 1/2" X 1 1/2" HEX BOLT, FLAT WASHERS, LOCK WASHER AND HEX NUT. **FIG. #3 & FIG. #4** DO NOT TIGHTEN.

**NOTE:** IF THE VEHICLE IS NOT EQUIPPED WITH FACTORY TOW HOOKS, ATTACH THE LOWER BRACKETS TO THE FRAME USING THE 1/2" X 1 1/2" HEX BOLTS, FLAT WASHERS LOCK WASHERS AND NUTS SUPPLIED.

REPEAT THE ABOVE STEPS TO INSTALL THE PASSENGER SIDE LOWER BRACKETS.

**STEP 5.** ATTACH THE GRILLE GUARD ASSEMBLY TO THE LOWER BRACKETS USING (4) 1/2" X 1 1/2" HEX BOLTS, FLAT WASHERS, LOCK WASHERS AND HEX NUTS. **FIG. #5**

**STEP 6.** OPEN THE HOOD. LOCATE AND REMOVE THE SCREWS SECURING THE GRILLE TO THE RADIATOR SHROUD.

**STEP 7.** ATTACH 1601D UPPER BRACKET TO THE RADIATOR SHROUD USING THE FACTOR SCREW AND TO THE GRILLE GUARD SIDE PLATE USING (1) 5/16" X 3/4" BUTTON HEAD BOLT, FLAT WASHER AND LOCK NUT. **FIG. #6 & FIG. #7** DO NOT TIGHTEN.

REPEAT THE ABOVE STEP TO INSTALL THE PASSENGER SIDE UPPER BRACKET.

**STEP 8.** ALIGN THE GRILLE GUARD ASSEMBLY WITH THE FRONT OF THE VEHICLE AND TIGHTEN ALL MOUNTING NUTS AND BOLTS. REATTACH THE FASCIA FILLER PANELS.

IF YOUR STATE LAW REQUIRES A FRONT LICENSE PLATE, ATTACH THE 1122LP BRACKETS, AND LICENSE PLATE TO THE GRILLE GUARD CENTER PLATE USING THE 1/4" HEX BOLTS, WASHERS AND NUTS. **FIG. #8**

