

## INSTALLATION INSTRUCTIONS

3000 SERIES STEP GUARD (CENTER GRILLE GUARD & BRUSH GUARDS)  
CHEVROLET AVALANCHE, TAHOE & SUBURBAN 1500 2/4WD  
PART # 3160 (MB-MC)



### PACKING LIST

<u>QTY</u>	<u>PARTS DESCRIPTION</u>	<u>QTY</u>	<u>PARTS DESCRIPTION</u>
2	1/4" X 3/4" BUTTON HEAD BOLTS	2	3160 SIDE PLATES
6	5/16" X 3/4" BUTTON HEAD BOLTS	1	3162P PASSENGER BRUSH GUARD
6	5/16" LOCK NUTS	1	3162D DRIVER BRUSH GUARD
6	3/8" X 1" BUTTON HEAD BOLTS	1	C9P PASSENGER HEAD LIGHT PROTECTOR
4	3/8" X 1 1/4" HEX BOLTS	1	C9D DRIVER HEAD LIGHT PROTECTOR
6	3/8" LOCK WASHERS	1	ST3160 3" X 35 3/4" BOTTOM STEP TUBE
2	3/8" HEX NUTS	1	TT3534 2" X 35 3/4" TOP TUBE
4	3/8" FLAT WASHERS	1	CP3036 35 3/4" SPECIAL CENTER PLATE

### ASSEMBLY

**STEP 1.** BEGIN THE GRILLE AND BRUSH GUARD ASSEMBLY BY LAYING THE COMPONENTS OUT ON A PROTECTIVE SURFACE.

**STEP 2.** POSITION THE GRILLE GUARD SIDE PLATES WITH THE FRONT EDGE DOWN AND THE 2" TOP AND BOTTOM STEP TUBE BETWEEN THE SIDE PLATES.

**STEP 3.** ATTACH THE TOP TUBE TO THE SIDE PLATES USING THE (2) 3/8" X 1 1/4" HEX BOLTS AND LOCK WASHERS. DO NOT TIGHTEN.

**STEP 4.** ATTACH THE STEP TUBE TO THE SIDE PLATES USING THE (4) 3/8" X 1" BUTTON HEAD BOLTS AND LOCK WASHERS. DO NOT TIGHTEN.

**STEP 5.** POSITION THE CENTER PLATE BETWEEN THE GRILLE GUARD SIDE PLATES, WITH THE **SLOTTED MOUNTING HOLES** IN THE CENTER PLATE DOWN.

**STEP 6.** INSERT (2) 3/8" X 1" BUTTON HEAD BOLTS THROUGH THE HOLES IN THE SIDE PLATES AND SLOTTED HOLES IN THE CENTER PLATE WITH THE **THREADS EXTENDING INWARD** AND INSTALL 3/8" FLAT WASHERS, LOCK WASHER AND HEX NUTS. DO NOT TIGHTEN.

**STEP 7.** INSTALL LOCK AND FLAT WASHERS ON (2) 3/8" X 1 1/4" HEX BOLTS, AND INSERT THE BOLTS THROUGH THE ROUND HOLES IN THE CENTER AND SIDE PLATES WITH THE **THREADS EXTENDING OUTWARD**.

**STEP 8.** TIGHTEN THE 2" TOP TUBE.

**STEP 9.** POSITION THE DRIVER SIDE BRUSH GUARD UP TO THE GRILLE GUARD ASSEMBLY. LOOSELY ATTACH THE BOTTOM OF THE BRUSH GUARD TO THE GRILLE GUARD SIDE PLATE USING THE 3/8" X 1 1/4" HEX BOLT INSTALLED IN STEP #7. ATTACH THE TOP OF THE BRUSH GUARD TO THE **HOLE TOWARD THE FRONT OF THE SIDE PLATE** USING (1) 5/16" X 3/4" BUTTON HEAD BOLT, AND LOCK NUT. **NOTE:** THE REMAINING BOLT WILL BE INSTALLED WITH THE UPPER BRACKET.

REPEAT THE ABOVE STEP TO INSTALL THE PASSENGERS SIDE BRUSH GUARD.

**STEP 10.** LOOSELY ATTACH THE DRIVER SIDE HEAD LIGHT PROTECTOR TO THE BRUSH GUARD USING (1) 1/4" X 3/4" BUTTON HEAD BOLT, AND TO THE SIDE PLATE USING (2) 5/16" X 3/4" BUTTON HEAD BOLTS, AND LOCK NUTS. REPEAT THIS STEP TO INSTALL THE PASSENGER SIDE HEAD LIGHT PROTECTOR.

**STEP 11.** ALIGN THE GRILLE AND BRUSH GUARD ASSEMBLY, AND TIGHTEN ALL NUTS AND BOLTS.

Rev: Date: 2/10/2017

Page 1 of 4

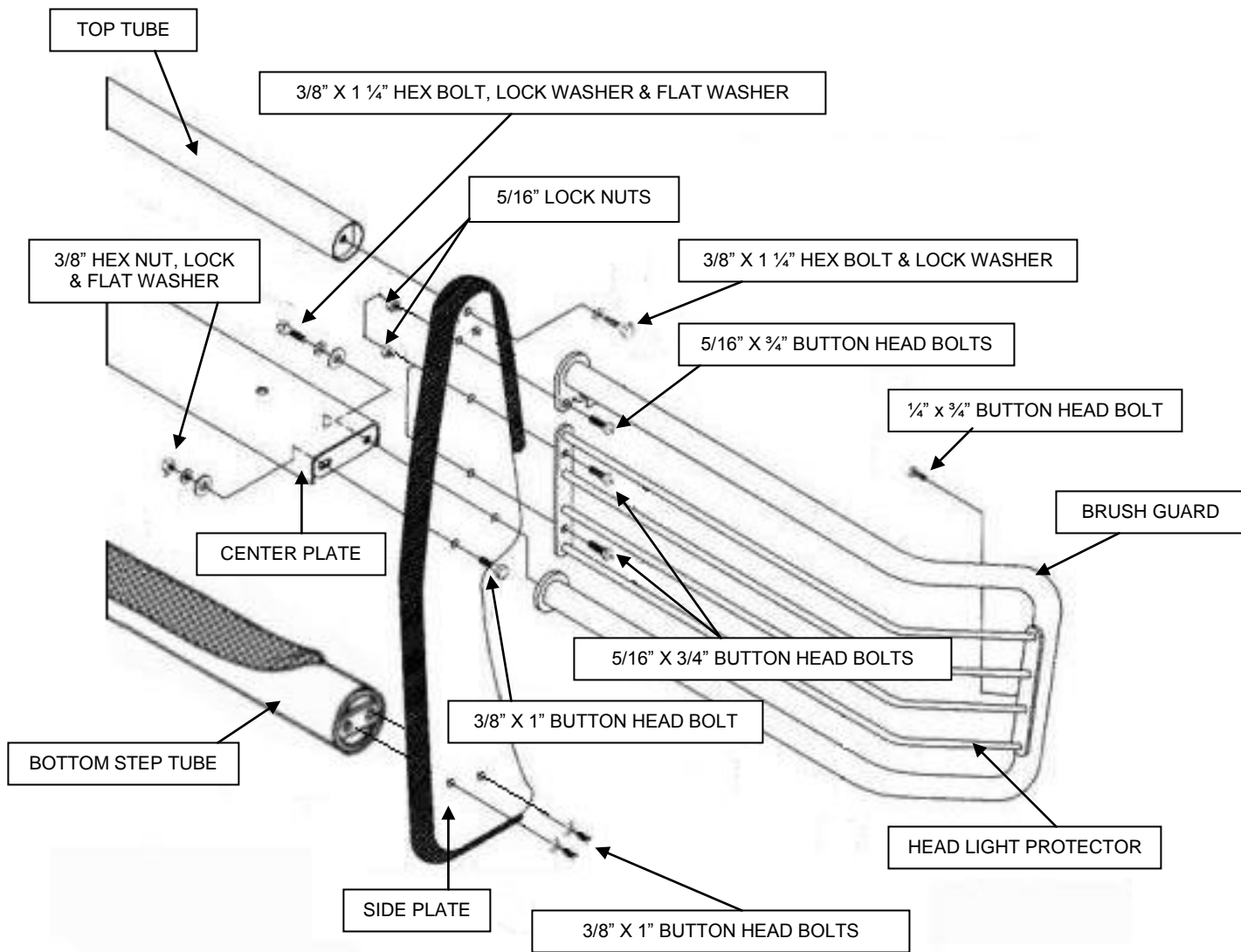

## INSTALLATION INSTRUCTIONS

3000 SERIES STEP GUARD (CENTER GRILLE GUARD & BRUSH GUARDS)  
CHEVROLET AVALANCHE, TAHOE & SUBURBAN 1500 2/4WD  
PART # 3160 (MB-MC)



### PACKING LIST

<u>QTY</u>	<u>PARTS DESCRIPTION</u>	<u>QTY</u>	<u>PARTS DESCRIPTION</u>
6	1/4" X 3/4" HEX BOLTS	24	1/2" FLAT WASHERS
6	1/4" FLAT WASHERS	12	1/2" X 1 1/2" HEX BOLTS
6	1/4" HEX NUTS	12	1/2" LOCK WASHERS
2	5/16" X 1" BUTTON HEAD BOLTS	2	1602 LOWER BRACKETS
2	5/16" FLAT WASHERS	2	1604 LOWER BRACKETS
2	5/16" LOCK NUTS	1	1601D DRIVER UPPER BRACKET
12	1/2" HEX NUTS	1	1601P PASSENGER UPPER BRACKET
		2	1122LP LICENSE PLATE BRACKETS

### INSTALLATION

**STEP 1.** READ THE INSTRUCTIONS COMPLETELY.

BEGINNING WITH THE DRIVER SIDE REMOVE THE (4) SCREWS AND 5MM HEX BOLT SECURING THE FRONT FASCIA FILLER PANEL. **FIG. #1**

**STEP 2.** LOCATE AND REMOVE THE PLASTIC TOW HOOK COVER FROM THE LOWER BUMPER FASCIA. **FIG. #2**  
IF EQUIPPED REMOVE THE BOLTS AND RECOVERY HOOK.

REPEAT THE ABOVE STEPS FOR THE PASSENGER SIDE.

**STEP 3.** LOCATE THE TWO HOLES IN THE LEFT SIDE OF THE DRIVER SIDE FRAME RAIL.

POSITION ONE OF THE 1602 LOWER MOUNTING BRACKETS UP TO THE FRAME, AND ATTACH THE BRACKET TO THE SIDE OF THE FRAME USING TWO OF THE 1/2" X 1 1/2" HEX BOLTS, FLAT WASHERS, LOCK WASHERS AND HEX NUTS.

**FIG. #3** DO NOT TIGHTEN.

**STEP 4.** LOCATE THE SINGLE HOLE IN THE RIGHT SIDE OF THE DRIVER SIDE FRAME RAIL.

POSITION ONE OF THE 1604 LOWER MOUNTING BRACKETS UP TO THE FRAME, AND ATTACH THE BRACKET TO THE FRAME AND TO THE 1602 BRACKET USING TWO OF THE 1/2" X 1 1/2" HEX BOLTS, FLAT WASHERS, LOCK WASHERS AND HEX NUTS. **FIG. #4** DO NOT TIGHTEN.

**STEP 5.** LOCATE THE SINGLE HOLE IN THE RIGHT SIDE OF THE **PASSENGER SIDE FRAME RAIL.**

POSITION ONE OF THE 1602 LOWER MOUNTING BRACKETS UP TO THE FRAME, AND ATTACH THE BRACKET TO THE FRAME USING ONE OF THE 1/2" X 1 1/2" HEX BOLT, FLAT WASHERS, LOCK WASHER AND HEX NUT. DO NOT TIGHTEN.

**STEP 6.** LOCATE THE TWO HOLES IN THE LEFT SIDE OF THE **PASSENGER SIDE FRAME RAIL.** POSITION ONE OF THE 1604 LOWER MOUNTING BRACKETS UP TO THE FRAME, AND ATTACH THE BRACKET TO THE FRAME AND TO THE 1602 BRACKET USING THREE OF THE 1/2" X 1 1/2" HEX BOLTS, FLAT WASHERS, LOCK WASHERS AND HEX NUTS. DO NOT SECURE.

**STEP 7.** ATTACH THE GRILLE GUARD ASSEMBLY TO THE OUTSIDE OF THE 1604 LOWER MOUNTING BRACKETS USING THE 1/2" X 1 1/2" HEX BOLTS, FLAT WASHERS, LOCK WASHERS AND HEX NUTS. **FIG. #5**  
DO NOT TIGHTEN

**STEP 8.** OPEN THE HOOD. LOCATE AND REMOVE THE SCREWS SECURING THE GRILLE TO THE RADIATOR SHROUD.

**STEP 9.** ATTACH 1601D UPPER BRACKET TO THE RADIATOR SHROUD USING THE FACTOR SCREW AND TO THE GRILLE GUARD SIDE PLATE USING THE 5/16" X 3/4" BUTTON HEAD BOLT, FLAT WASHER AND LOCK NUT. **FIG. #6 & FIG. #7** DO NOT TIGHTEN.

REPEAT THE ABOVE STEP FOR THE PASSENGER SIDE BRACKET.

**STEP 10.** ALIGN THE GRILLE GUARD ASSEMBLY WITH THE FRONT OF THE VEHICLE AND TIGHTEN ALL MOUNTING NUTS AND BOLTS. REATTACH THE FASCIA FILLER PANELS.

IF YOUR STATE LAW REQUIRES A FRONT LICENSE PLATE, ATTACH THE 1122LP BRACKETS, AND LICENSE PLATE TO THE GRILLE GUARD CENTER PLATE USING THE 1/4" HEX BOLTS, WASHERS AND NUTS. **FIG. #8**

