

**FORD F150**

2015

**23395**

PART LIST				
Item	Qty	Part No.	Description	Torque
1	1PZ	233950AA	Pull Pro	
2	1 SET	233950BA	Inferior Bracket	
3	2PZS	233950DA	Auxiliary Bracket	
4	8 PZS		½" x 1 ½" Carriage Hed Bolt black	
5	8 PZS		½" Flat Washer black	
6	8 PZS		½" Lock Washer black	
7	8 PZS		½" Hex Nut black	
8	4PZS		½" Flat Washer blue	
9	4PZS		½" Lock Washer blue	
10	4 PZS		½" Hex Nut blue	
11	4 PZS		½" x 1 ½" Tap Bolt	
12	1 PZ		½" Bolt Gide	

## Required Tool:

- A. Ratchet with 5" extension
- B. 9/16" Wrench or Socket
- C. 3/4" Wrench & socket
- D. 21 mm Socket
- E. 1/2" Wrench or socket
- F. Flat screwdriver
- G. Utility knife

**1.** Before beginning the installation read all instructions thoroughly and verify that all hardware is accounted for. If there are any listed parts missing, please notify your distributor immediately.

**2.** To maintain and care this product keep it clean and do not use abrasive cleaners or polish waxes. It is recommended to use only non-abrasive automotive wax such as pure carnauba to avoid scratches and rust.

**3.** The approximate installation time is **45 min.**

4. If the vehicle has tow hooks remove the plastic cap that covers the gap (**Img.1**).  
\*If vehicle does not have tow hooks follow step 6.

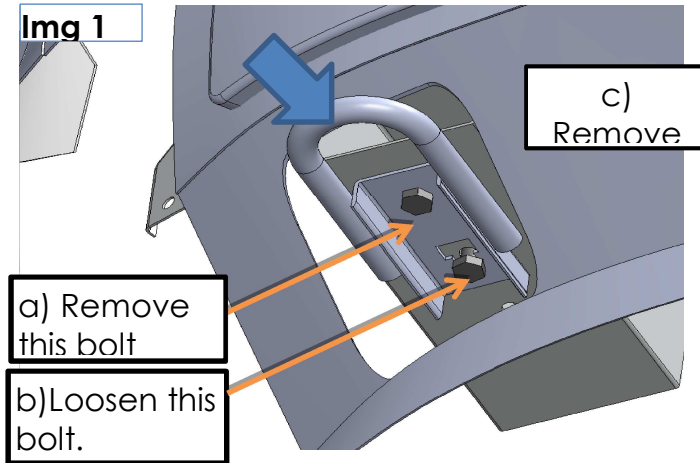

5. Place lower bracket over the exposed tow hook bolt and re-install the tow hook over the grille guard bracket. Re-install using the original equipment bolts removed in step 2. Leave loose. (**Img. 2**)



6. If the vehicle does not have tow hooks, use the template, (printed at the end) as a guide to modify the lower valance. **NOTE:** Before proceeding with the valance modification, make sure that the supplied paper template has the dimensions clearly printed and check them out. **PROFESSIONAL INSTALLATION RECOMMENDED.**

7. Align paper template to the edges shown at **Img 3**, mark area to cut out and proceed. Repeat for opposite side, review symmetry.

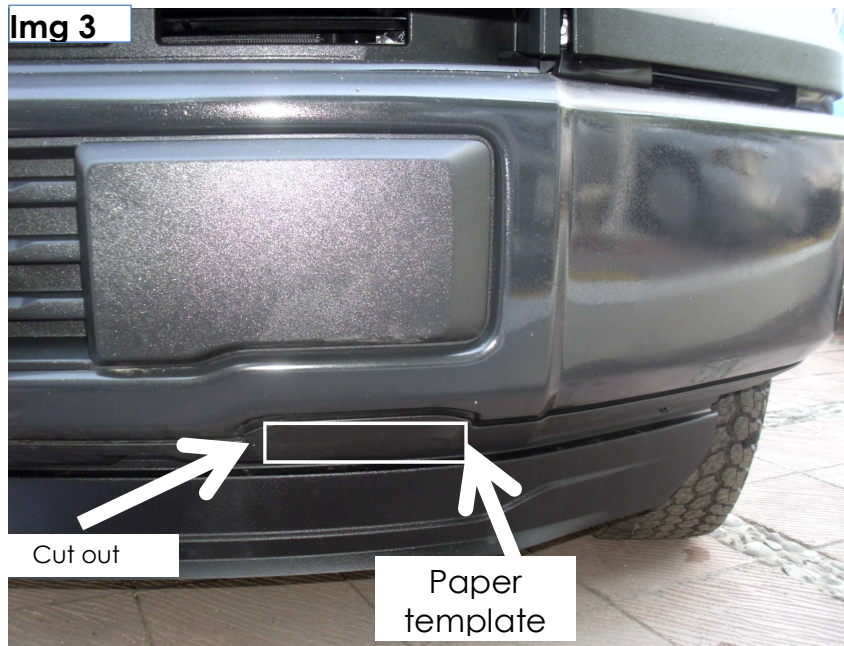

8. Once openings were made, place tab bolts into the frame holes as shown at **Img. 4**. Use the wire guide to place tab bolts.

9. Place lower bracket on the bottom frame surface, fasten using 1/2" flat and lock washers and hex nuts. **Img. 5**.

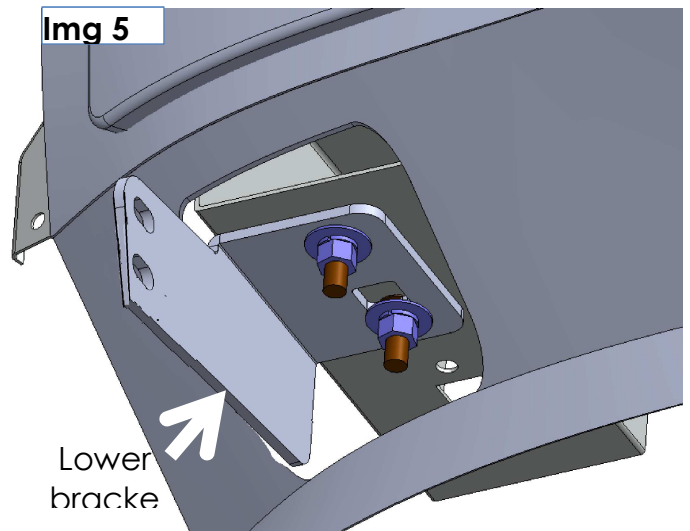
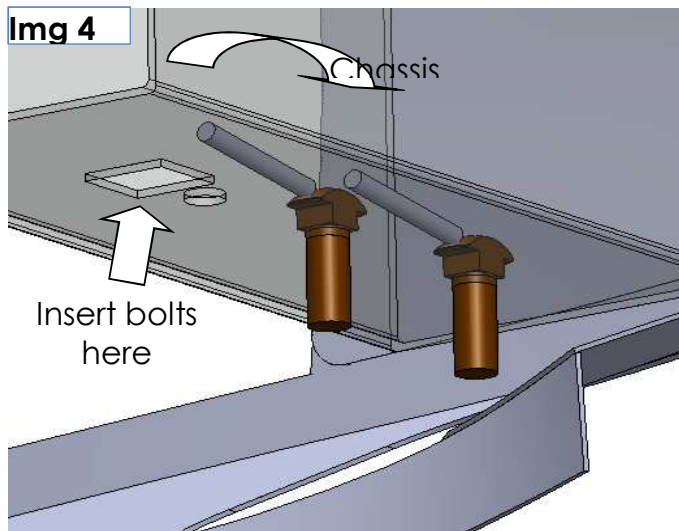

10. Remove the plastic bumper valance and locate the two OEM nuts. Remove them and position the auxiliary bracket and fix it. (Img 6 & 7)

Img 6



Img 7

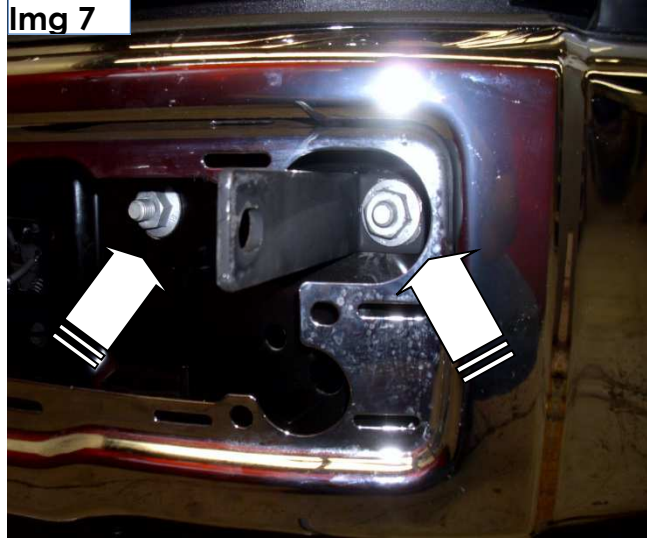

11. After installing the auxiliary bracket cut the plastic front part of the. Bumper valance to allow the proper position. Tighten the nut before putting the bumper valance back. (Img. 8 & 9)

Img 8

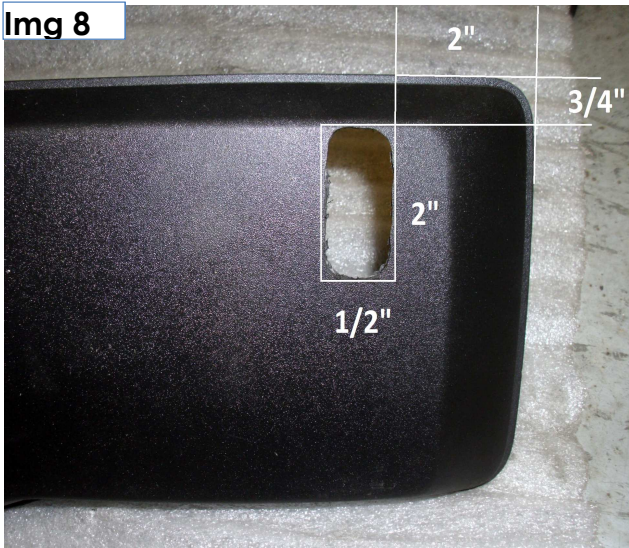

Img 9



12. Install the Pull Pro using eight 1/2"x 1 1/2" carriage bolts, eight 1/2" flat washers, eight 1/2" lock washers and eight 1/2" nuts. **Img 10,**

**Img 10**



**13.** Align the Pull Pro with the front of the vehicle and tighten all bolts and nuts.

**14.** If you got the Pull Pro with the brush guards, fix them to the Pull pro with tree 3/8"x 1 1/4" allen bolts, six flat washers and tree lock nuts. Align the brush guard with the vehicle and tighten all bolts. Repeat for the other side. **Img. 11.**

**Img 11**



Check and re-tighten all bolts and nuts every 6 months.

Fill the warranty card and place it inside your vehicle's glove box.