



**VENGO  
VENTURO**

**INDUSTRIES LLC**

**VC1000 VAN CRANE  
FORD TRANSIT MID/HIGH ROOF**

**VGDAAA  
INSTALLATION & OWNER'S MANUAL**

# Dear Venturo VC1000 Purchaser,

## Thank You!

Thank you for your purchase of the Venturo VC1000 Van Crane. This crane was carefully engineered to provide excellent performance when properly installed, operated and maintained.

Please read this entire manual prior to installing and operating the equipment. It instructs you how to safely and easily install, set up and operate your crane. Please be sure that you, and any other person who will operate the crane, carefully follow the recommended safety practices at all times. Failure to do so could result in personal injury or property damage.

All information in this manual is relative to the most recent product information available at the time of printing. Review this manual for proper installation and to familiarize yourself with the crane's features and operations. We reserve the right to change product specifications, designs and equipment without notice and without incurring obligation.

If you have any problems or questions concerning the VC1000, please call Venco Venturo Industries LLC directly. We want to ensure your complete satisfaction at all times.

Sincerely,

Venco Venturo Industries LLC

## Record Product Information

Before installing, setting up and operating your new crane, please locate the serial plate on the crane and record the information provided to the right. You can locate the serial number plate by looking at where the primary boom connects with the mast at the top. This information will be necessary, should you seek technical support.

**Model:**

---

**Serial Number:**

---

## Product Registration and Customer Support

Please register your product on our website, [www.venturo.com/warranty-policy/](http://www.venturo.com/warranty-policy/).

If you have difficulty assembling this product or have any questions regarding the controls, operation, or maintenance of this crane, you can seek help from our expert customer support. Choose from the options below:

- Visit us on the web at [www.venturo.com](http://www.venturo.com)
  - Download this owner's manual at [www.venturo.com/owner-manuals/](http://www.venturo.com/owner-manuals/)
- Call a Customer Support Representative or Technical Support at (800) 226-2238
- Locate the nearest Venturo Distributor in your area (800) 226-2238 or [info@venturo.com](mailto:info@venturo.com)



VENCO VENTURO INDUSTRIES LLC  
CINCINNATI, OHIO

TITLE

LEAD PAGE

VC1000

DATE

09-12-16

SUPERSEDES

-

SECTION

-

CEV225



# TABLE OF CONTENTS

## VC1000 (VGDAAA) OWNER'S MANUAL; FORD TRANSIT MID/HIGH ROOF ▲

CEV225	LEAD PAGE
<b><u>SECTION 100</u></b>	<b><u>INSTALLATION</u></b>
CEV202	PACKAGE CONTENTS
CEV219	INSTALLATION INSTRUCTIONS; UPPER MOUNTING BRACKET
CEV220	INSTALLATION INSTRUCTIONS; VC1000 CRANE
CEV230	INSTALLATION INSTRUCTIONS; VC1000 CRANE, CONT.
CEV221	INSTALLATION INSTRUCTIONS; ROTATION STOP RELEASE CABLE
CEV222	ELECTRICAL INSTALLATION INSTRUCTIONS
CEV223	BATTERY CABLE INSTALLATION
CEV218	WIRING DIAGRAM
<b><u>SECTION 200</u></b>	<b><u>USER GUIDE</u></b>
CE-044	CRANE SAFETY AND HAZARDS
CEV203	OPERATING INSTRUCTIONS
CEV212	OPERATING INSTRUCTIONS & MAINTENANCE
CEV226	USER INSTRUCTIONS
CEV227	USER INSTRUCTIONS, CONT.
<b><u>SECTION 300</u></b>	<b><u>SPECIFICATIONS</u></b>
CEV201	DIMENSIONS & CAPACITY
CEV162	WIRE ROPE & HOOK SPECIFICATIONS
<b><u>SECTION 400</u></b>	<b><u>REPLACEMENT PARTS</u></b>
CEV204	REPLACEMENT PARTS DRAWING
CEV205	REPLACEMENT PARTS LIST
CEV208	REPLACEMENT HARDWARE DRAWING
CEV209	REPLACEMENT HARDWARE LIST
CE-055	REPLACEMENT PARTS DRAWING & LIST; WINCH
CEV224	REPLACEMENT PARTS DIAGRAM; CE-008 CONTACTOR BOX
CEV170	SAFETY DECALS
CEV171	SAFETY DECALS
CEV207	DECAL DRAWINGS & LIST
CEV206	DECAL LOCATIONS
CEV217	KIT; CEV216 FIELD SERVICE LABELS



VENCO VENTURO INDUSTRIES LLC  
CINCINNATI, OHIO

TITLE	DATE	SECTION
TABLE OF CONTENTS	01-05-17D	TOC
VC1000 (VGDAAA) ▲	SUPERSEDES 09-29-16C	<b>CEV200</b>



# SECTION 100

# INSTALLATION

**PACKAGE CONTENTS**  
VC1000 (VGDAAA); FORD TRANSIT MID/HIGH ROOF

The VC1000 Van Crane will ship with some sections pre-assembled from the factory. Below are illustrations to help identify sections of the Van Crane and Installation Kit components.

**VC1000 VAN CRANE SECTIONS**

Locate and identify the following crane sections:

1. Upper Mounting Bracket / Bearing subassembly
2. Upper Mast / Secondary Boom subassembly
3. Lower Mast / Rotation Stop Pin subassembly
4. Lower Mounting Bracket / Bearing / Detent Plate subassembly
5. Jack Leg Welded Assembly

NOTE: Some fasteners are located in the installation kit.

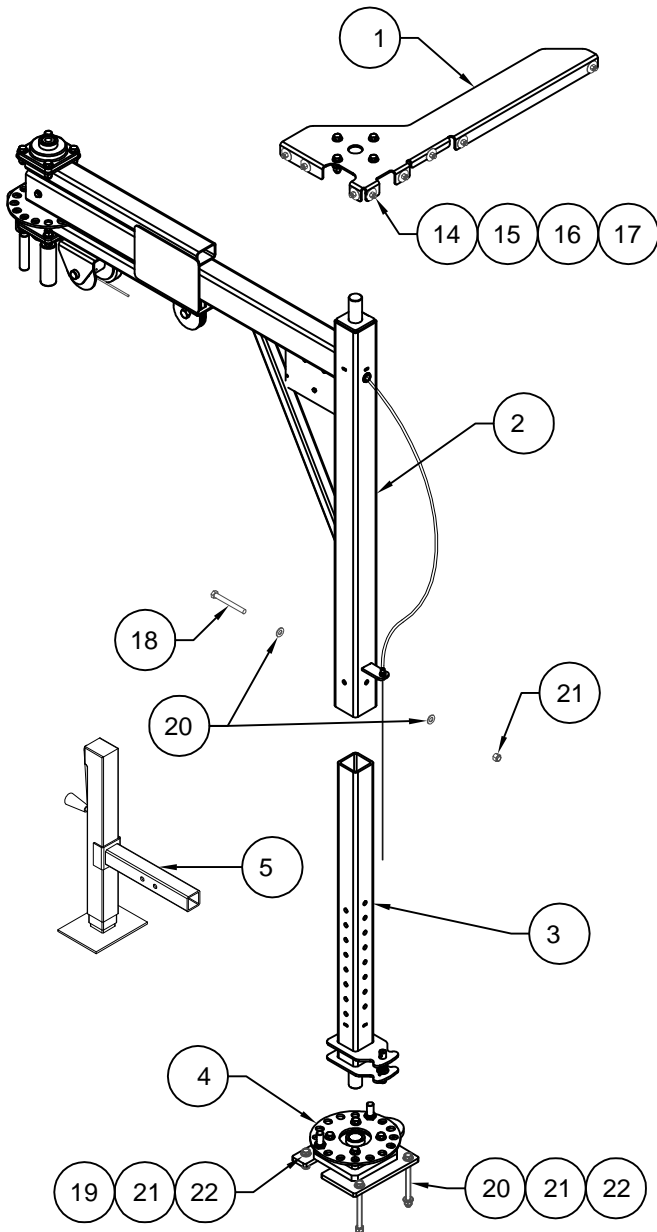

**CEV213 INSTALLATION KIT**

Locate and identify the following components:

- † 6. [1] Installation Kit Box (#BOX18\*12\*6)
7. [1] Red Battery Cable (#01025-4\*29FT)
8. [1] Black Battery Cable (#01025-4\*28FT)
9. [2] 5/16 Terminal Ring (#!TERM4G313RG)
10. [2] 3/8 Terminal Ring (#!TERM4G375RG)
11. [1] Master Disconnect Switch (#13451)
12. [1] Switch Mounting Bracket (#19516)
13. [1] Headache Ball Assembly (#16735)

**FASTENER PACKETS**

14. [8] 3/8-16X1" Hex Head Cap Screws (!HHCS03816100)
15. [8] 3/8" SAE Flat Washers (!FWSH-038SAE)
16. [8] 3/8" Fender Washers (!FWSH-038F)
17. [8] 3/8-16 Nyloc Nuts (!LNUT-03816)
18. [1] 1/2-13X4-1/2" Hex Head Cap Screws (!HHCS05013450)
19. [2] 1/2-13X2" Hex Head Cap Screws (!HHCS05013200)
20. [2] 1/2-13X6-1/2" Hex Head Cap Screws (!HHCS05013650-5)
21. [10] 1/2" Flat Washers (!FWSH-050)
22. [5] 1/2-13 Nyloc Nuts (!LNUT-05013)

**OPTIONAL EQUIPMENT**

23. [1] 150A CIRCUIT BREAKER (#22946-150)

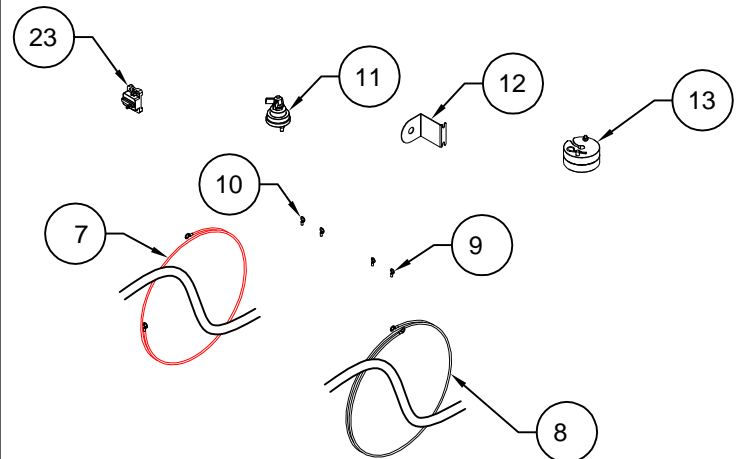

† NOT SHOWN



VENCO VENTURO INDUSTRIES LLC  
CINCINNATI, OHIO

TITLE  
**PACKAGE CONTENTS**

VC1000 (VGDAAA)

DATE  
**01-23-17D**

SUPERSEDES  
01-05-17C

SECTION  
**C100**

**CEV202**

THE VC1000 VAN CRANE IS DESIGNED TO BE INSTALLED IN THE RIGHT REAR CORNER OF THE VAN. THE MOUNTING KIT CONTAINS ALL NECESSARY HARDWARE FOR A COMPLETE INSTALLATION.

**! C A U T I O N**

- 1,000 LBS CAPACITY IS BASED UPON VAN STRUCTURAL LIMITATIONS, NOT WINCH CAPACITY. IT IS THE OPERATOR'S RESPONSIBILITY NOT TO EXCEED THE CAPACITY OF THE VAN STRUCTURE.



USING THE UPPER MOUNTING BRACKET (#23338) AS A TEMPLATE, HOLD IT LEVEL IN PLACE IN THE UPPER RIGHT HAND CORNER (PASSENGER SIDE) OF THE VAN BODY AND MARK THE HOLE LOCATIONS.



**! W A R N I N G**

- PRIOR TO DRILLING HOLES, CHECK FOR WIRING HARNESSSES ETC., BEING CAREFUL NOT TO DRILL THROUGH OUTER SKIN
- BEWARE OF SHARP EDGES

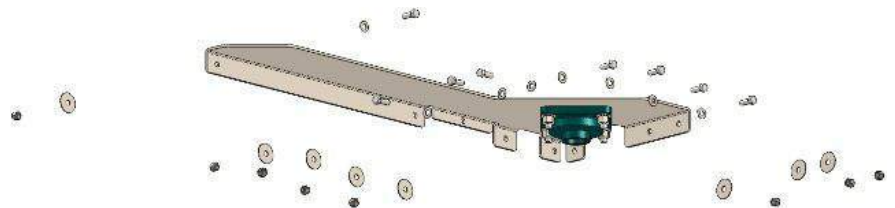

DRILL HOLES FOR [8] 3/8-16 X 1" HEX HEAD CAP SCREWS. USING [8] 3/8" SAE FLAT WASHERS, [8] 3/8" SAE FENDER WASHERS AND [8] 3/8-16 NYLOC NUTS, BOLT THE UPPER MOUNTING BRACKET INTO PLACE.



VENCO VENTURO INDUSTRIES LLC  
 CINCINNATI, OHIO

TITLE  
 INSTALL. INSTRUCTIONS

DATE  
 01-23-17B

SECTION  
 C100

VC1000 (VGDAAA)

SUPERSEDES  
 01-05-17A

CEV219



**READ ALL INSTRUCTIONS FIRST BEFORE PERFORMING INSTALLATION**

1. Slide Lower Mast into upper structure and leave loose (see figure 2). Install Lower Mount (making sure it is oriented correctly) onto the lower pivot shaft located at the bottom of the lower structure (see figure 3).

**! WARNING**

- WEIGHT OF ASSEMBLY IS APPROXIMATELY 275 LBS. ADDITIONAL HELP WILL BE REQUIRED TO PERFORM THE NEXT STEP

2. Carefully lift the assembly into the van, and position the upper mast pivot shaft into the upper mounting bracket bearing (see figure 4). Insert the 1/2-13 X 4-1/2" center mast bolt through center area of mast to lock the adjustable mast to the proper height.

NOTE:  
 The upper mast plate must be within 1" of the bottom of the upper bearing (see figure 5).

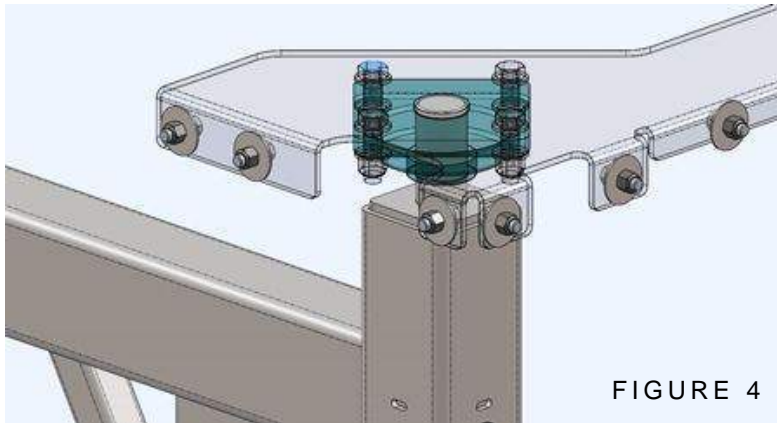
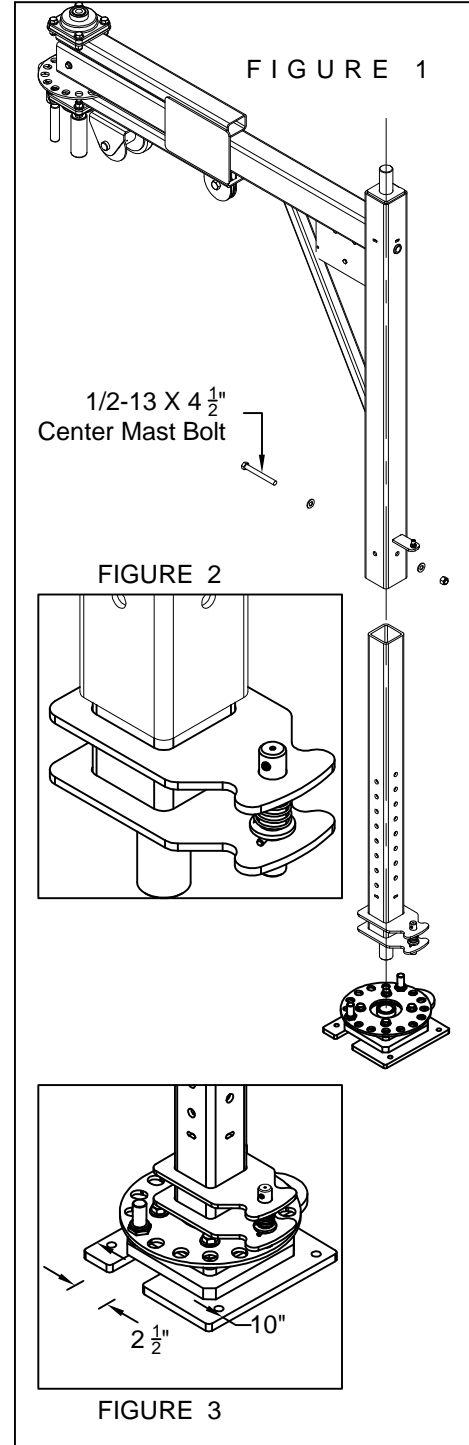

FIGURE 4

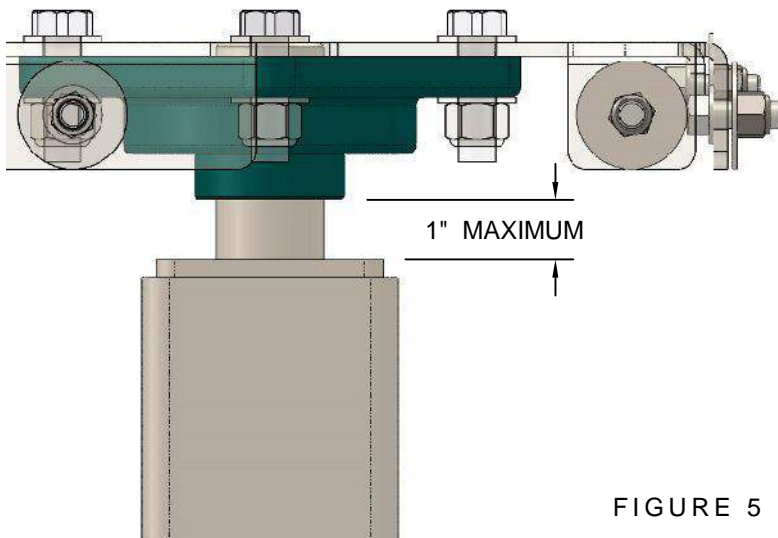

FIGURE 5



VENCO VENTURO INDUSTRIES LLC  
 CINCINNATI, OHIO

TITLE  
**INSTALL. INSTRUCTIONS**  
 VC1000 (VGDAAA)

DATE  
**01-23-17B**  
 SUPERSEDES  
 01-05-17A

SECTION  
**C100**  
**CEV220**



INSTALLATION INSTRUCTIONS  
VC1000 (VGDAAA); FORD TRANSIT MID/HIGH ROOF

3. Moving the lower mount, position the crane so the mast is 90° with the floor of the van in at least two perpendicular directions (see figure 6). Once mast is squared with the floor, locate and mark the mounting holes of the base mount.



# C A U T I O N

- IF LOWER MOUNT IS NOT INSTALLED IN LINE WITH UPPER MOUNT, INTERFERENCE MAY OCCUR BETWEEN THE BOOM AND THE VEHICLE'S DOOR FRAME - THE MAST MUST BE 90° TO THE FLOOR OF THE VAN
- PRIOR TO DRILLING, MAKE SURE THERE ARE NO OBSTACLES UNDER THE FLOOR (i.e. BRAKE LINES, FUEL LINES, ETC.)

Drill the [4] 1/2" clearance holes through the van floor. Two of the holes will go through the floor only, and two will go through the floor and structural channel below the floor.

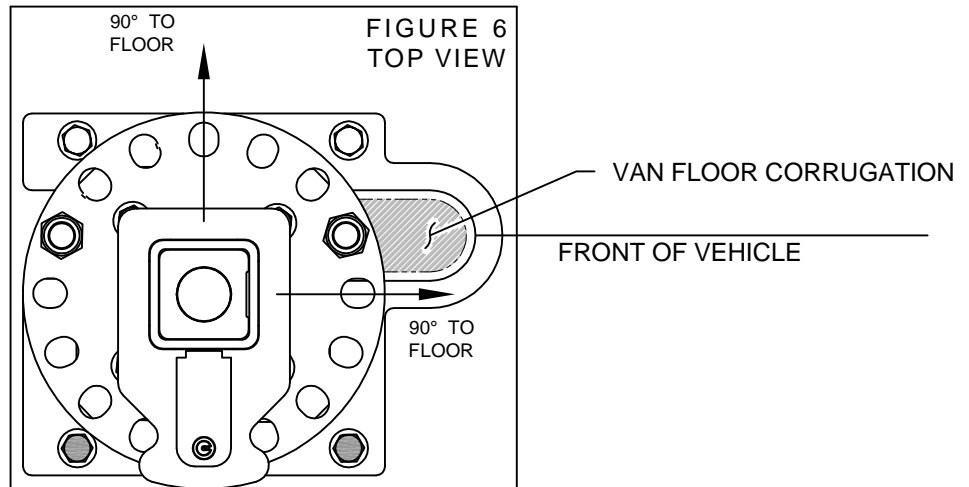

4. Once holes are drilled, align the mounting base with the holes and install mounting hardware. ▲

NOTE:  
There will be two long bolts to go through the floor and channel and two short bolts to go through the floor only. Secure these mounting bolts along with the center mast bolt.

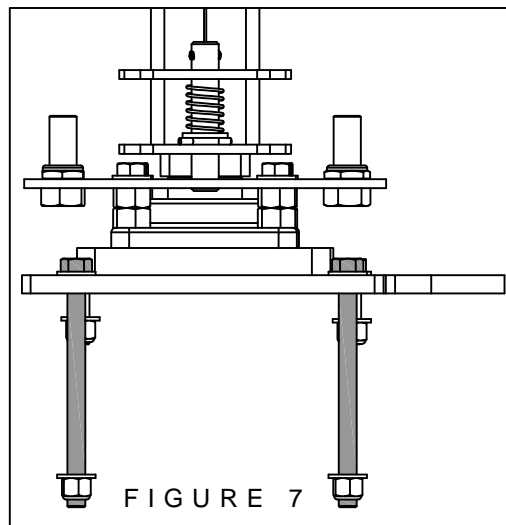

VENCO VENTURO INDUSTRIES LLC  
CINCINNATI, OHIO

TITLE  
INSTALL. INSTRUCTIONS

DATE  
01-23-17C

SECTION  
C100

VC1000 (VGDAAA)

SUPERSEDES  
01-05-17B

CEV230

**INSTALLATION INSTRUCTIONS**  
**VC1000 (VGDAAA); FORD TRANSIT MID/HIGH ROOF**

Once the crane is installed in the van, the rotation stop release cable must be cut to the proper length.

5. Ensure that the Rotation Stop Release Adjustable Conduit Retainer (#23366) at the bottom of the Rotation Stop Cable Conduit (#23364) is adjusted to its lowest position (see figure 8).

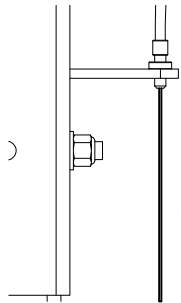
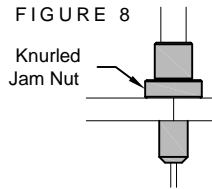
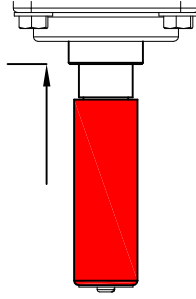

FIGURE 9

6. Pull the Rotation Stop Release Cable (#23365) downward away from the Rotation Stop Release Adjustable Conduit Retainer (#23364) (see figure 9) until the Red Handle Grip (#23337) is pulled all the way up to its top position (see figure 10).

FIGURE 10



7. With the handle still in the top position, hold the cable next to the Rotation Stop Pin (#23343) and cut the cable near the bottom of the pin (see figure 11).

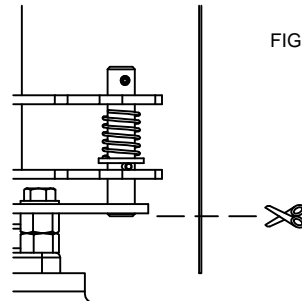

FIGURE 11

8. With the handle still in the top position, feed cable through the stop pin and gently screw one of the set screws in until it touches the cable. This will center the cable between the set screws.

9. Gently tighten the opposing set screw until it pinches the cable with enough force to prevent the cable from slipping when the release handle is pulled. Do not over tighten the screws as the cable can be damaged (see figure 12).

10. Ensure that the cable can pull the rotation stop pin up far enough to clear the stop pin disk and allow rotation of the crane mast. The conduit retainer can be unscrewed to increase the travel of the stop pin until it clears the stop disk. Ensure that the knurled jam nut is tightened down once the adjustment is set.

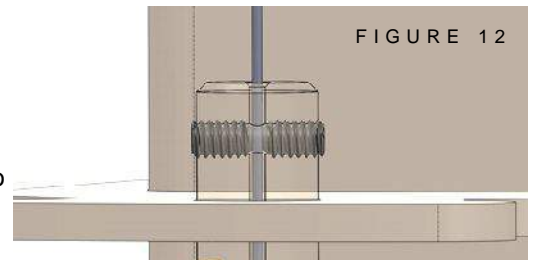
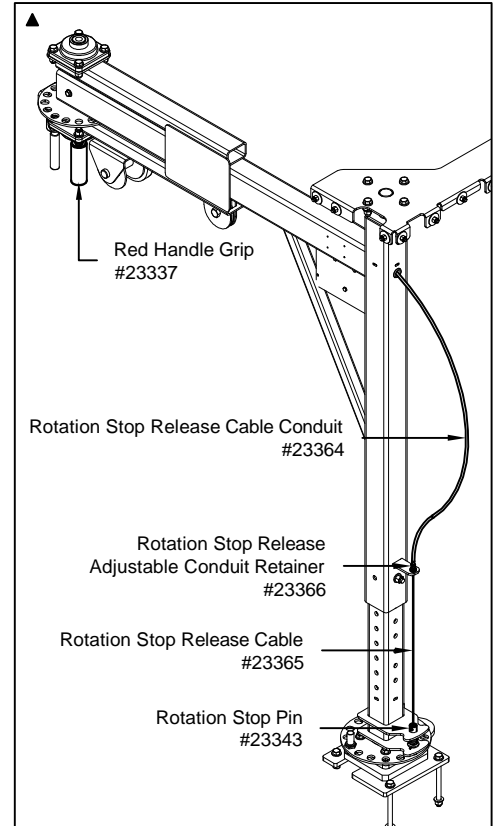

FIGURE 12

**NOTES:**

Do not cut the cable until the crane is installed in the van and it is determined that the crane mast is fully extended as far as possible into the upper bearing. This height can vary from one installation to another, requiring each installation to have a slightly different cable length.

Do not cut the cable too short. It is better to leave the cable as long as possible provided it does not extend below the bottom of the rotation stop pin.

Over tightening the set screws can damage or cut the cable. The set screws need only be tight enough to overcome the force of the spring on the rotation stop.

It may be necessary to lift the stop pin slightly when tightening the set screws to allow the cable to provide enough travel to fully disengage the stop pin before the release handle reaches the end of its travel.



VENCO VENTURO INDUSTRIES LLC  
 CINCINNATI, OHIO

TITLE	INSTALL. INSTRUCTIONS
	VC1000 (VGDAAA)

DATE	01-23-17B	SECTION	C100 ▲
SUPERSEDES	01-05-17A		CEV221

**INSTALLATION INSTRUCTIONS (ELECTRICAL)**  
**VC1000 SERIES VAN CRANES** ▲

Using the [2] battery cables in the kit (provided), install the ground (black) and 12V (red) to the crane's contactor box per drawing CEV223.

Install the master disconnect switch close to the crane and within reach of the operator. Using the red battery cable, route the cable to the disconnect switch. The cable will need to be cut to length. Strip both ends of cable, install the heat shrink tube and the battery terminal (provided). Crimp or solder the terminals on each end and slide the heat shrink insulator up onto the terminal. Use a heat gun or equivalent to seal the tube to the cable.

Connect the crane side of the cable to the master disconnect switch and the other cable's end to the second terminal on the switch.

**NOTE:** Both ground and 12v cables must be routed directly to the battery (not included).

Route cables using the vehicles current harness path. Secure both cables to the battery, while protecting them from sharp edges, heat or anything that could damage the cables. Install the black cable to the negative (-) post and red cable to the positive (+) post. ▲

**NOTE:** If you purchased the optional 12v 150 amp circuit breaker, install the circuit breaker as close to the battery as possible. The red 12v cable will need to be cut and the heat shrink & terminals installed in the same manner as the master disconnect switch.

Plug the pendant into the contactor box and turn the master disconnect switch 'ON'. Crane is ready for use. When crane is not in use, the master disconnect switch must be 'OFF' and the pendant removed.

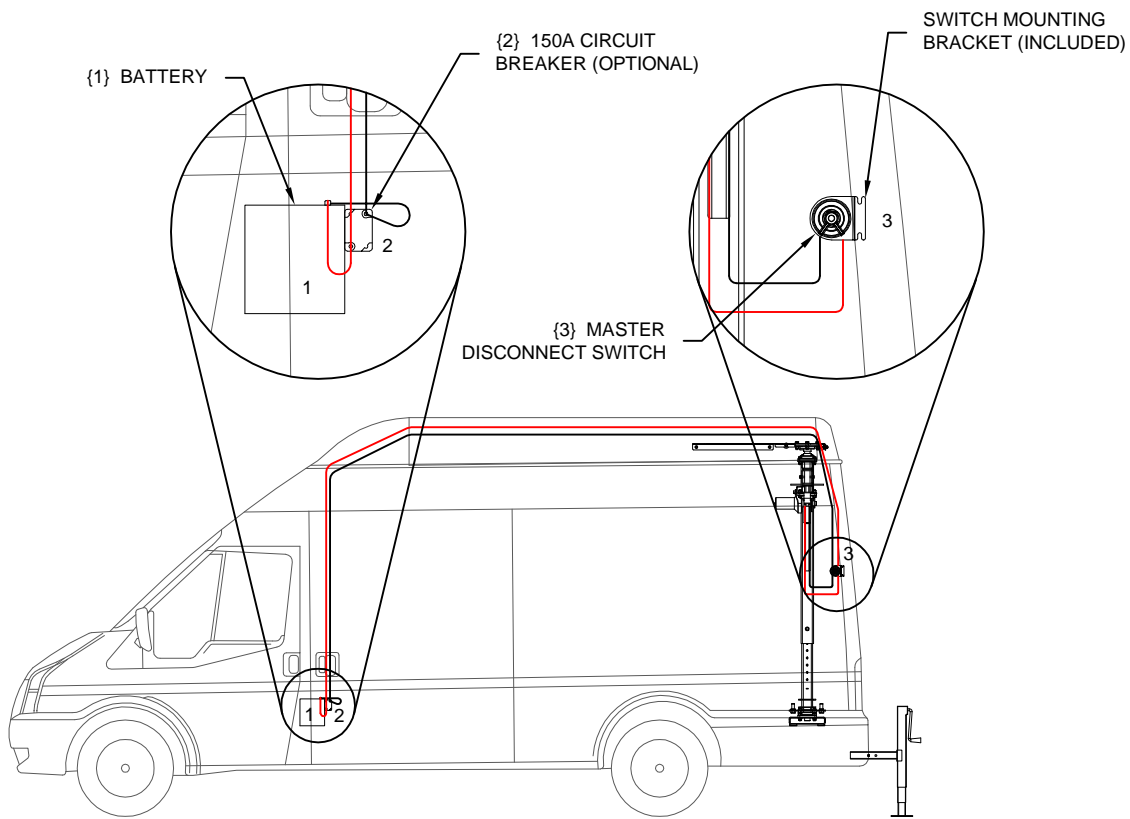
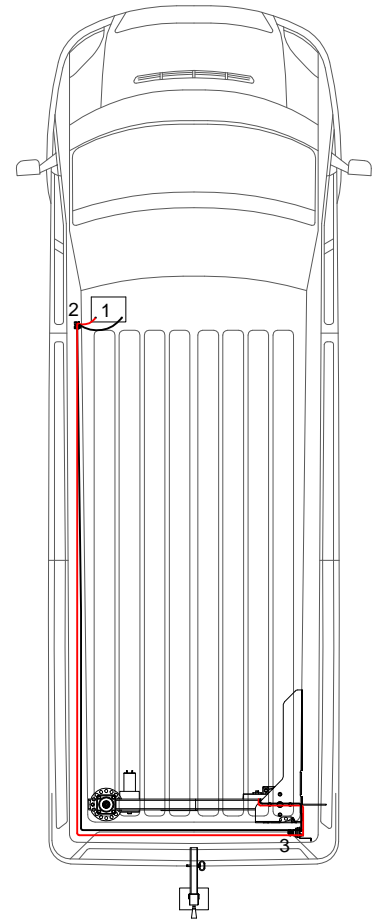

ILLUSTRATIONS ARE FOR REFERENCE ONLY ▲

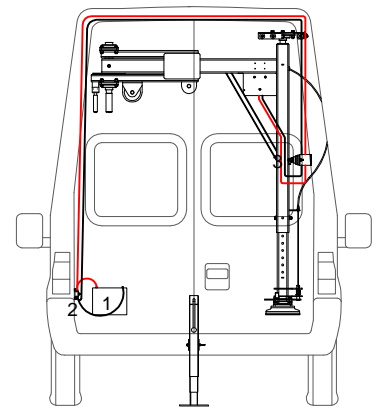

VENCO VENTURO INDUSTRIES LLC  
 CINCINNATI, OHIO

TITLE  
**ELEC. INSTALL. INSTRCTNS**  
 ▲  
**VC1000 SERIES VAN CRANES**

DATE  
**01-26-17C**  
 SUPERSEDES  
**01-23-17B**

SECTION  
**C100**  
**CEV222**



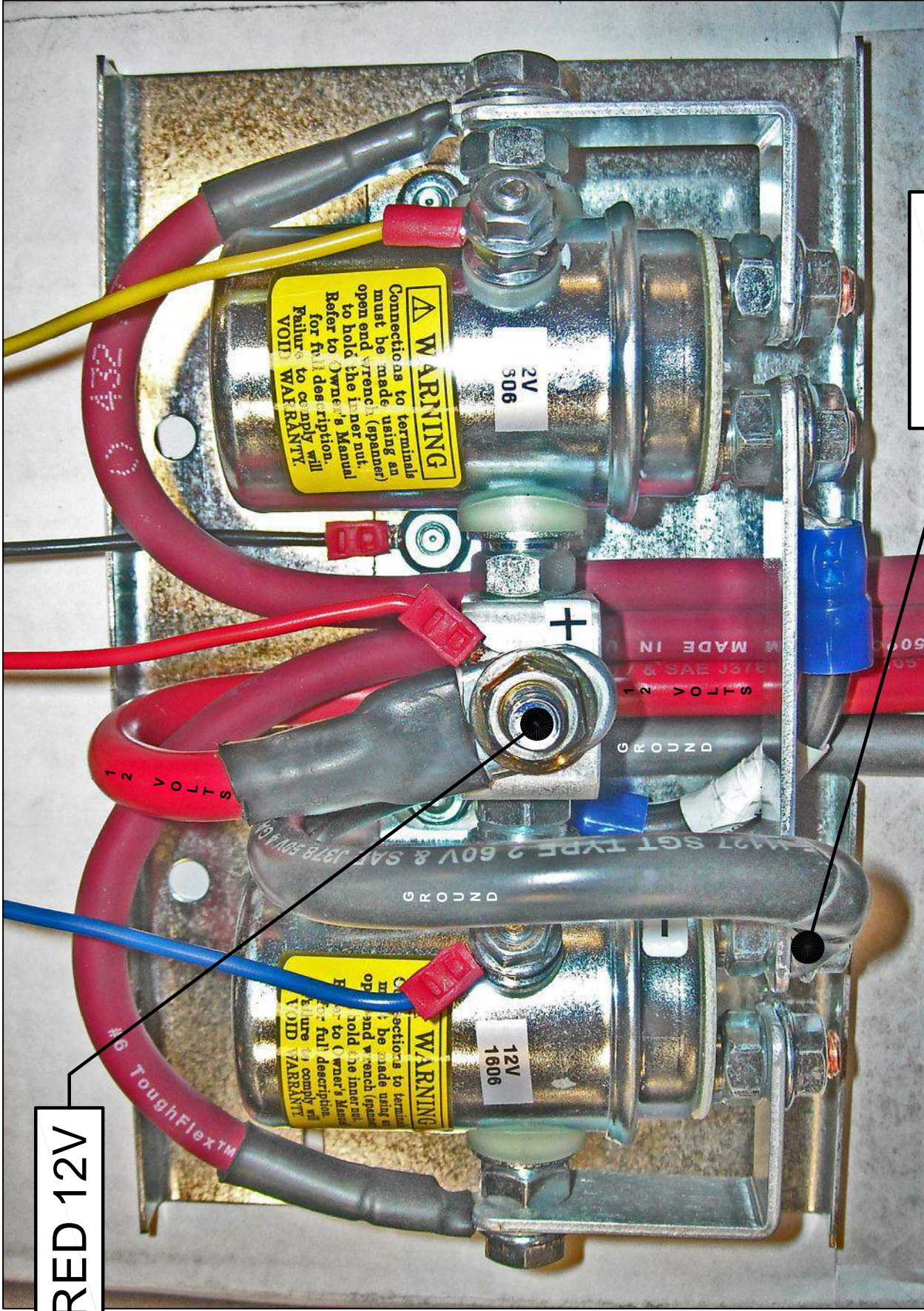

GROUND

RED 12V

TITLE	DATE	SECTION
BATTERY CABLE INSTALLATION	08-30-16	C100
CE-008 CONTACTOR BOX	SUPERSEDES	CEV223
	-	

**VENTURO**<sup>®</sup> VENCO VENTURO INDUSTRIES LLC  
CINCINNATI, OHIO



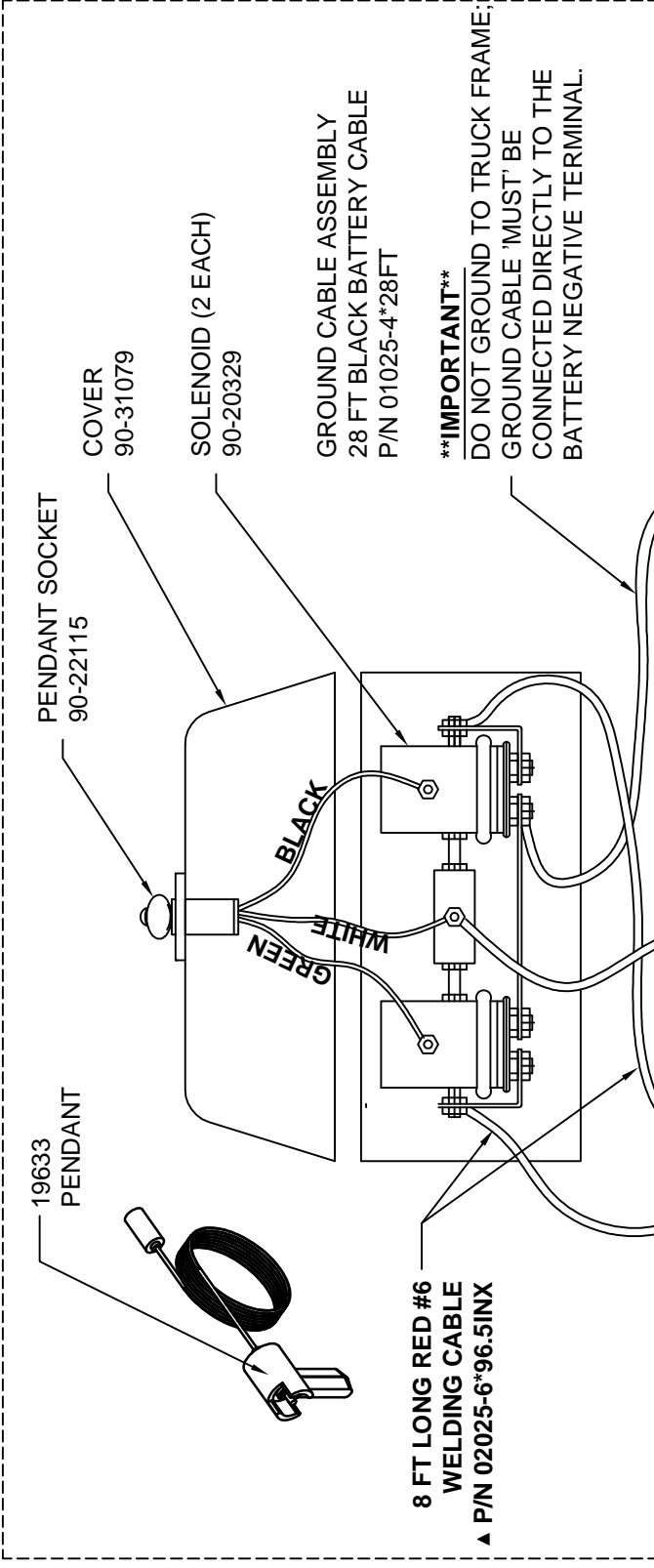

19633  
PENDANT

PENDANT SOCKET  
90-22115

COVER  
90-31079

SOLENOID (2 EACH)  
90-20329

GROUND CABLE ASSEMBLY  
28 FT BLACK BATTERY CABLE  
P/N 01025-4\*28FT

**\*\*IMPORTANT\*\***  
DO NOT GROUND TO TRUCK FRAME;  
GROUND CABLE 'MUST' BE  
CONNECTED DIRECTLY TO THE  
BATTERY NEGATIVE TERMINAL.

8 FT LONG RED #6  
WELDING CABLE  
▲ P/N 02025-6\*96.5INX

OPTIONAL 150 AMP CIRCUIT BREAKER  
w/ MANUAL TRIP & RESET FEATURE  
P/N 22946-150

**\*\*IMPORTANT\*\***  
THE INSTALLER 'MUST' LOCATE THE  
CIRCUIT BREAKER AS CLOSE TO THE  
BATTERY AS IS PRACTICAL.

POWER CABLE ASSEMBLY  
29 FT OF RED BATTERY CABLE  
P/N 01025-4\*29FT

NOTE: 29 FT OF #4 RED BATTERY  
CABLE w/ 3/8" RINGS ON EACH END  
IS PROVIDED.

THE INSTALLER WILL NEED TO  
DETERMINE 'WHERE' TO CUT THE  
BATTERY CABLE TO INSTALL THE  
MASTER DISCONNECT SWITCH AND  
CIRCUIT BREAKER.

MASTER DISCONNECT SWITCH  
P/N 13451

12 VOLT  
BATTERY

WINCH  
MOTOR

 <p>VENTURO® VENCO VENTURO INDUSTRIES LLC CINCINNATI, OHIO</p>	TITLE	SECTION	
	<p>VC1000</p> <p>WIRING DIAGRAM</p>	<p>01-23-17D</p> <p>C100</p>	<p>DATE</p> <p>01-23-17D</p>
	<p>VC1000</p> <p>WIRING DIAGRAM</p>	<p>08-25-16B</p> <p>CEV218</p>	<p>SUPERSEDES</p> <p>08-25-16B</p>



# SECTION 200

# USER GUIDE



**CAUTIONS**

1. INSPECT VEHICLE AND CRANE, INCLUDING OPERATION, PRIOR TO USE DAILY.
2. DO NOT USE THIS EQUIPMENT EXCEPT ON SOLID, LEVEL SURFACE WITH CRANE MOUNTED ON FACTORY RECOMMENDED TRUCK.
3. BEFORE OPERATING THE CRANE, REFER TO MAXIMUM LOAD (CAPACITY) CHART ON CRANE FOR OPERATING (LOAD) LIMITATIONS.
4. DO NOT OPERATE, WALK, OR STAND BENEATH BOOM OR A SUSPENDED LOAD.
5. UNPLUG PENDANT (AND OPTIONAL ELECTRIC QUICK DISCONNECT, IF ON MODEL) WHEN NOT IN USE.
6. FOR TRAVEL, BOOM MUST BE TIED DOWN IN THE STOWED POSITION.

**DANGER**

- THIS CRANE IS NOT A PASSENGER LIFT
- IT IS NOT DESIGNED OR INTENDED TO BE USED TO LIFT, SUPPORT, OR OTHERWISE TRANSPORT PERSONNEL.

**YOU MUST NOT OPERATE THIS CRANE UNLESS :**

1. YOU HAVE BEEN TRAINED IN THE SAFE OPERATION OF THIS CRANE, **AND**
2. YOU KNOW AND FOLLOW THE SAFETY AND OPERATION RECOMMENDATIONS CONTAINED IN THE MANUFACTURER'S MANUALS, YOUR EMPLOYER'S WORK RULES, AND APPLICABLE GOVERNMENT REGULATIONS. AN UNTRAINED OPERATOR SUBJECTS THEMSELVES AND OTHERS TO DEATH OR SERIOUS INJURY.

REFERENCE SAFETY MANUAL INST-23233



VENCO VENTURO INDUSTRIES LLC  
CINCINNATI, OHIO

TITLE	DATE	SECTION
CRANE SAFETY & HZRDS	02-20-17E	C200
▲ CE-/CEV/ESV SERIES CRANES	SUPERSEDES 09-08-16D	CE-044

# OPERATING INSTRUCTIONS

## ELECTRIC WINCH

The winch is operated by a control switch in a plug-in remote pendant. Unplug the pendant and store it in the vehicle when the crane is not in use.

## ROTATION LOCK

Before lifting a load, make sure the brake handle is tightened to keep boom from rotating (do not pull items at an angle. The load hook must be centered over the load.)



# C A U T I O N

- BOOM MUST BE FOLDED AND SECURED (STOWED POSITION) BEFORE DRIVING VEHICLE. DO NOT DRIVE WITH BOOM EXTENDED OUT.

## BOOM ARTICULATION

The following illustrates how to articulate the boom.

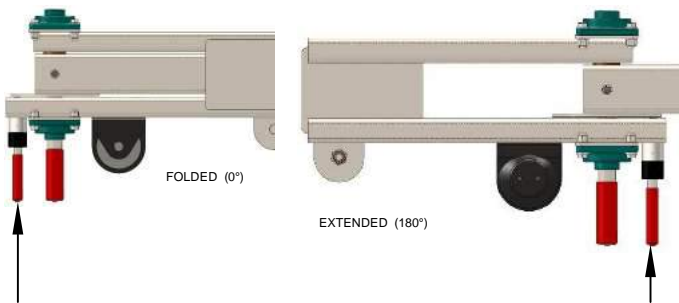

To rotate the boom, pull the smaller lever until pin is clear of slots. Manually rotate the boom to desired position and release smaller lever, making sure the pin retracts into one of the slots. This will keep the boom from rotating.

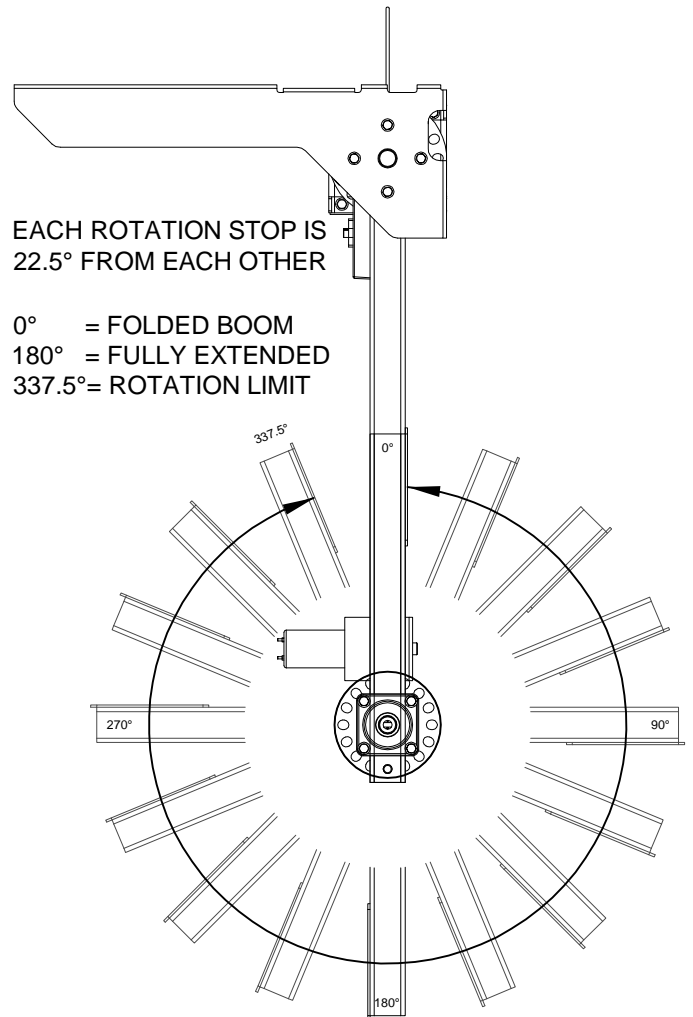

VENCO VENTURO INDUSTRIES LLC  
CINCINNATI, OHIO

TITLE

OPER. INSTR. & MNTNCE

DATE

01-27-17C

SECTION

C200

VC1000 SERIES VAN CRANES

SUPERSEDES

09-08-16B

CEV203

## OPERATING INSTRUCTIONS

### JACK LEG

Stowed Jack Leg must be secured inside van.



## C A U T I O N

- JACK LEG MUST BE REMOVED FROM RECEIVER AND STOWED PRIOR TO OPERATING THE VEHICLE.



## W A R N I N G

- THE MASTER DISCONNECT SWITCH ISOLATES ELECTRICAL POWER FROM THE CRANE AND MUST BE SWITCHED OFF ANYTIME THE CRANE IS NOT IN USE..

### OPTIONAL CIRCUIT BREAKER

An optional 150amp circuit breaker (#22964-150) is available. The circuit breaker should be placed between the lead-acid battery supply and the crane; ***as close as practical to the lead-acid battery.***

## MAINTENANCE

### WINCH

The winch is permanently lubricated. There may be grease leakage out of the winch, especially during the first few operations. This is normal and it is not necessary to grease or oil any part of the winch at any time.

### WIRE ROPE

Inspect wire rope periodically. If any wear or fraying exists, replace wire rope.



VENCO VENTURO INDUSTRIES LLC  
CINCINNATI, OHIO

TITLE

OPER. INSTR. & MNTNCE

VC1000

DATE

09-08-16

SUPERSEDES

-

SECTION

C200

CEV212

USER GUIDE  
VC1000 SERIES VAN CRANES ▲

- Prior to using crane, read all operator instructions and Safety Manual
- Make sure you are familiar with all of the controls, functions, and locking mechanisms
- Read and adhere to all safety placards that are installed on the crane and the vehicle
- Since the manufacturer has no direct control over the crane application and operation, conformance with good safety practices is the responsibility of the operator
- The van and crane are to be positioned on firm level surfaces with the Jack Leg (if equipped) always set and the chassis brake engaged

1. Install Jack Leg (provided) into receiver and adjust as needed



1

2. Plug control pendant into socket located on the crane

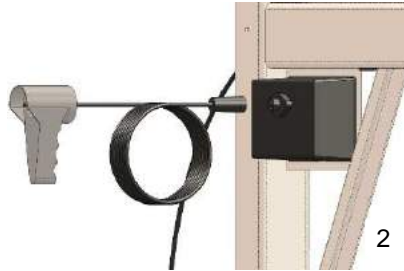

2

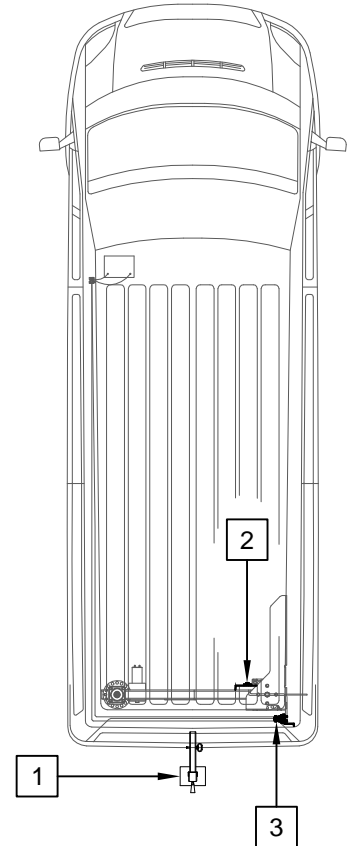

3. Turn Master Disconnect Switch to the 'ON' position

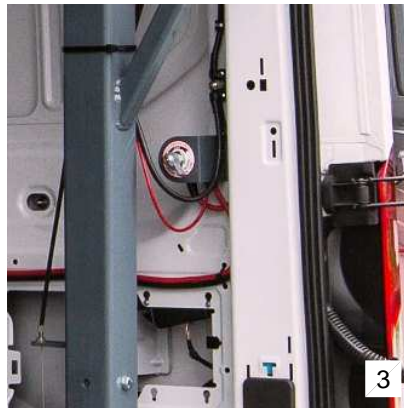

3

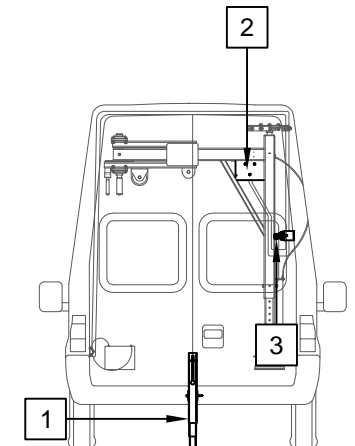

VENCO VENTURO INDUSTRIES LLC  
CINCINNATI, OHIO

TITLE	DATE	SECTION
USER INSTRUCTIONS	01-27-17C	C200
VC1000 SERIES VAN CRANES ▲	SUPERSEDES	
	01-23-17B	CEV226

USER GUIDE  
VC1000 SERIES VAN CRANES ▲

- Make sure you are familiar with all of the controls, functions, and locking mechanisms
- Always rotate the crane or boom individually, never at the same time
- Whenever possible, always rotate the crane or boom by 'pushing' away from you
- Always use proper rigging hardware and slings

4. Pull the main mast lock release down (larger handle), swing crane into position, and release handle to lock in position.

5. Pull the articulating boom lock down (smaller handle) to precisely center load hook over load.

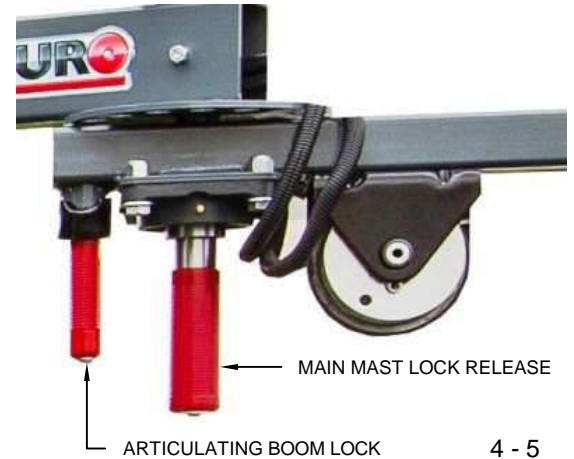

6. Using the pendant, lower hook to the load and attach to the proper rigging hardware and / or sling(s).

7. Carefully raise the load so it will clear the van floor.



8. Using caution, release lock on main mast and guide load into van. Unlocking one lock at a time will give you more control in handling the load.

9. Unhook the load and stow the hook. Reposition the crane into the stowed position for travel, and secure the load.

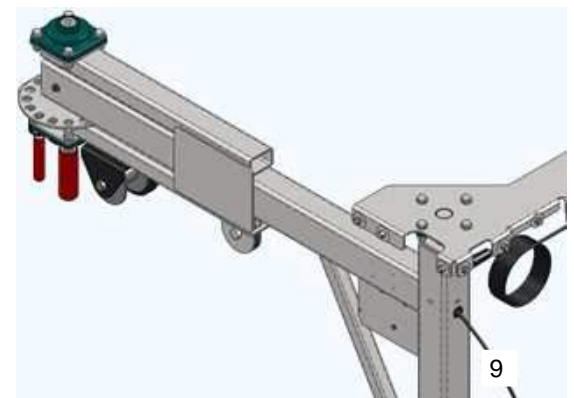

10. Remove the Jack Leg and stow in a secure position.



VENCO VENTURO INDUSTRIES LLC  
CINCINNATI, OHIO

TITLE  
USER INSTRUCTIONS

DATE  
01-27-17C

SECTION  
C200

VC1000 SERIES VAN CRANES ▲

SUPERSEDES  
01-23-17B

CEV227



# SECTION 300

# SPECIFICATIONS



# CAUTION

- 1000 LBS MAXIMUM CAPACITY IS BASED UPON TYPICAL VAN FLOOR STRUCTURE LIMITATIONS, NOT WINCH CAPACITY. IT IS THE SOLE RESPONSIBILITY OF THE INSTALLER TO DETERMINE IF ADDITIONAL FLOOR REINFORCEMENT IS NECESSARY.

# WARNING

- THESE PRODUCTS ARE NOT PASSENGER LIFTS. THEY ARE NOT DESIGNED OR INTENDED TO BE USED TO LIFT, SUPPORT OR OTHERWISE TRANSPORT PERSONNEL.

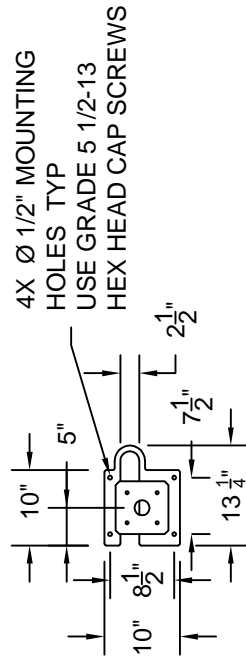
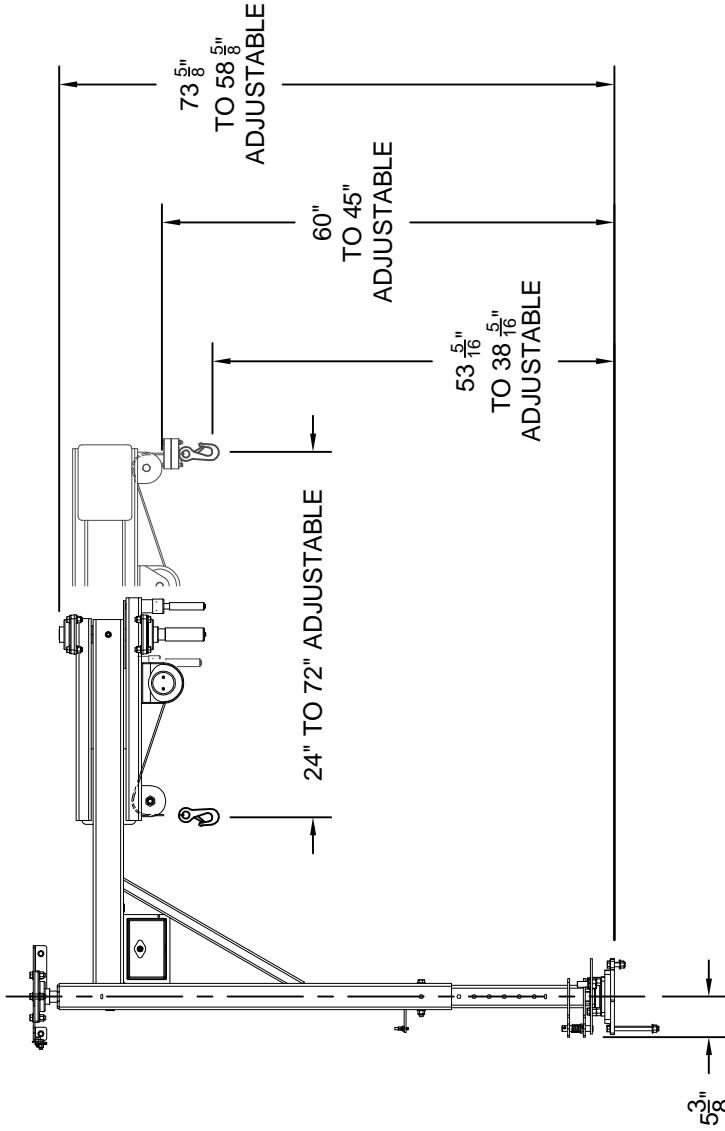
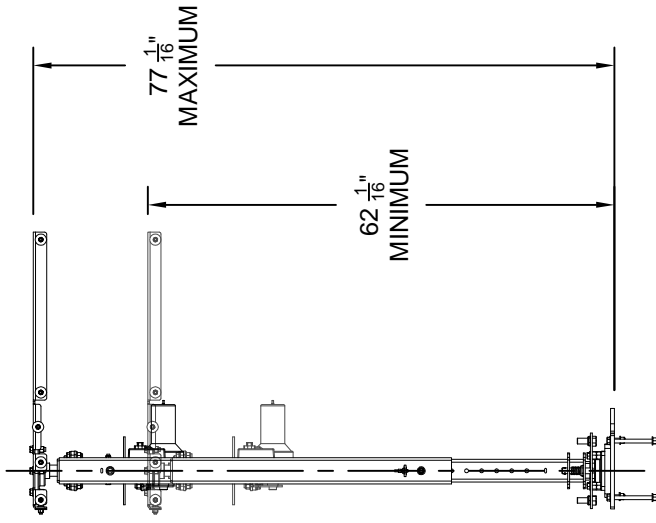

BASE MOUNT DIMENSIONS

4X Ø 1/2" MOUNTING HOLES TYP  
USE GRADE 5 1/2-13 HEX HEAD CAP SCREWS

TITLE  
**DIMENSIONS & CAPACITY**

VC1000 (VGDAAA)

DATE  
01-23-17C

SUPERSEDES  
01-06-17B

SECTION  
C300

CEV201

VENCO VENTURO INDUSTRIES LLC  
CINCINNATI, OHIO



# 15810-3/16-25 WIREROPE ASSEMBLY

TYPE: 3/16" DIAMETER  
 7 x 19, GALVANIZED  
 (GAC 7X19 LHRL-IWRC, SB 4200)  
 LENGTH: 25'

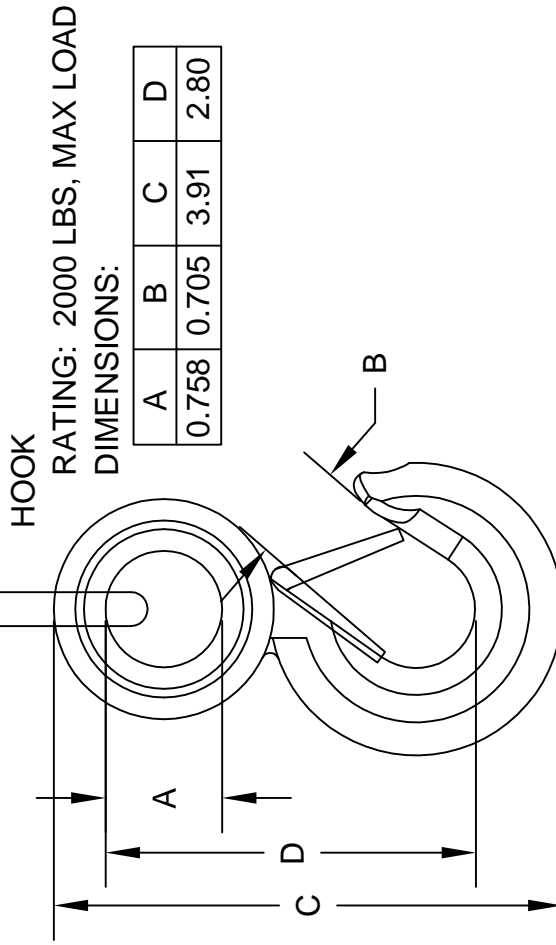

VENCO VENTURO INDUSTRIES LLC  
 CINCINNATI, OHIO

TITLE  
**WIREROPE & HOOK SPECIFICATIONS**  
 VC750FB/1000 & ESV-1000 SERIES CRANES

DATE  
 02-22-17G  
 SUPERSEDES  
 01-30-17F

SECTION  
 C300  
**CEV162**



# SECTION 400

# PARTS

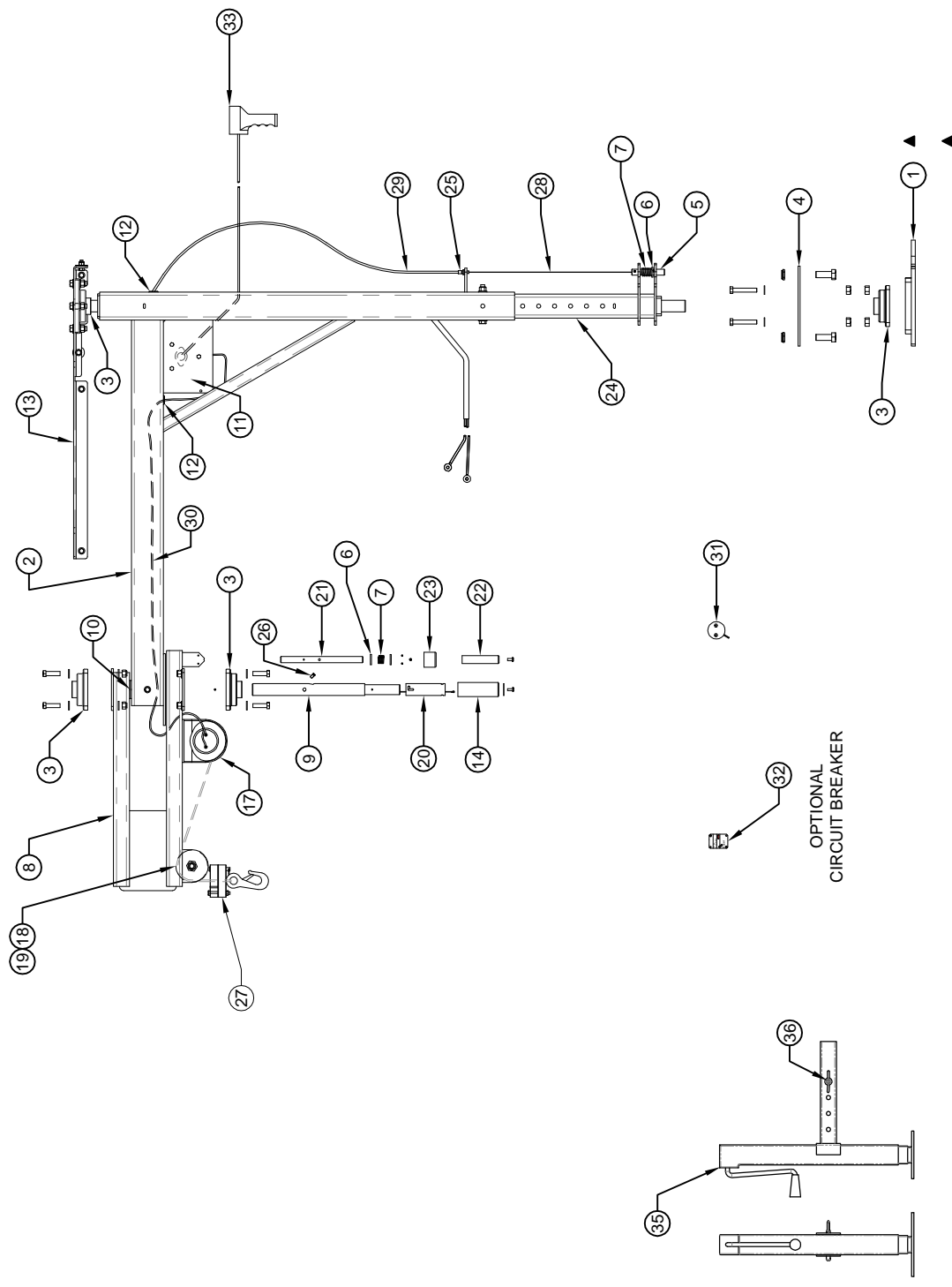

\* SEE REPLACEMENT PARTS LIST CEV205

 VENCO VENTURO INDUSTRIES LLC CINCINNATI, OHIO	TITLE	REPLACEMENT PARTS DRAWING	DATE	SECTION
		VC1000; FORD TRANSIT MID/HIGH ROOF	01-06-17C SUPERSEDES 08-29-16B	C400
				CEV204

REPLACEMENT PARTS LIST

VC1000 (VGDAAA); FORD TRANSIT MID/HIGH ROOF ▲

ITEM	PART NUMBER	QTY	DESCRIPTION
▲ 1	CEV236	1	MOUNTING BASE WELDMENT
2	23321	1	PRIMARY/MAST BOOM UPPER WELDMENT
3	23335	4	1.50 BORE, 4 BOLT FLANGE BEARING
4	23333	1	ROTATION STOP DETENT PLATE
5	23343	1	ROTATION STOP PIN
6	12534-1	3	MACHINERY BUSHING, 3/4 "
7	22667	2	SPRING
8	23322	1	SECONDARY BOOM WELDMENT
9	23342	1	SECONDARY PIVOT TUBE
10	23351	2	THRUST WASHER
11	CE-008	1	WINCH CONTACTOR BOX
12	20889	2	GROMMET
13	23338	1	UPPER MOUNT BRACKET
14	23337	1	RED VINYL GRIP, 1.50"
▲ 15	-	-	-
▲ 16	-	-	-
17	CE-009	1	WINCH WITH CABLE & TENSIONER KIT, X1
18	19646	1	SHEAVE WITH BUSHING
19	13168-7	1	SHEAVE SLEEVE
20	23336	1	ROTATION LOCK RELEASE HANDLE WELDMENT
21	23363	1	SECONDAR ROTATION STOP PIN
22	16-00064	1	RED VINYL HANDLE GRIP, .75"
23	22676	1	VINYL CAP, BLACK
24	23355	1	MAST LOWER WELDMENT
25	23366	1	PRIMARY ROTATION STOP RELEASE CABLE ADJUSTER
26	13463-2	1	SET SCREW COLLAR, CABLE HOUSING RETAINER
27	16735	1	HEADACHE BALL ASSEMBLY
28	23364	1	PRIMARY ROTATION LOCK RELEASE CABLE
29	23365	1	PRIMARY ROTATION LOCK RELEASE CABLE CONDUIT
30	02025-6*96.5INX	2	WINCH TO CONTACTOR BOX CABLE
31	13451	1	MASTER DISCONNECT SWITCH
32	22964-150	1	CIRCUIT BREAKER, 150 AMP, MANUAL RESET/TRIP
33	CE-006	1	PENDANT
34	CEV217	1	FIELD SERVICE LABEL KIT
35	CEV210	1	JACK LEG WELDED ASSEMBLY
36	18502	1	HITCH PIN ASSY W/LANYARD
37			
38			
39			
40			

\* SEE REPLACEMENT PARTS DWG CEV204



VENCO VENTURO INDUSTRIES LLC  
CINCINNATI, OHIO

TITLE	DATE	SECTION
REPLCMNT PART LIST	01-06-17C	C400
VC1000; TRNST M/H RF	SUPERSEDES 08-29-16B	<b>CEV205</b>

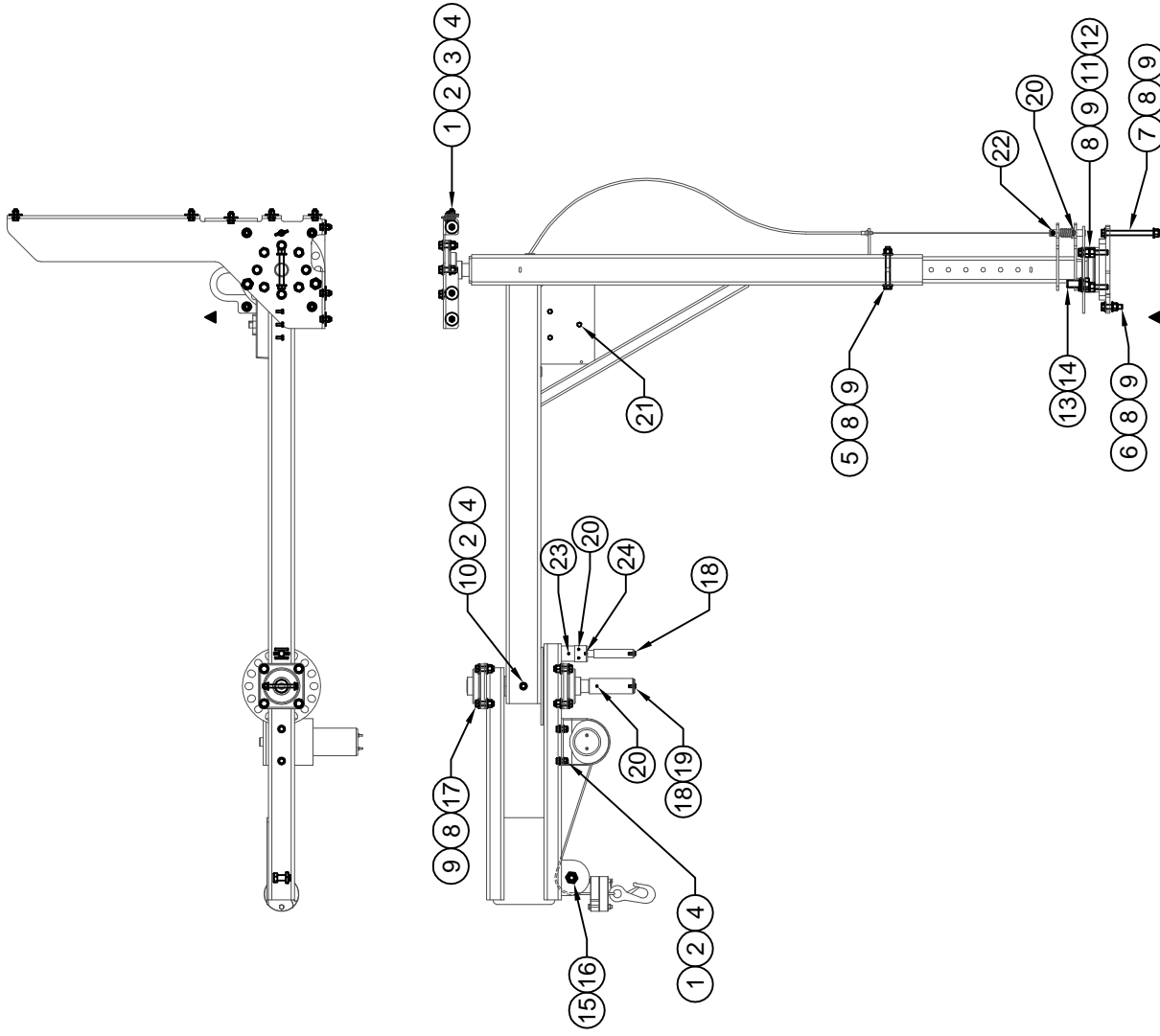

VENCO VENTURO INDUSTRIES LLC  
CINCINNATI, OHIO

TITLE  
REPLACEMENT HARDWARE DRAWING  
▲ VC1000 (VGDAAA); FORD TRANSIT M/H ROOF

DATE  
01-06-17C  
SUPERSEDES  
09-09-16B

SECTION  
C400  
CEV208



REPLACEMENT HARDWARE LIST  
VC1000 (VGDAAA); FORD TRANSIT MID/HIGH ROOF ▲

ITEM	QTY	PART NO.	DESCRIPTION
1	10	!HHCS03816100	HEX HEAD CAP SCREW; 3/8-16 X 1" LG, GR. 5
2	14	!FWSH-038SAE	FLAT WASHER; 3/8", SAE
3	8	!FWSH-038F	FENDER WASHER; 3/8"
4	11	!LNUT-03816	LOCK NUT; 3/8-16, NYLOC
5	1	!HHCS02520450S	HEX HEAD CAP SCREW; 1/4-20 X 4-1/2" LG, GR. 5, STAINLESS STEEL (S/S)
6	2	!HHCS05013200	HEX HEAD CAP SCREW; 1/2-13 X 2" LG., GR. 5
7	2	!HHCS05013650	HEX HEAD CAP SCREW; 1/2-13 X 6-1/2" LG., GR. 5
▲ 8	38	!FWSH-050	FLAT WASHER; 1/2"
▲ 9	17	!LNUT05013	LOCK NUT; 1/2-13, NYLOC
10	1	!HHCS03816375	HEX HEAD CAP SCREW; 3/8-16 X 3-3/4" LG., GR. 5
11	4	!HHCS05013300-8	HEX HEAD CAP SCREW; 1/2-13 X 3" LG., GR. 8
12	8	!HNUT-06311	HEX NUT; 5/8-11 (USED AS SPACERS)
13	2	!HHCS07510200	HEX HEAD CAP SCREW; 3/4-10 X 2" LG., GR. 5
14	2	!JNUT-07510N	JAM NUT; 3/4-10, NYLOC
15	1	!HHCS06311150-8	HEX HEAD CAP SCREW; 5/8-11 X 1-1/2" LG., GR. 8
16	1	!JNUT-06311N	JAM NUT; 5/8-11, NYLOC
17	14	!HHCS05013175	HEX HEAD CAP SCREW; 1/2-13 X 1-3/4" LG., GR. 5
18	2	!SHPMS02520063S	PAN HEAD CAP SCREW; 1/4-20 X 5/8" LG., GR. 5, S/S
19	1	23350	FENDER WASHER; 1/4", 1-1/2" O.D.
20	4	!RPIN-019150-SS	ROLL PIN; 3/16 X 1-1/2, STAINLESS STEEL
21	3	!HHCS02520063S	HEX HEAD CAP SCREW; 1/4-20 X 5/8" LG., GR.5, S/S
22	2	23349	SET SCREW; 1/4-20
23	1	!RPIN-019125-SS	ROLL PIN; 3/16 X 1-1/4, STAINLESS STEEL
24	1	!RPIN-019175-SS	ROLL PIN; 3/16 X 1-3/4, STAINLESS STEEL
25			
26			
27			
28			
29			
30			
31			
32			
33			
34			
35			

\* SEE REPLACEMENT HARDWAR DRAWING CEV208



VENCO VENTURO INDUSTRIES LLC  
CINCINNATI, OHIO

TITLE	DATE	SECTION
REPLCMNT HDWR LIST	01-06-17C	C400
VC1000; TRNST M/H RF	SUPERSEDES 08-31-16B	CEV209

# REPLACEMENT PARTS LIST

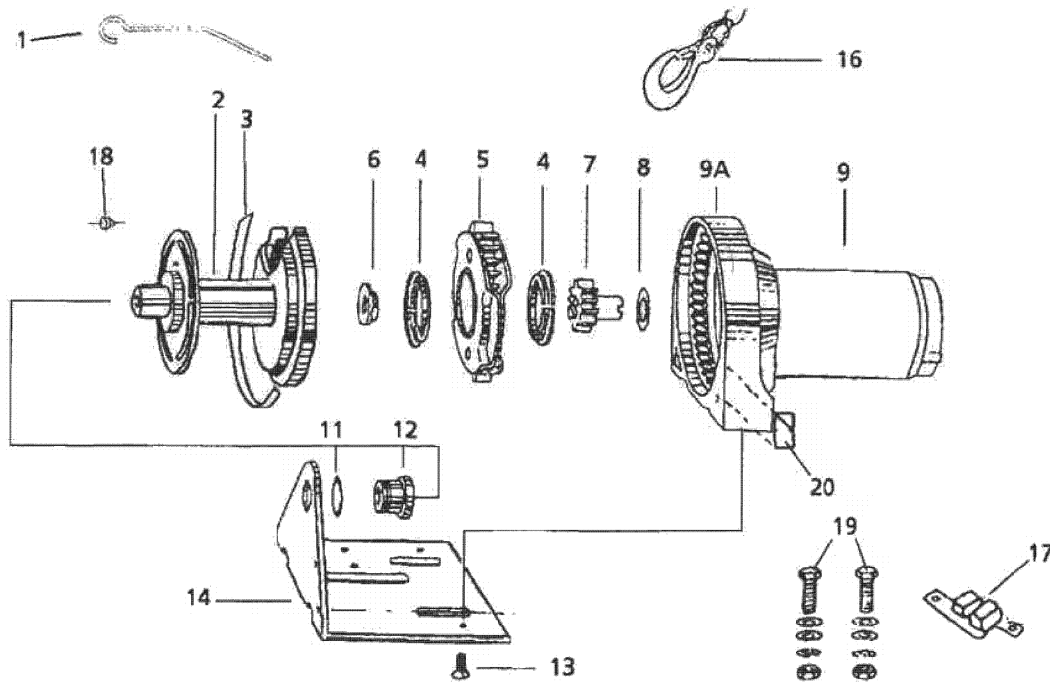

Reference Number	Description	Part Number	Qty
1	Handsaver	89-32300	1
2	Rotating Gear Drum	90-32038	1
3	Perimeter Bearing	90-23137	1
4	Carrier Bearing	90-23140	2
5	Planetary Gearing Assembly	90-23138	1
6	Nylon Step Washer	90-12418	1
7	10-Tooth Sun Gear	90-22865	1
8	Flat Thrust Washer	90-23120-08	1
9A	Stationary Ring Gear w/ Needle Bearing	90-12629	1
9	12 Volt Motor w/Ring Gear & Needle Bearing	90-32425	1
	12 Volt Motor (external mtg bolt applications only)	90-33293	1
11	Shim Washer	90-23120-05	AR
12	Bushing	90-12174	1
13	5/16" Socket Head Cap Screw	90-23056-02	2
14	Main Frame Base Plate	90-41019	1
16	3/16" x 25' Cable & Hook Assembly	1511	1
17	12V Circuit Breaker Assembly	90-22873	1
18	Rope Retainer	90-12419	1
19	Pair of 3/8" Bolts & Nuts, 4 Flat Washers & 2 Locking Washers	90-22892	1
20	Handsaver Label	90-12417	1
NS	Pulley Block	2227	1

AR denotes "As Required"



VENCO VENTURO INDUSTRIES LLC  
CINCINNATI, OHIO

TITLE

WINCH RPLCMNT PARTS

DATE

02-24-17E

SECTION

C400



CE-1500-FB/CEV/ESV SERIES

SUPERSEDES

08-18-16D

CE-055

ITEM	QTY	DESCRIPTION	PART #
1	1	COVER; CONTACTOR BOX, PENDANT SOCKET	90-31079
2	1	PENDANT SOCKET, CONTACTOR BOX COVER	90-22115
3	2	SOLENOID; CONTACTOR BOX, WINCH	90-20329

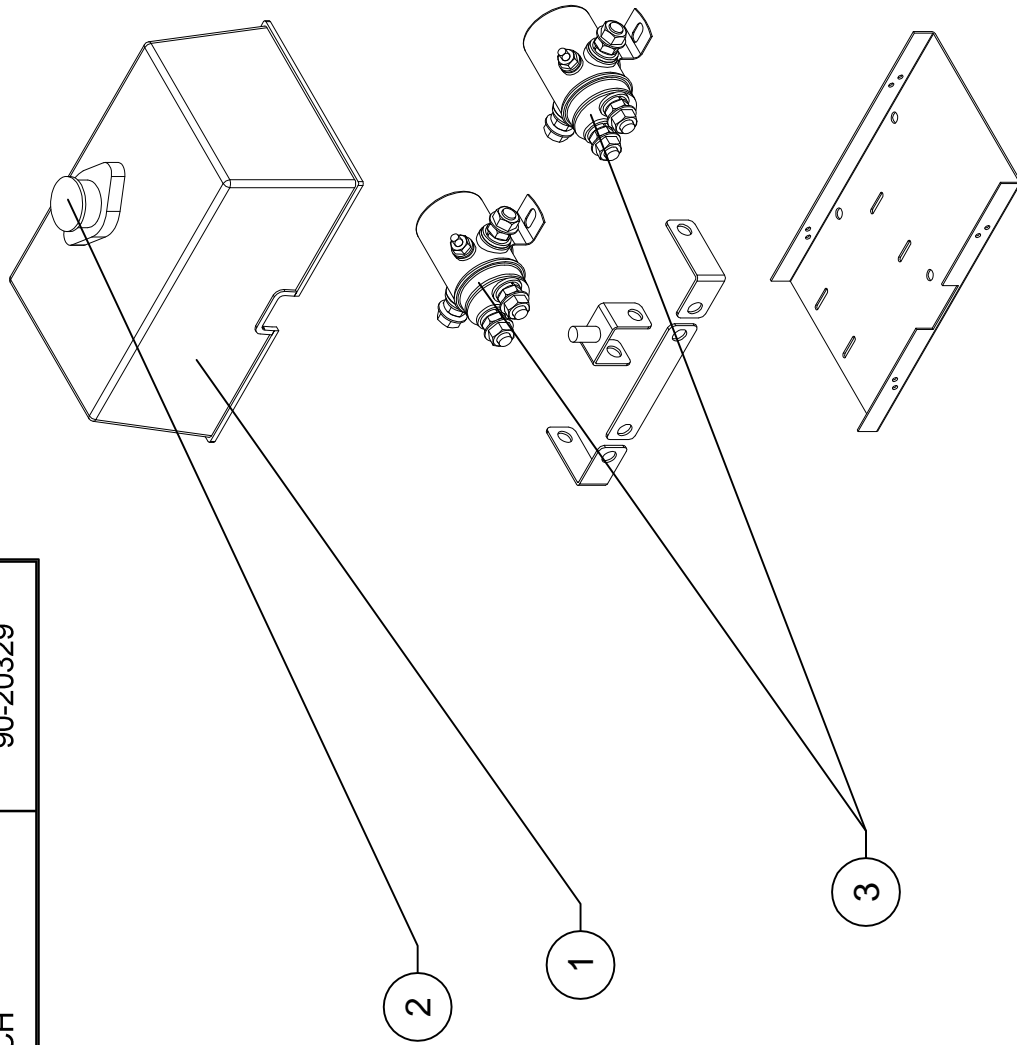

VENCO VENTURO INDUSTRIES LLC  
CINCINNATI, OHIO



TITLE  
REPLACEMENT PARTS DIAGRAM

CE-008 CONTACTOR BOX

DATE  
08-30-16

SUPERSEDES  
-

SECTION  
C400

CEV224

DECAL #: 15390  
 DESCRIPTION: CAUTION, INSPECT VEHICLE & CRANE...  
 PURPOSE: TO INFORM THE OPERATOR OF KEY OPERATING REQUIREMENTS.  
 QUANTITY: 1  
 PLACEMENT: UPPER MAST ON SIDE, OPPOSITE PRIMARY BOOM



DECAL #: 15391  
 DESCRIPTION: DANGER, NOT A PASSENGER LIFT  
 PURPOSE: TO INFORM OPERATOR NOT TO LIFT, SUPPORT, OR TRANSPORT PERSONNEL, AND TO ENSURE OPERATOR IS ADEQUATELY TRAINED.  
 QUANTITY: 1  
 PLACEMENT: UPPER MAST ON SIDE, OPPOSITE PRIMARY BOOM

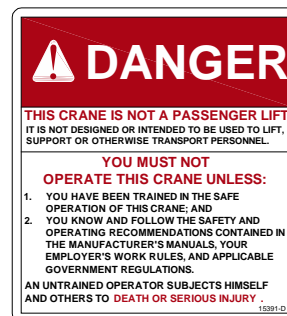

DECAL #: 15392  
 DESCRIPTION: DANGER, ELECTROCUTION HAZARD, MACHINE (CRANE)  
 PURPOSE: TO INFORM OPERATOR THAT MACHINE (CRANE) REPRESENTS AN ELECTROCUTION HAZARD SHOULD IT COME CLOSE TO OR IN CONTACT WITH AN ELECTRICAL VOLTAGE SOURCE.  
 QUANTITY: 1  
 PLACEMENT: UPPER MAST ON SIDE, OPPOSITE PRIMARY BOOM

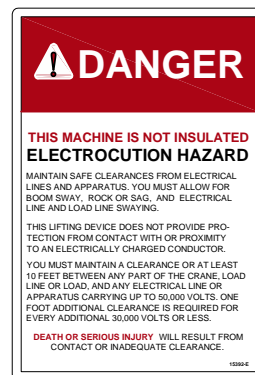

DECAL #: 15393  
 DESCRIPTION: DANGER, ELECTROCUTION HAZARD, VEHICLE (TRUCK)  
 PURPOSE: WARNS OF DANGER FROM ELECTRICALLY CHARGED VEHICLE, CRANE, OR LOAD.  
 QUANTITY: 4  
 PLACEMENT: EACH SIDE & EACH END OF VEHICLE

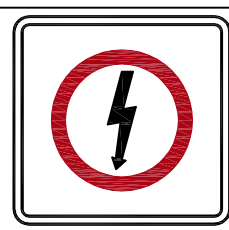
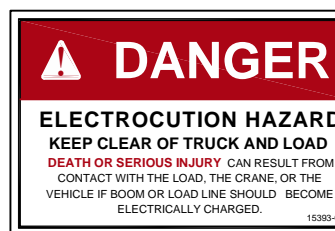

VENCO VENTURO INDUSTRIES LLC  
 CINCINNATI, OHIO

TITLE  
**SAFETY DECALS**

VENTURO VAN CRANES

DATE  
 09-29-16A

SUPERSEDES  
 08-02-16

SECTION  
**C400**

**CEV170**

DECAL #: 15513  
 DESCRIPTION: MASTER DISCONNECT SWITCH  
 PURPOSE: TO INFORM THE OPERATOR OF LOCATION AND OPERATION OF MASTER DISCONNECT SWITCH  
 QUANTITY: 1  
 PLACEMENT: ON MASTER DISCONNECT SWITCH BRACKET



DECAL #: 15398  
 DESCRIPTION: UNPLUG REMOTE CONTROL  
 PURPOSE: TO INFORM OPERATOR TO UNPLUG REMOTE CONTROL WHEN NOT IN USE  
 QUANTITY: 1  
 PLACEMENT: NEAR PENDANT SOCKET



DECAL #: 573403  
 DESCRIPTION: WARNING - STOWING  
 PURPOSE: TO INFORM OPERATOR TO STAY AWAY FROM THE BOOM WHEN STOWING  
 QUANTITY: 1  
 PLACEMENT: UPPER MAST ON SIDE, OPPOSITE PRIMARY BOOM



VENCO VENTURO INDUSTRIES LLC  
 CINCINNATI, OHIO

TITLE	SAFETY DECALS
	VENTURO VAN CRANES

DATE	09-29-16A
SUPERSEDES	08-02-16

SECTION	C400 ▲
	CEV171

DECAL DRAWING & LIST  
VC1000 (VGDAAA); FORD TRANSIT MID/HIGH ROOF

PART NO.: 15672-1000  
 DECAL: CAPACITY 1000 LBS  
 FUNCTION: TO INFORM OPERATOR OF MAXIMUM LIFTING CAPACITY  
 QUANTITY: 2  
 PLACEMENT: SECONDARY BOOM PLATE, BOTH SIDES



PART NO.: CEV215  
 DECAL: MODEL NAME  
 FUNCTION: TO SHOW THE MODEL OF THE CRANE  
 QUANTITY: 2  
 PLACEMENT: ONE ON EACH SIDE OF BOOM



PART NO.: 17389  
 DECAL: VENTURO  
 FUNCTION: MANUFACTURER'S LOGO  
 QUANTITY: 2  
 PLACEMENT: PRIMARY BOOM, BOTH SIDES NEAR MAST



DECAL #: 24964  
 DESCRIPTION: DANGER, STABILIZERS WILL CAUSE SERIOUS CRUSHING INJURY  
 PURPOSE: TO INFORM OPERATOR TO STAND CLEAR OF STABILIZER JACK LEG  
 QUANTITY: 1  
 PLACEMENT: JACK LEG, NEAR TOP ON SAME SIDE AS HAND CRANK



TITLE	DATE	SECTION
DECAL DRAWING & LIST	01-23-17D	C400 ▲
VC1000; TRNST M/H ROOF	SUPERSEDES 01-06-17C	CEV207

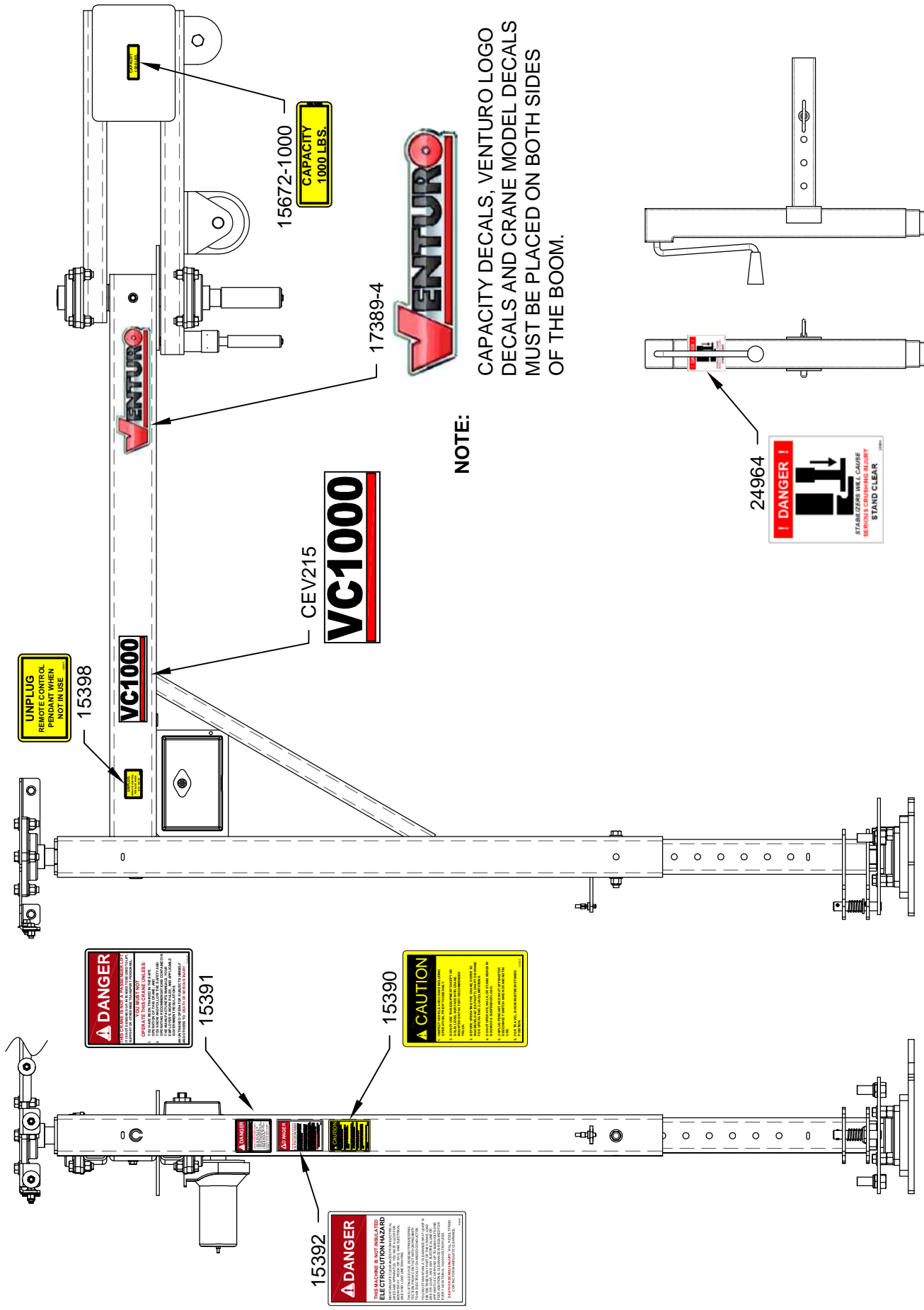

 <p>VENCO VENTURO INDUSTRIES LLC CINCINNATI, OHIO</p>	TITLE	DATE	SECTION
	DECAL LOCATIONS	01-27-17C	C400
	VC1000 SERIES VAN CRANES	SUPERSEDES 01-06-17B	CEV206

CEV216 FIELD SERVICE LABEL KIT  
 VC1000 VAN CRANES ▲



VC1000	CEV216 FIELD SERVICE LABEL KIT (VC1000 SERIES)		VC1000 SERIAL NUMBER RANGE: 33000 - CURRENT
QTY.	PART NO.	DESCRIPTION	
1	15390	DECAL; CAUTION, INSTRUCTIONS	
1	15391	DECAL; CRANE NOT PASSENGER LIFT	
1	15392	DECAL; DANGER, ELECTROCUTION HAZARD	
1	15397	BOM; ACCIDENT PREVENTION SIGNS	
1	15398	DECAL; UNPLUG PENDANT	
2	15672-1000	DECAL; CAPACITY 1000LBS	
2	17389-4	DECAL; VENTURO (SMALL)	
1	24964	DECAL; DANGER, STABILIZERS, JACK LEG	
1	CEV206	IDWG: DECAL PLACEMENT, VC1000	
2	CEV215	DECAL; MODEL, VC1000	
1	CEV217	IDWG: FIELD SERVICE LABEL KIT	
1	INST-23233	*CURRENT* SAFETY MANUAL	



VENCO VENTURO INDUSTRIES LLC  
 CINCINNATI, OHIO

TITLE  
 FIELD SERVICE LABEL KIT

DATE  
 01-24-17D

SECTION  
 C400

VC1000 VAN CRANES

SUPERSEDES  
 01-06-17C

CEV217







# VENTURO CRANES LIMITED WARRANTY POLICY

Venturo products are built to last...we guarantee them.

As a purchaser of any new Venturo product covered by warranty, you will receive 1 year of the most complete coverage available...and, at no added cost to you.

## 1-Year Limited Warranty Policy

This limited policy warrants new products of Venturo to be free from defects in material and workmanship for a period of one (1) year from date of original installation. OEM products or accessories purchased by Venturo as part of or offered with our product will carry the OEM manufacturer's respective warranty. Our warranty covers:

- ***Repair or replacement of product***
- ***Labor to repair or replace product***
- ***Freight to return and/or replace product***

We shall not be liable for any contingent liabilities arising out of the improper function of any products. Warranty shall become void if the product is improperly installed, modified, damaged, abused or used for application other than intended use. There is no warranty of merchantability, fitness for a particular purpose, warranty arising from course of dealing or usage of trade, or any other implied or expressed warranty, except as made specifically herein. This warranty supersedes all previous warranties, written or implied.

## Warranty Claims

Venco Venturo Industries LLC will make a good faith effort for prompt correction or other adjustment with respect to any product, which proves to be defective after our inspection and within the warranty period. Before any repairs are attempted or before returning any product, your Venturo Distributor is required to obtain a warranty claim number. This number is necessary for any claim to be considered. To obtain a warranty claim number, Venturo requires the model and serial number. Only authorized Venturo Distributors can perform warranty. For the name and address of your local Venturo Distributor call the **Warranty Claim Department - 513-772-8448**.

**WARNING** - It is the responsibility of the installer to ensure the installation is completed according to the manufacturer's recommendations, ensure the ultimate user understands how to operate product in a safe manner, and understands the need for regular service and maintenance by an authorized Venturo Distributor. No modifications or alterations may be made to any Venturo product without the expressed written consent of Venco Venturo Industries LLC. Installation of any Venturo product must be done by an authorized Venturo Distributor, to the standards of the industry; including maintenance, service and affixing of all instruction, safety and warning decals. Users should be instructed as to the safe operation at time of delivery. Maintenance, service, operation and safety warning decals are available on request from Venco Venturo Industries LLC.

**VENCO VENTURO INDUSTRIES LLC**  
12110 BEST PLACE | CINCINNATI, OHIO 45241  
P: 800-226-2238 | F: 513-326-5427  
[www.venturo.com](http://www.venturo.com)